

**NOTES - IF IN DOUBT, ASK**

1. Do not scale directly from this drawing.
2. All dimensions are in metres.
3. All levels are shown in metres Above Ordnance Datum (AOD).
4. All levels and dimensions are to be checked on site by the site manager/contractor prior to commencing any works or ordering any materials.
5. This drawing is to be viewed in conjunction with all other detailed drawings and specifications from all members of the design team.
6. Any conflicts/discrepancies are to be highlighted to Southern Green prior to commencing works or ordering any materials.

**CDM - SAFETY, HEALTH & ENVIRONMENTAL INFORMATION**  
**Principal Designer: Simon Hitchens Ltd**  
 In addition to the hazards/ risks normally associated with the types of work detailed on this drawing, note the following project specific risks which require attention/ mitigation by the contractor undertaking the works:

**Construction:** none identified at this time  
**Maintenance/ Cleaning:** none identified at this time  
**Decommissioning/ Demolition:** none identified at this time

It is assumed that all works will be carried out by a competent contractor, working where appropriate, to their own approved method statement. This is not an exhaustive list and reference must be made to the Construction Phase Plan or Health and Safety File and any additional Risk Assessment documents available.

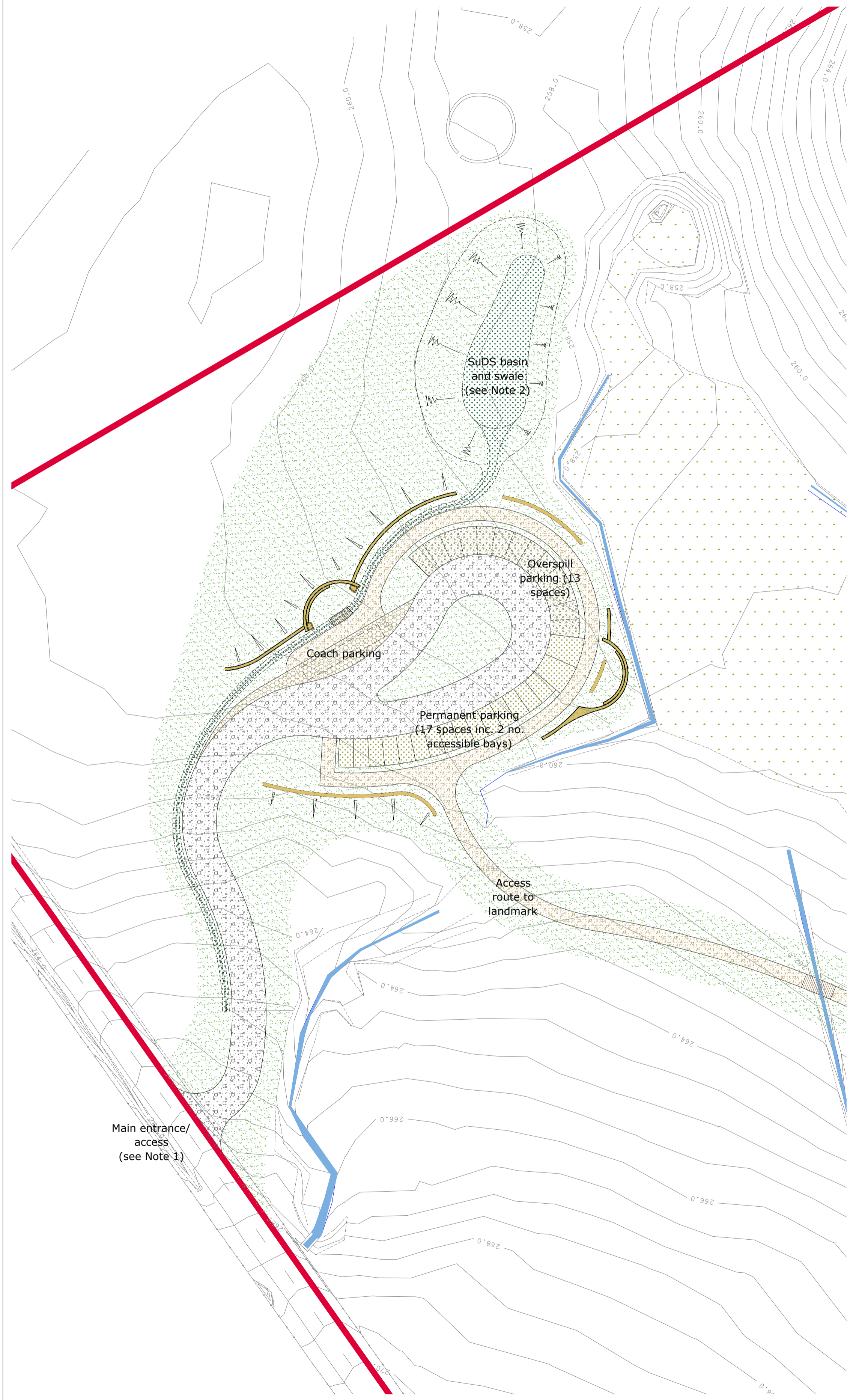

**LEGEND - 1:500**

- Site Boundary**  
9.5ha
- Landmark and Rockslot**
- Viewing Area**
- Main Access Road**  
Hoggin - crushed whinstone, or similar
- Permanent Parking**  
Site-won aggregate with grass seed  
Different types to overspill parking
- Overspill Parking**  
Site-won aggregate with grass seed  
Different types to permanent parking
- Coach Parking**  
Hoggin - carboniferous limestone, or similar, with stone edge demarcation
- Approach and Circular Path**  
Self-binding gravel aggregate sourced from site if practical
- Boardwalk/ Crossing Point**
- Dry Stone Shelter Wall**  
With integrated seating, litter bins, cycle storage and interpretation
- Wall Earth Banks**
- Existing Ditches**
- Existing Marsh Area**
- SuDS Basin**
- Swale**
- Remedial Measures to Existing Grass Areas**  
Following completion of construction works

**Notes**

1. Refer to the following drawings for further detail on the access from the main road:-
  - SAJ - Site access arrangement (JN1784-Dwg-0009)
  - SAJ - Visibility splay (JN1784-Dwg-0004)
  - Shadbolt - Construction details (2542C/510 Rev A)
2. Refer to the following drawing for further detail on the drainage strategy:-
  - Shadbolt - Indicative Surface Water Drainage Plan (2542C/ 514 Rev A)

Rev	Description	By	Chk	Date

**1131\_ELIZABETH LANDMARK**

Viscount Devonport  
 Landscape Strategy - Car Park Area

1131\_101      Rev -  
 1:500 @ A2      16.01.19      NE48

Scale Bar - 1:500 @ A2

**Drawing Issue Status**

<input type="checkbox"/> Comment/ Approval	<input type="checkbox"/> Contract
<input type="checkbox"/> Costing	<input type="checkbox"/> Construction
<input checked="" type="checkbox"/> Planning	<input type="checkbox"/> Record Dwg
<input type="checkbox"/> Tender	<input type="checkbox"/> BIM

© Copyright and all intellectual property rights remain vested in Southern Green Ltd

**SouthernGreen**

0191 440 0034  
 www.southerngreen.co.uk  
 studio@southerngreen.co.uk