







Scale: 1:1250

Legend

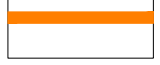
-  Current unaffected bridleway
-  Current unaffected footpath
-  Current unaffected recordable path (not shown on definitive map)
-  Current unaffected National Cycle Network route
-  Existing way to be temporarily stopped up
-  Existing way to be permanently stopped up
-  Permanent diversion of existing way

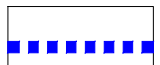
00 Reference Point

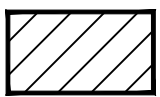
 Vehicular highways to be stopped up

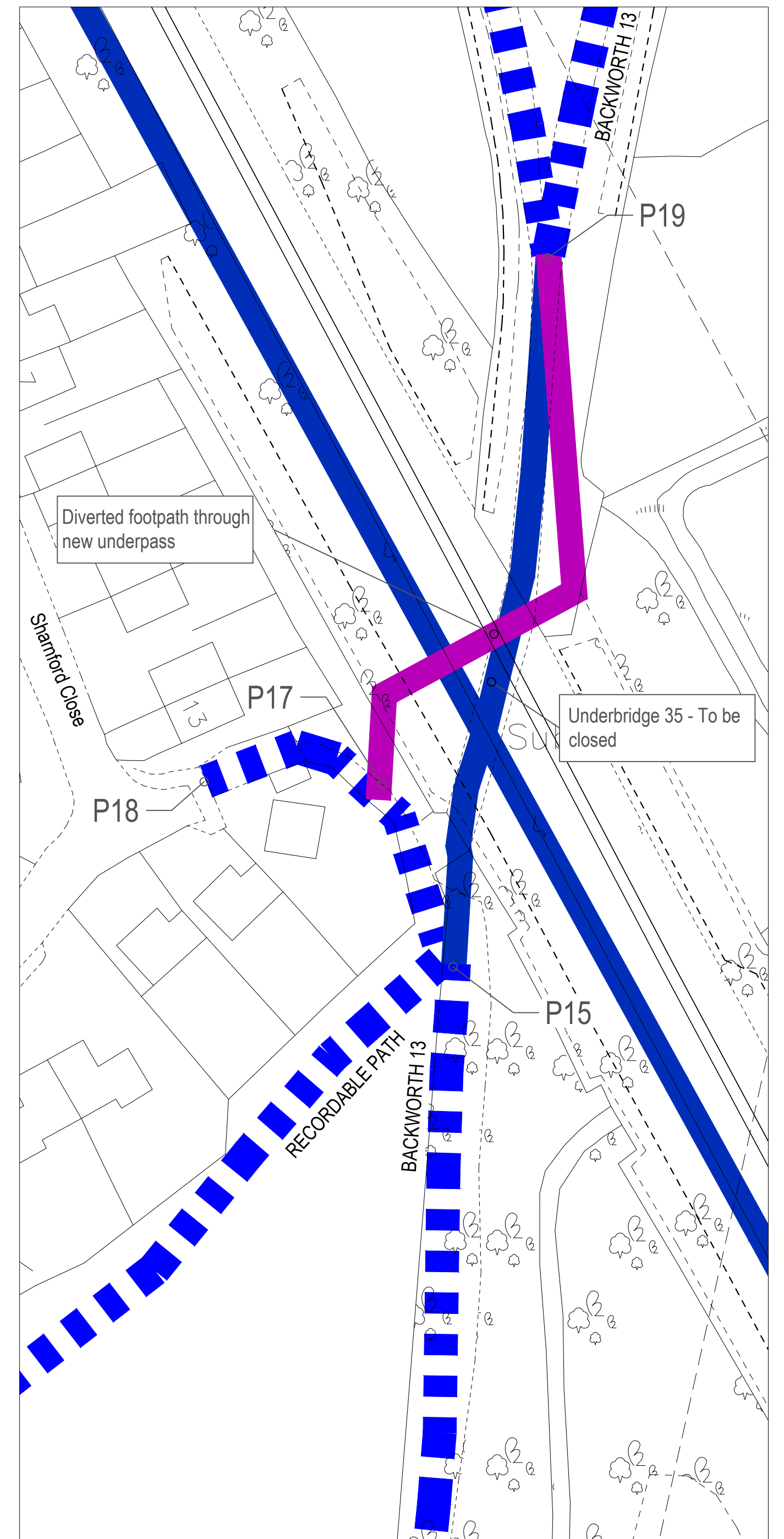

Scale: 1:500

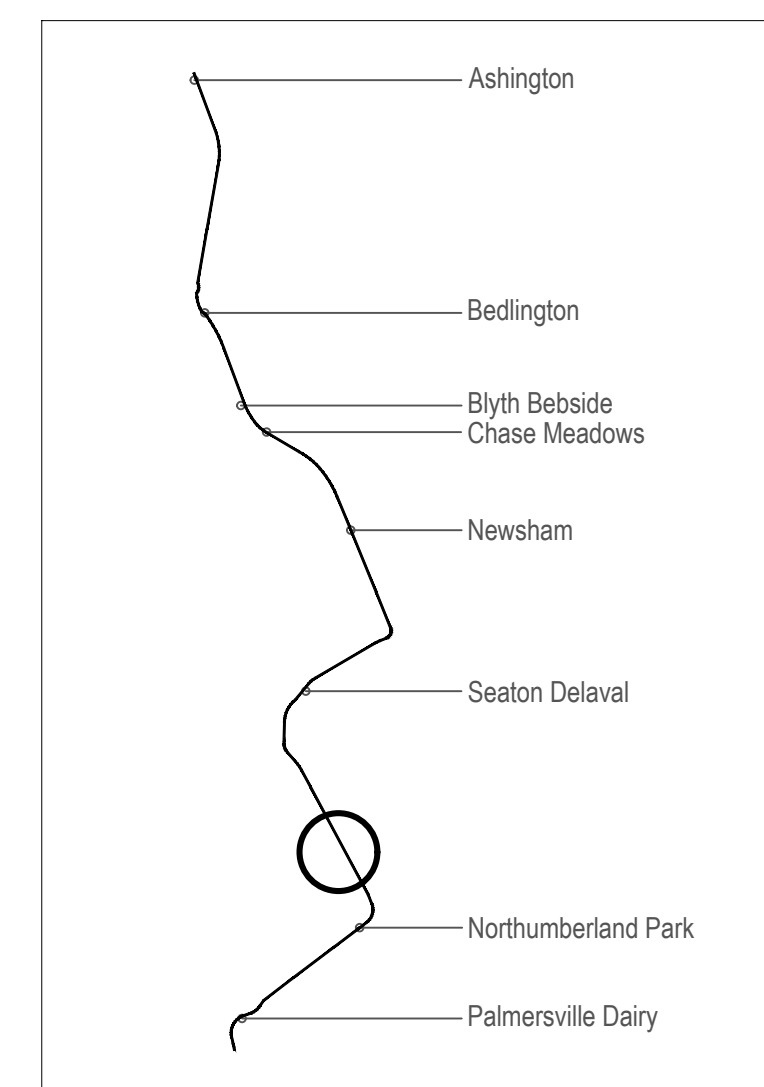

Location on Northumberland Line

Project Title
The Northumberland Line Order 202[X]

Drawing Title
Rights of Way Plans

Sheet 2

Rev
R03

Scale @ 594 x 841 A1
1:1250 & 1:500