







Legend

-  Current unaffected brideway
-  Current unaffected footpath
-  Current unaffected recordable path (not shown on definitive map)
-  Current unaffected National Cycle Network route
-  Existing way to be temporarily stopped up.
-  Existing way to be permanently stopped up
-  Permanent diversion of existing way

 00 Reference Point

 Vehicular highways to be stopped up

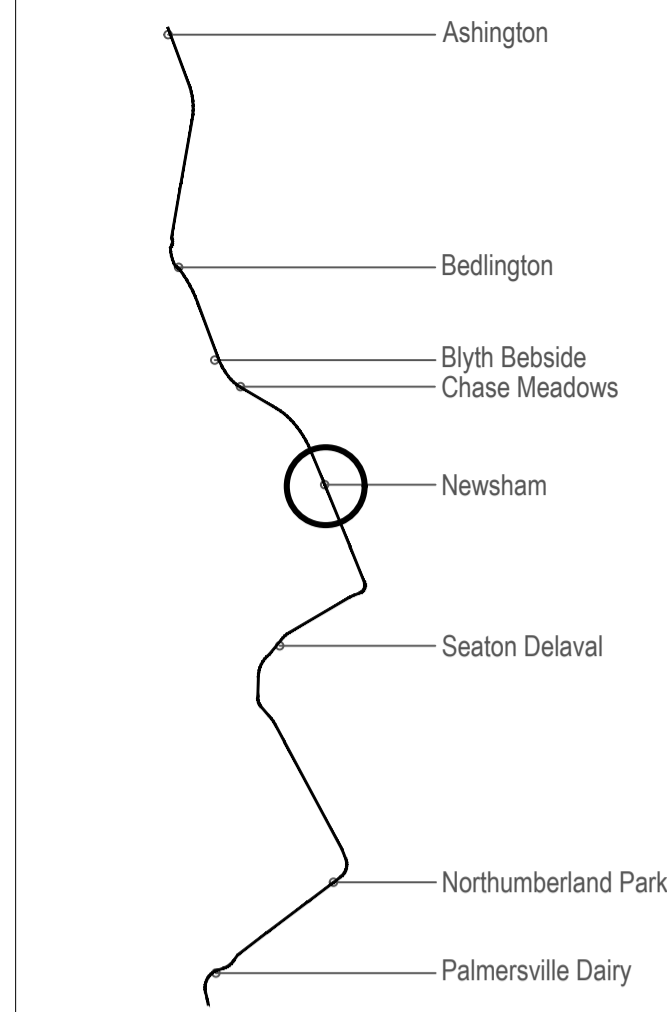

Location on Northumberland Line

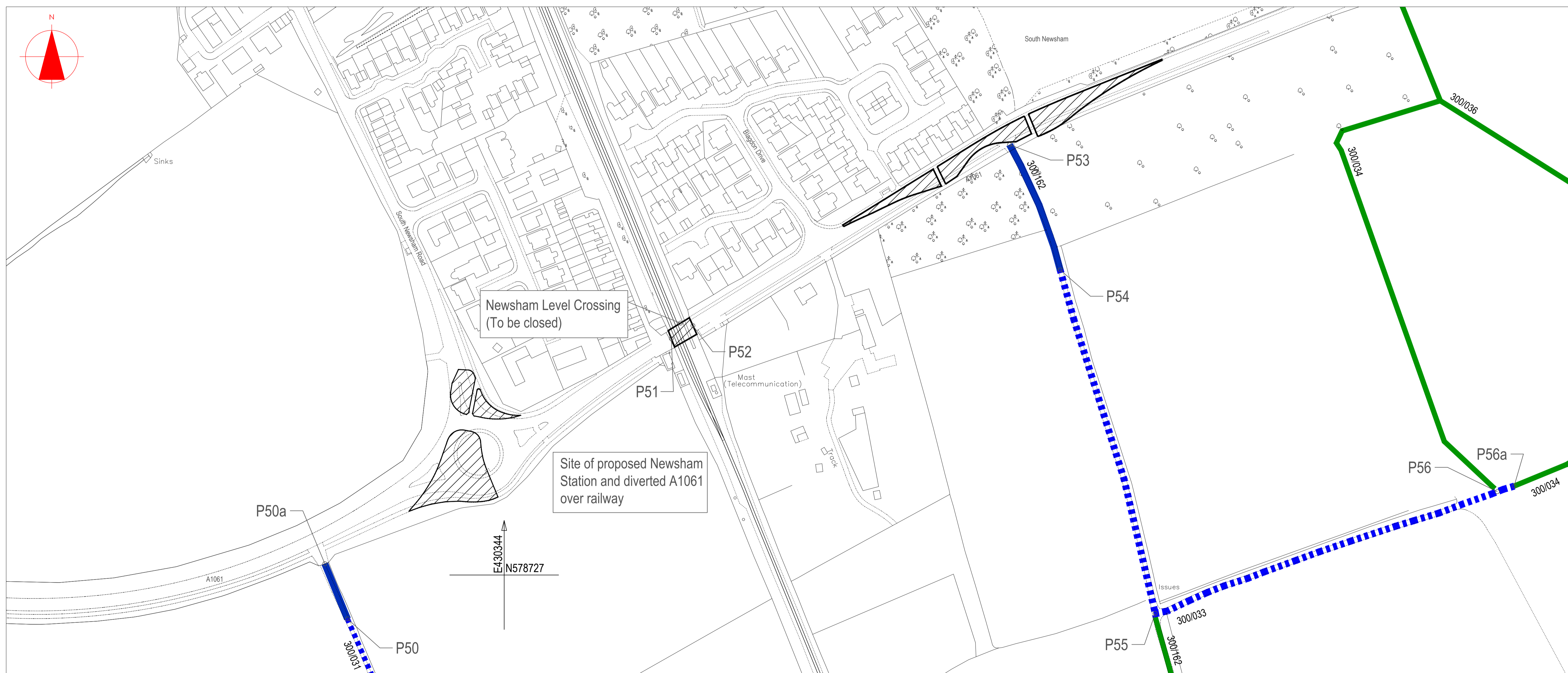

Continued on Sheet 10

Project Title	
The Northumberland Line Order 202[X]	
Drawing Title	
Rights of Way Plans	
Sheet 11	Rev R03 Scale @ 594 x 841 A1 1:1250