

Transport and Works Act 1992 The Northumberland Line Order Metropolitan Borough of North Tyneside

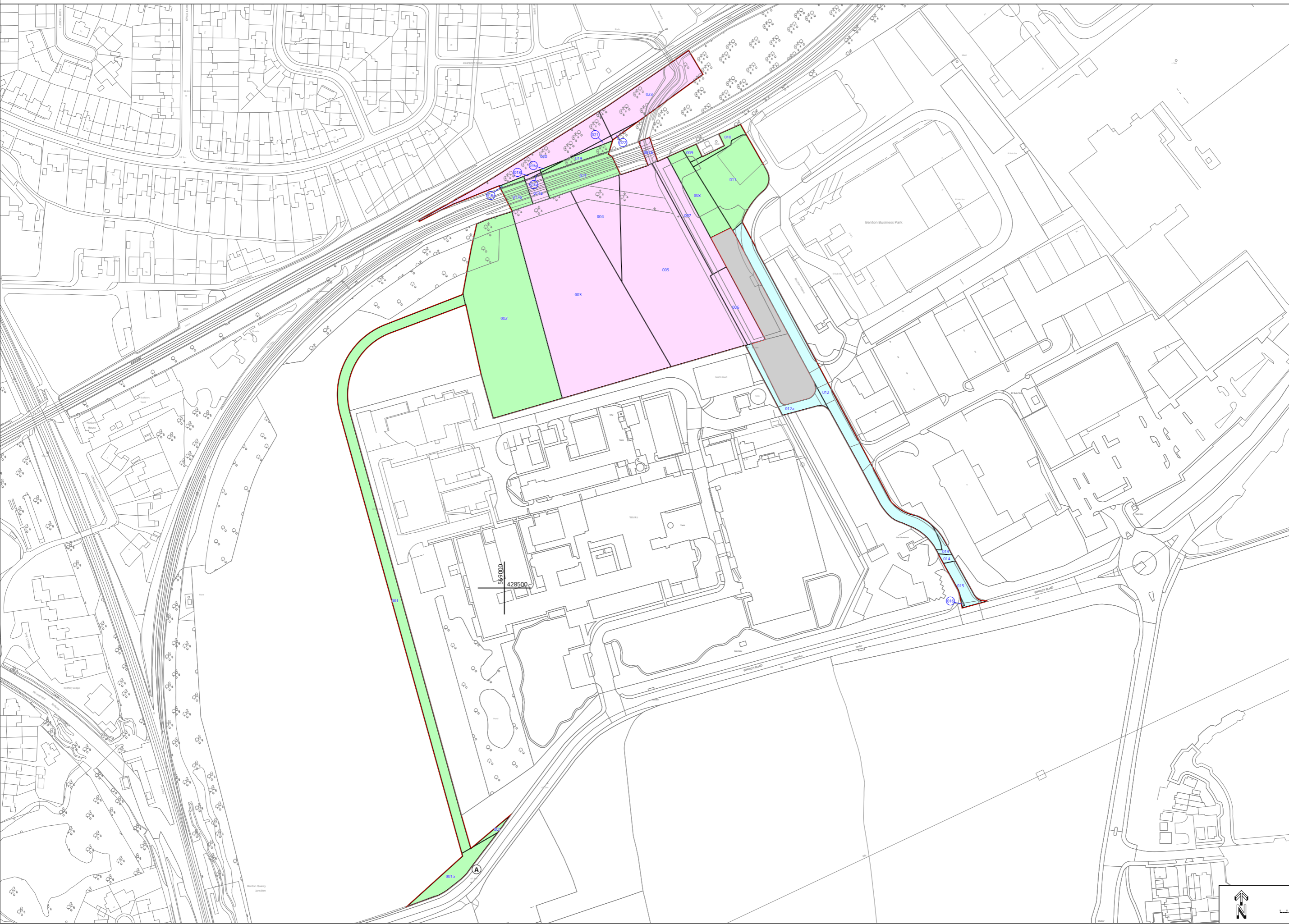

Key:

- ORDER LIMITS
- LAND TO BE ACQUIRED PERMANENTLY
- Number on Plan:
001, 004, 005, 006, 007, 007a, 017a, 018, 018a, 020, 021, 022, 023
- LAND SUBJECT TO POWER OF TEMPORARY POSSESSION
- Number on Plan:
001, 001a, 002, 008, 010, 011, 017, 017b, 018b, 019, 019a
- LAND WHERE PERMANENT RIGHTS ONLY ARE TO BE ACQUIRED
- Number on Plan:
012, 012a, 013, 014, 015, 016
- LAND OUTSIDE ORDER LIMITS

(A) NEW OR ALTERED MEANS OF ACCESS

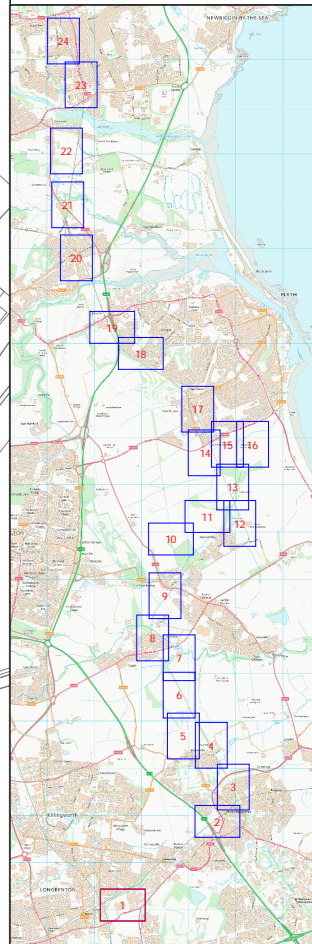

Version No.
V2.3 - DRAFT

Where applicable the plot boundaries show the general boundary of the registered land; it does not show the exact line of the boundaries. Measurements scaled from the plan may not match measurements between the same points on the ground.

This map is based upon Ordnance Survey material with the permission of Ordnance Survey on behalf of the Controller of Her Majesty's Stationery Office. Unauthorised reproduction infringes crown copyright and may lead to prosecution or civil proceedings. Crown copyright and database rights 2021 Ordnance Survey. Licence number: 0100030372.