

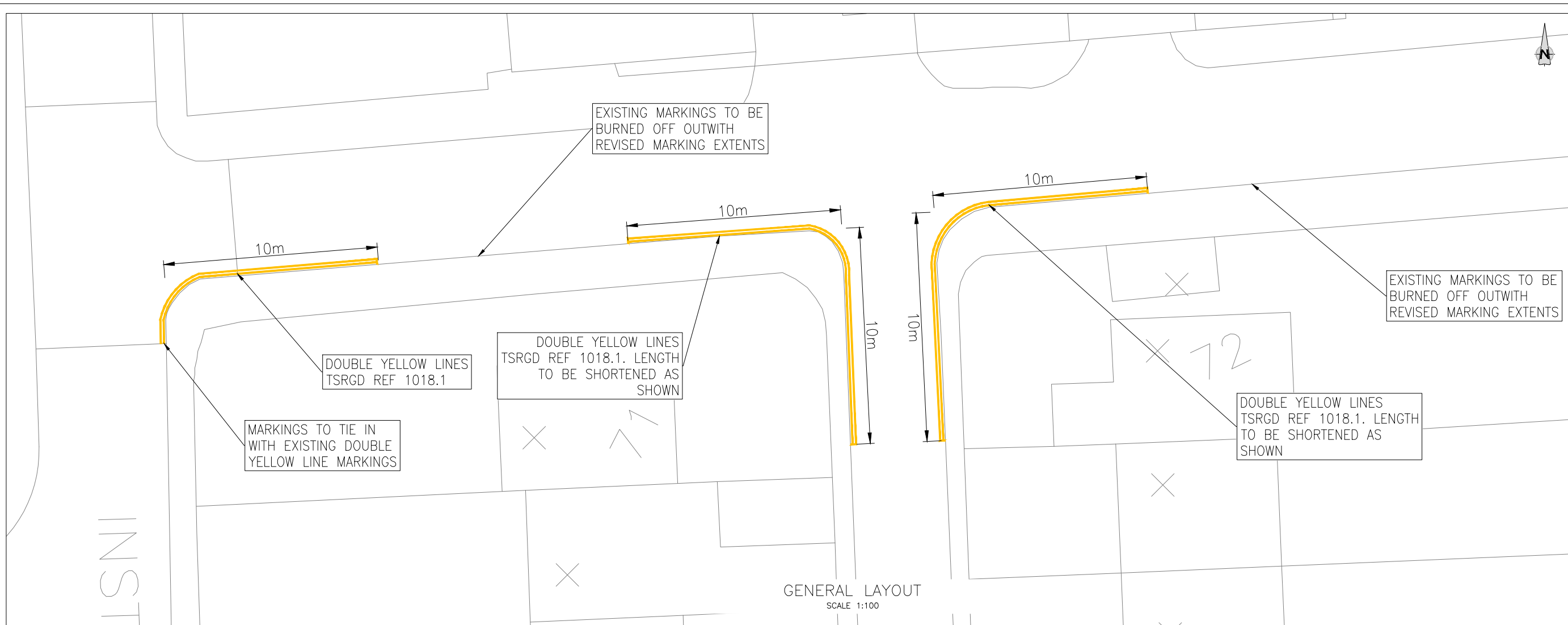

Northumberland County Council

All rights reserved. No part of this document may be reproduced in any material form (including photocopying or storing in any medium) without the written permission of Northumberland County Council except in accordance with the provisions of Copyright, Designs and Patents Act 1988. Unauthorised reproduction may lead to prosecution or civil proceedings.

- NOTES:**
- 1.0 GENERAL
 - 1.1 ALL DIMENSIONS IN [mm] UNLESS STATED OTHERWISE.
 - 1.2 ALL LEVELS IN [m] IN REFERENCE TO GPS CO-ORDINATE SYSTEM.
 - 1.3 DRAWING PRODUCED FOR TRO PURPOSES ONLY



Revision	By	Chk	App	Date	Rev
TRO	MJ	MJ	GM	JWD	-

Reproduced from based upon the Ordnance Survey mapping with permission of the Controller of Her Majesty's Stationary Office. © Crown copyright. Unauthorised reproduction infringes Crown copyright and may lead to prosecution or civil proceedings. NORTHUMBERLAND COUNTY COUNCIL - O.S. License No. 100049048 (2009)

Drawing Status: TRO

Client: NORTHUMBERLAND COUNTY COUNCIL
COUNTY HALL, MORPETH
NORTHUMBERLAND, NE61 2EF

Job Title: TRAFFIC CALMING - U6507
SEVENTH ROW/EIGHTH ROW
ASHINGTON - PHASE 1

Drawing Title: PARK VIEW TRO

Scale: AS SHOWN



Northumberland County Council Technical Services

Drawn	Date	Checked	Passed
MJ	MAY'21	MJ	GM

Drawing Number: H0196616/00/U6509/10/03
Revision: -
Oracle Number: H0196616