

**FOR REFERENCE PURPOSES ONLY  
NOT TO BE REPRODUCED**

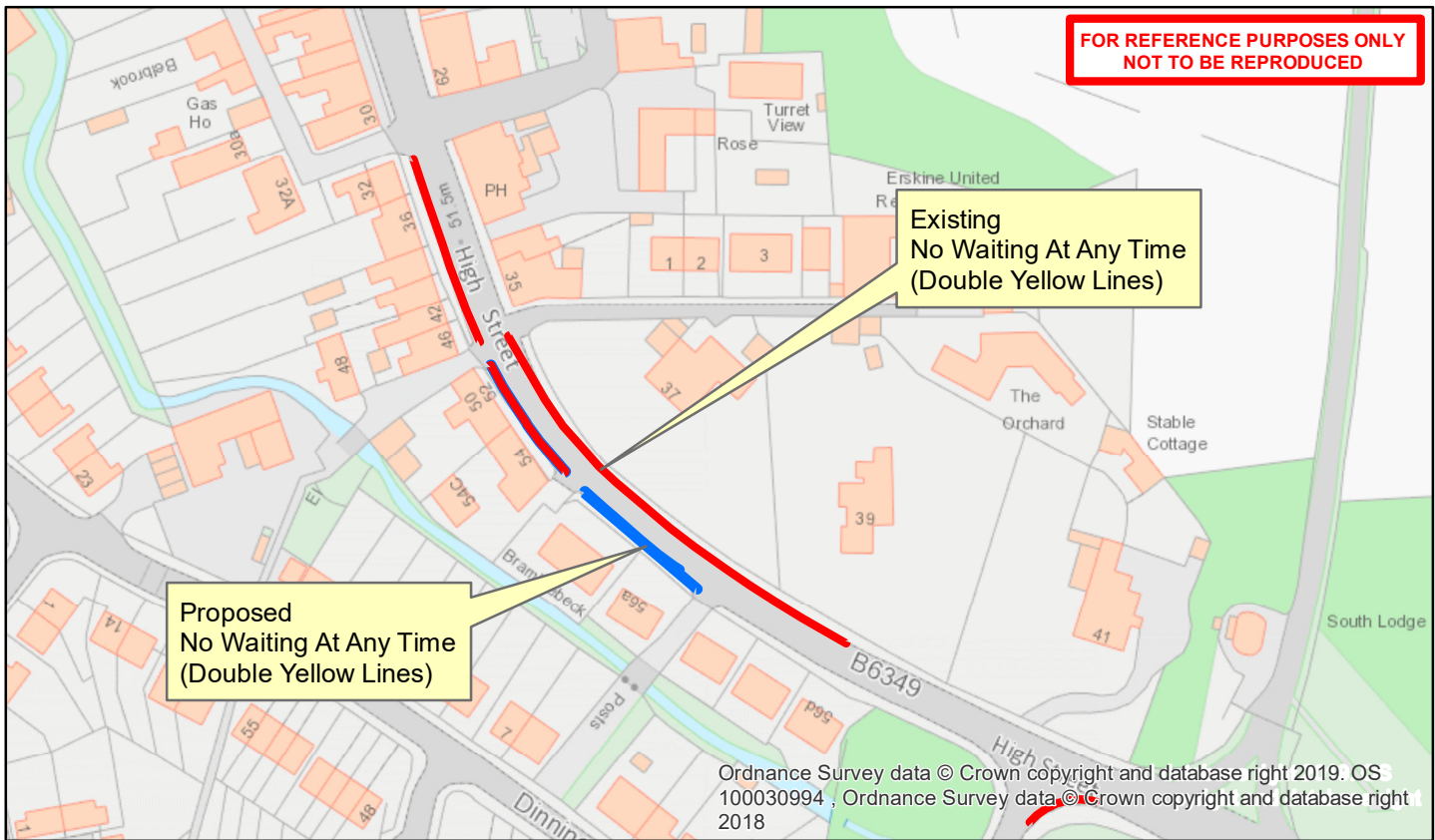

Proposed  
No Waiting At Any Time  
(Double Yellow Lines)

Existing  
No Waiting At Any Time  
(Double Yellow Lines)

Ordnance Survey data © Crown copyright and database right 2019. OS 100030994 ; Ordnance Survey data © Crown copyright and database right 2018

<p><b>NORTHUMBERLAND</b> Northumberland County Council</p>	<p><b>Network Management Information System</b></p>	<p>Title:</p>			<p><b>High Street Belford TRO_005_45</b></p>
<p>Northumberland County Council County Hall Morpeth Northumberland NE61 2EF Tel: 01670 533000</p>	<p><small>This map is reproduced from Ordnance Survey material with the permission of Ordnance Survey on behalf of the Controller of Her Majesty's Stationary Office Crown Copyright. Unauthorised reproduction infringes Crown Copyright and may lead to prosecution or civil proceedings. License no. 100049048 (2009).</small></p>	<p>Drn:</p>	<p>Date:</p>	<p>Scale:</p>	<p><b>31 Jan 2020</b></p>