

NORTHUMBERLAND COUNTY COUNCIL  
TRAFFIC REGULATION ORDER

(Ref: TRO\_009\_39)

Northumberland County Council

North Northumberland (Southern) Area (Waiting & Loading)

Composite Order 2011

Amendment No 39 Order 2021

---

Made: 17<sup>th</sup> May 2021

Coming into Force: 1<sup>st</sup> June 2021

---

Northumberland County Council (hereinafter referred to as "the Council") in exercise of their powers under Sections 1, 2 and 4 and Paragraphs 20 and 27 of Schedule 9 of the Road Traffic Regulation Act 1984 ("the Act of 1984"), and after consulting with the Chief Officer of Police in accordance with Part III of Schedule 9 to the Act of 1984 and of all other enabling powers hereby make the following Order:-

**1. Commencement and Citation**

This Order shall come into operation on the 1<sup>st</sup> June 2021 and may be cited as "Northumberland County Council North Northumberland (Southern) Area (Waiting and Loading) Composite Order 2011 – Amendment No 39 Order 2021".

**2. In the Order:-**

"Order" means "Northumberland County Council North Northumberland (Southern) Area (Waiting and Loading) Composite Order 2011".

"Amendment Order" means "Northumberland County Council North Northumberland (Southern) Area (Waiting and Loading) Composite Order 2011 – Amendment No 39 Order 2021".

The Interpretation Act 1978 shall apply to this Order as it applies to an Act of Parliament.

### 3. Provisions

The following provisions set out below and in The Schedule to this Amendment Order shall be additions to, deletions from, or substitutions in the restrictions in the Order:

(A) Additions

to Schedule 1 – Waiting

(Referenced in this Amendment Order as: First Schedule – ADDITIONS)

(B) Deletions

to Schedule 1 – Waiting

(Referenced in this Amendment Order as: Second Schedule – DELETIONS)

to Schedule 4 – Keep Clear

(Referenced in this Amendment Order as: Third Schedule – DELETIONS)

(C) Substitutions

None

THE COMMON SEAL OF NORTHUMBERLAND COUNTY COUNCIL was hereunto affixed this 17<sup>th</sup> day of May 2021 in the presence of:-



*M. Wilcock*

-----  
Duly Authorised Officer

Seal Number: 23035  
-----

## FIRST SCHEDULE

ADDITIONS – Northumberland County Council North Northumberland (Southern) Area  
(Waiting and Loading) Composite Order 2011 – Amendment No 39 Order 2021 –  
TRO\_009\_39

### Schedule 1 – Waiting

Ref No	Street	Town	Side	Description	Proscribed Hours
009_39_000_7984	GOOSE HILL	MORPETH	North	At its junction with Bridge End to a point 75 metres north east of its junction with Bridge End	A
009_39_000_7986	GOOSE HILL	MORPETH	South	At its junction with Bridge End to its junction with Tenter Terrace	A
009_39_000_7987	TENTER TERRACE	MORPETH	West	At its junction with Goose Hill to a point 16 metres south of its junction with Goose Hill	A

## SECOND SCHEDULE

### DELETIONS – Northumberland County Council North Northumberland (Southern) Area (Waiting and Loading) Composite Order 2011 – Amendment No 39 Order 2021 – TRO\_009\_39

#### Schedule 4 – Waiting

Ref No	Street	Town	Side	Description	Proscribed Hours
009_23_5707	GOOSE HILL	MORPETH	North	At its junction with Bridge End to a point 8 metres east of its junction with Bridge End	A
009_23_5708	GOOSE HILL	MORPETH	South	A point 80 metres south west of its junction with Tenter Terrace to its junction with Castle Bank	A
009_23_5710	GOOSE HILL	MORPETH	South	At its junction with Tenter Terrace to a point 4 metres west of its junction with Tenter Terrace	A
009-48-001	TENTER TERRACE	MORPETH	West	A point 3 metres south of its junction with Goose Hill to its junction with Goose Hill	A
009_23_5698	TENTER TERRACE	MORPETH	West	A point 4 metres south of its junction with Goose Hill to a point 23 metres south of its junction with Goose Hill	C

### THIRD SCHEDULE

#### DELETIONS – Northumberland County Council North Northumberland (Southern) Area (Waiting and Loading) Composite Order 2011 – Amendment No 39 Order 2021 – TRO\_009\_39

#### Schedule 4 – Keep Clear

Ref No	Street	Town	Side	Description	Proscribed Hours
009_23_5704	GOOSE HILL	MORPETH	North	A point 8 metres east of its junction with Bridge End to a point 46 metres east of its junction with Bridge End	C
009_23_5706	GOOSE HILL	MORPETH	North	A point 46 metres east of its junction with Bridge End to a point 84 metres east of its junction with Bridge End	C
009_04-365-001	GOOSE HILL	MORPETH	North East	A point 42 metres south west of its junction with Tenter Terrace to a point 80 metres south west of its junction with Tenter Terrace (adj Morpeth First School id: 2185)	C
009_04-365-002	GOOSE HILL	MORPETH	North East	A point 4 metres south west of its junction with Tenter Terrace to a point 42 metres south west of its junction with Tenter Terrace (adj Morpeth First School id: 2185)	C

**NORTHUMBERLAND COUNTY COUNCIL**

**ROAD TRAFFIC REGULATION ACT 1984  
NORTH NORTHUMBERLAND (SOUTHERN) AREA (WAITING AND LOADING)  
COMPOSITE ORDER 2011 AMENDMENT NO 39 ORDER 2021**

**STATEMENT OF THE COUNCIL'S REASONS FOR  
MAKING THE ORDER**

Goose Hill, Morpeth

The Order is necessary in order to improve road safety and the flow of traffic in association with the new off-street car park at the former school site at Goose Hill, Morpeth. This Order also removes the 'School Keep Clear' and Waiting restrictions that were in place to discourage obstructive and indiscriminate parking associated with pick up and drop offs at school start and end times, in turn being replaced by Waiting restrictions which apply at all times.



**Northumberland County Council**

All rights reserved. No part of this document may be reproduced in any material form (including photocopying or storing in any medium) without the written permission of Northumberland County Council except in accordance with the provisions of Copyright, Designs and Patents Act 1988. Unauthorised reproduction may lead to prosecution or civil proceedings.

**NOTES:**

- 1.0 GENERAL
- 1.1 ALL DIMENSIONS ARE SHOWN IN MILLIMETRES (mm) UNLESS STATED OTHERWISE.
- 1.2 PROPOSED STANDARD PARKING BAY DIMENSIONS TO BE 2.4m X 4.8m.
- 2.0 TRAFFIC SIGNS & POSTS
- 2.1 SIGNS TO COMPLY WITH BS EN 12899-1 2007 & NATIONAL ANNEX & BE MANUFACTURED FROM ALUMINIUM COMPOSITE PANEL WITH CLASS RA2 SIGN FACE SHEETING.
- 2.2 ALL MECHANICAL FASTENERS FOR SIGNS TO BE PROCURED FROM NHSS 3 APPROVED SOURCES.
- 2.3 SIGN POSTS SHALL NOT PROTRUDE ABOVE SIGN EDGES.
- 2.4 PROPOSED SIGNS ARE TO BE INSTALLED TO ENSURE 0.5m MINIMUM CLEARANCE BETWEEN THE EDGE OF THE CARRIAGEWAY & THE EDGE OF THE SIGN FACE.
- 2.5 THE POSTS FOR SIGNS REF'S 3 & 4 SHALL BE SIGNSTR8 ANTI-ROTATIONAL POSTS (OR SIMILAR APPROVED).
- 2.6 DETAILS OF THE QR CODE IMAGE FOR SIGN REF. 1 & 2 WILL BE PROVIDED AS PART OF THE WORKS INFORMATION PACK.
- 3.0 PROPOSED ROAD MARKINGS
- 3.1 ROAD MARKINGS (APART FROM THE BAY MARKINGS & ASSOCIATED HATCHED AREAS) ARE TO BE IN THERMOPLASTIC SCREED WITH APPLIED SOLID GLASS BEADS & BE IN ACCORDANCE WITH THE TSR&GD 2016 & THE SPECIFICATION FOR HIGHWAY WORKS.
- 3.2 PARKING BAY MARKINGS & ASSOCIATED HATCHED AREAS ARE TO BE IN HIGH FRICTION SURFACING WITH CHINESE GREY BAUXITE CHIPPINGS 1 TO 3mm AGGREGATE SIZE & BE IN ACCORDANCE WITH THE TSR&GD 2016.
- 4.0 PROPOSED BOLLARDS TYPE BL1
- 4.1 BOLLARDS TO BE BROXPAP BLACKPOOL CAST IRON REF BX1521-RT. JET BLACK IN COLOUR (RAL 9005).

**KEY**

- PROPOSED ROAD MARKINGS IN WHITE THERMOPLASTIC SCREED WITH APPLIED SOLID GLASS BEADS
- PROPOSED ROAD MARKINGS IN YELLOW THERMOPLASTIC SCREED WITH APPLIED SOLID GLASS BEADS
- PROPOSED ROAD MARKINGS IN HIGH FRICTION SURFACING WITH CHINESE GREY BAUXITE CHIPPINGS 1 TO 3mm AGGREGATE SIZE
- PROPOSED BOLLARD TYPE BL1
- EXISTING TRAFFIC SIGN ON EXISTING POST
- EXISTING TRAFFIC SIGN ON EXISTING LIGHTING COLUMN
- PROPOSED TRAFFIC SIGN ON PROPOSED POST
- PROPOSED TRAFFIC SIGN ON EXISTING POST

Revised: \_\_\_\_\_ By: \_\_\_\_\_ Date: \_\_\_\_\_  
 Reproduced from based upon the Ordnance Survey mapping with permission of the Controller of the Majesty's Stationery Office. © Crown copyright. Unauthorised reproduction infringes Crown copyright and may lead to prosecution or civil proceedings. NORTHUMBERLAND COUNTY COUNCIL - O.S. License No. 100049048 (2009)

**PLANNING APPLICATION**

Client:  
**NORTHUMBERLAND COUNTY COUNCIL**  
 COUNTY HALL, MORPETH  
 NORTHUMBERLAND, NE61 2EF

Job Title:  
**U6114 SITE OF FORMER MORPETH FIRST SCHOOL PROPOSED CAR PARK, GOOSEHILL, MORPETH**

Drawing Title:  
**TRAFFIC SIGNS AND ROAD MARKINGS LAYOUT**

Scale(s): **1/200**



**Northumberland County Council**  
**Technical Services**

Drawn: CH Date: NOV'19 Checked: GM Passed: GM  
 Drawing Number: TD180004/00/U6114/01/55  
 Oracle Number: FC180021

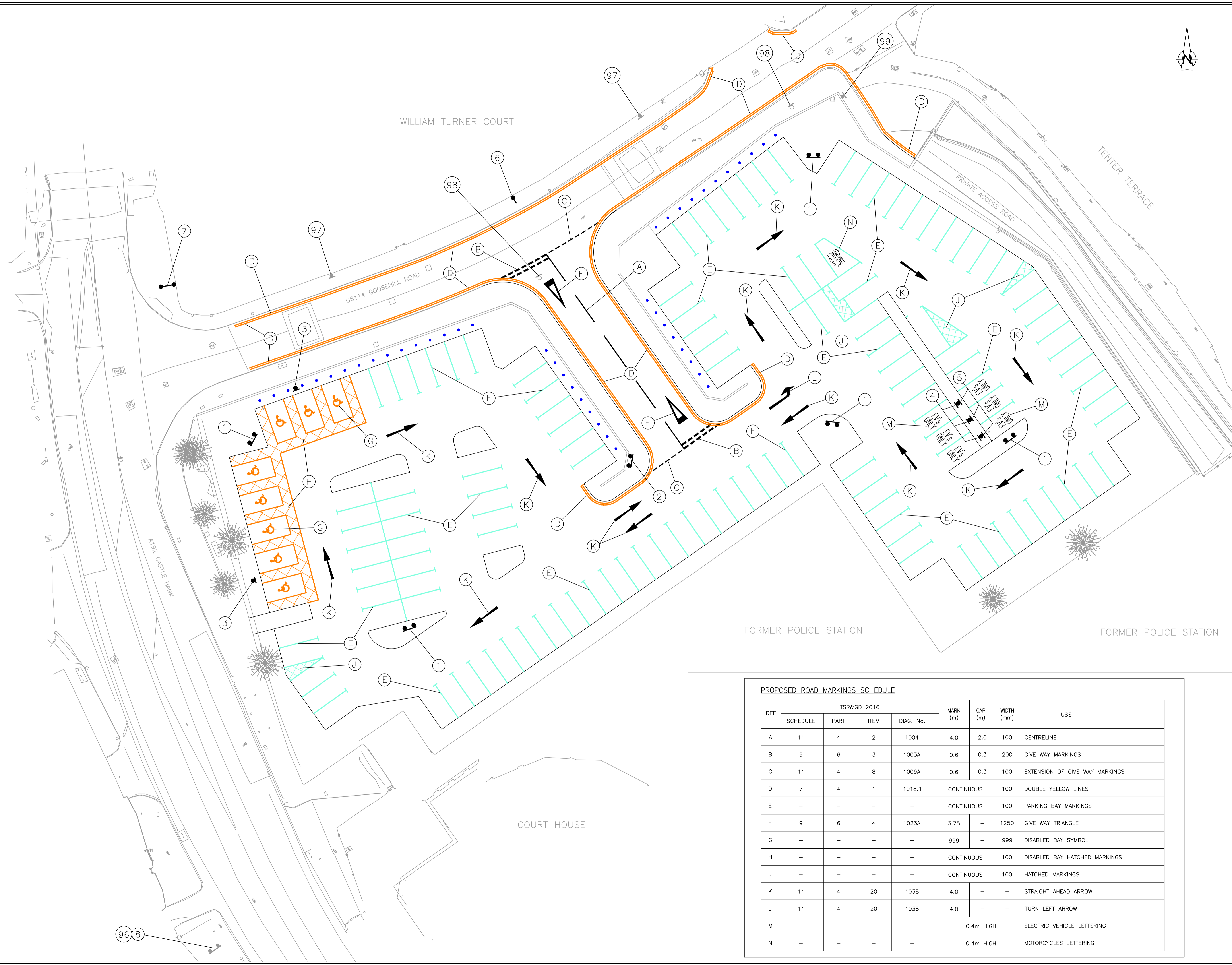

**PROPOSED ROAD MARKINGS SCHEDULE**

REF	TSR&GD 2016				MARK (m)	GAP (m)	WIDTH (mm)	USE
	SCHEDULE	PART	ITEM	DIAG. No.				
A	11	4	2	1004	4.0	2.0	100	CENTRELINE
B	9	6	3	1003A	0.6	0.3	200	GIVE WAY MARKINGS
C	11	4	8	1009A	0.6	0.3	100	EXTENSION OF GIVE WAY MARKINGS
D	7	4	1	1018.1	CONTINUOUS		100	DOUBLE YELLOW LINES
E	-	-	-	-	CONTINUOUS		100	PARKING BAY MARKINGS
F	9	6	4	1023A	3.75	-	1250	GIVE WAY TRIANGLE
G	-	-	-	-	999	-	999	DISABLED BAY SYMBOL
H	-	-	-	-	CONTINUOUS		100	DISABLED BAY HATCHED MARKINGS
J	-	-	-	-	CONTINUOUS		100	HATCHED MARKINGS
K	11	4	20	1038	4.0	-	-	STRAIGHT AHEAD ARROW
L	11	4	20	1038	4.0	-	-	TURN LEFT ARROW
M	-	-	-	-		0.4m HIGH		ELECTRIC VEHICLE LETTERING
N	-	-	-	-		0.4m HIGH		MOTORCYCLES LETTERING