

NORTHUMBERLAND COUNTY COUNCIL
TRAFFIC REGULATION ORDER

(Ref: TRO_005_45)

Northumberland County Council

North Northumberland (Northern) Area (Waiting & Loading)

Composite Order 2011

Amendment No 45 Order 2020

Made: 4th August 2020

Coming into Force: 17th August 2020

Northumberland County Council (hereinafter referred to as "the Council") in exercise of their powers under Sections 1, 2 and 4 and Paragraphs 20 and 27 of Schedule 9 of the Road Traffic Regulation Act 1984 ("the Act of 1984"), and after consulting with the Chief Officer of Police in accordance with Part III of Schedule 9 to the Act of 1984 and of all other enabling powers hereby make the following Order:-

1. Commencement and Citation

This Order shall come into operation on the 17th August 2020 and may be cited as "Northumberland County Council North Northumberland (Northern) Area (Waiting and Loading) Composite Order 2011 - Amendment No 45 Order 2020".

2. In the Order:-

"Order" means "Northumberland County Council North Northumberland (Northern) Area (Waiting and Loading) Composite Order 2011".

"Amendment Order" means "Northumberland County Council North Northumberland (Northern) Area (Waiting and Loading) Composite Order 2011- Amendment No 45 Order 2020".

The Interpretation Act 1978 shall apply to this Order as it applies to an Act of Parliament.

3. Provisions

The following provisions set out below and in The Schedule to this Amendment Order shall be additions to, deletions from, or substitutions in the restrictions in the Order:

(A) Additions

to Schedule 1 – Waiting

(Referenced in this Amendment Order as: First Schedule - ADDITIONS)

(B) Deletions

None

(C) Substitutions

None

THE COMMON SEAL OF NORTHUMBERLAND COUNTY COUNCIL was hereunto affixed this 4th day of August 2020 in the presence of:-

M. Wilcock

Duly Authorised Officer

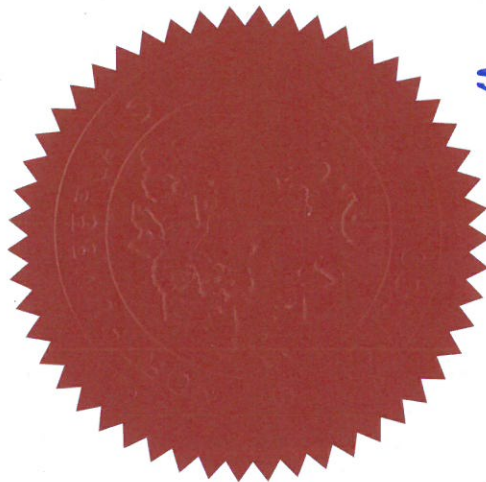

Seal No:-
22138.

FIRST SCHEDULE

ADDITIONS – Northumberland County Council North Northumberland (Northern) Area
(Waiting and Loading) Composite Order 2011 - Amendment No 45 Order 2020-
TRO_005_45

Schedule 1 – Waiting

Ref No	Street	Town	Side	Description	Proscribed Hours
7360	U2013 FRONT STREET BACK LANE	BAMBURGH	West	At its junction with Links Road to a point 48 metres south of its junction with Links Road	A
7359	U2013 FRONT STREET BACK LANE	BAMBURGH	East	At its junction with Links Road to a point 48 metres south of its junction with Links Road	A
7362	HIGH STREET	BELFORD	South West	A point 78 metres north west of its junction with Croftfield to a point 112 metres north west of its junction with Croftfield	A
7369	KING STREET	SEAHOUSES	East	At its junction with Kingsfield to a point 10 metres south of its junction with Kingsfield	A
7368	KING STREET	SEAHOUSES	East	At its junction with Kingsfield to a point 10 metres north of its junction with Kingsfield	A
7366	KINGSFIELD	SEAHOUSES	North	At its junction with Kings Street to a point 53 metres east of its junction with Kings Street	A
7364	KINGSFIELD	SEAHOUSES	South	At its junction with Kings Street to a point 53 metres east of its junction with Kings Street	A

**ROAD TRAFFIC REGULATION ACT 1984
NORTHUMBERLAND COUNTY COUNCIL**

**NORTH NORTHUMBERLAND (NORTHERN) AREA (WAITING AND LOADING)
COMPOSITE ORDER 2011 AMENDMENT NO 45 ORDER 2020**

**STATEMENT OF THE COUNCIL'S REASONS FOR
MAKING THE ORDER**

The Order is necessary in order to reduce congestion and improve road safety in Front Street Back Lane Bamburgh, High Street, Belford and Kingsfield Seahouses in the County of Northumberland.

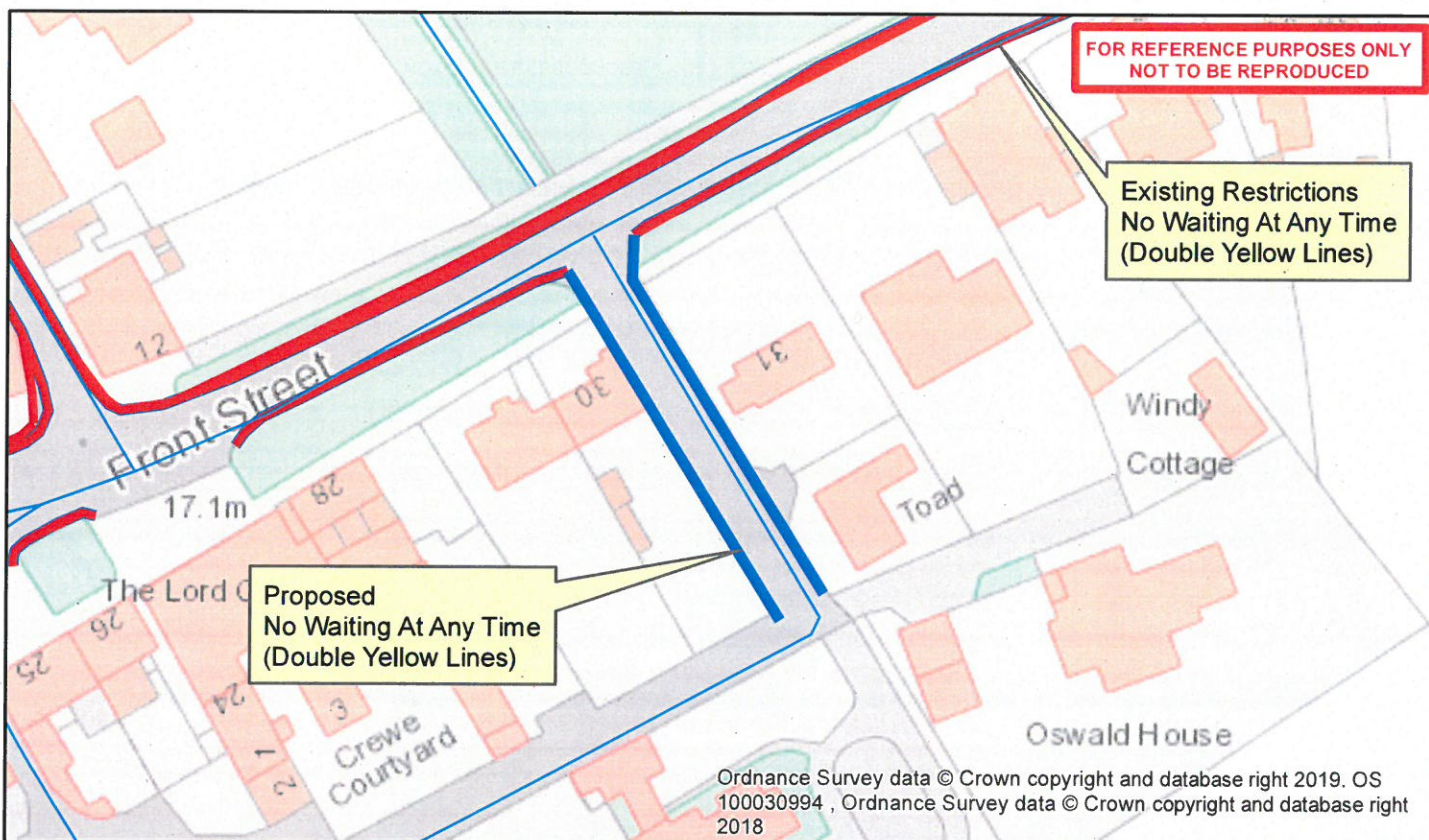

<p>Northumberland Northumberland County Council</p>	<p>Network Management Information System</p>	<p>Title:</p>			<p>Front Street Back Lane Bamburgh TRO_005_45 31 Jan 2020</p>
<p>Northumberland County Council County Hall Morpeth Northumberland NE61 2EF Tel: 01670 533000</p>	<p><small>This map is reproduced from Ordnance Survey material with the permission of Ordnance Survey on behalf of the Controller of Her Majesty's Stationary Office Crown Copyright. Unauthorised reproduction infringes Crown Copyright and may lead to prosecution or civil proceedings. License no. 100049048 (2009).</small></p>	<p>Drm:</p>	<p>Date:</p>	<p>Scale:</p>	

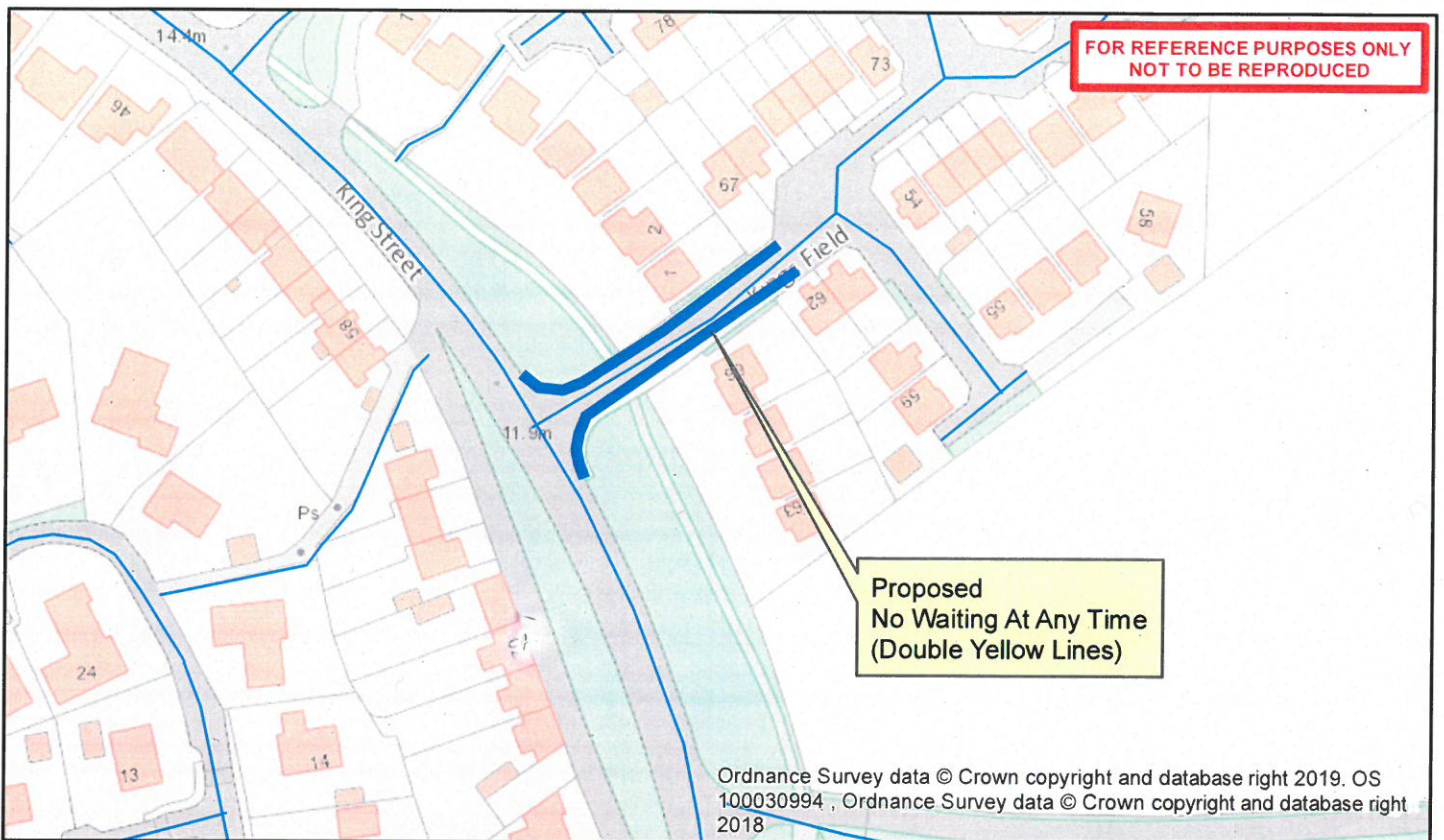

Northumberland
Northumberland County Council

**Network Management
Information System**

Title:

**Kingsfield
Seahouses
TRO_005_45
31 Jan 2020**

Northumberland County Council
County Hall
Morpeth
Northumberland NE61 2EF Tel: 01670 533000

This map is reproduced from Ordnance Survey material with the permission of Ordnance Survey on behalf of the Controller of Her Majesty's Stationary Office. Crown Copyright. Unauthorised reproduction infringes Crown Copyright and may lead to prosecution or civil proceedings. License no. 100049048 (2009).

Drn:

Date:

Scale:

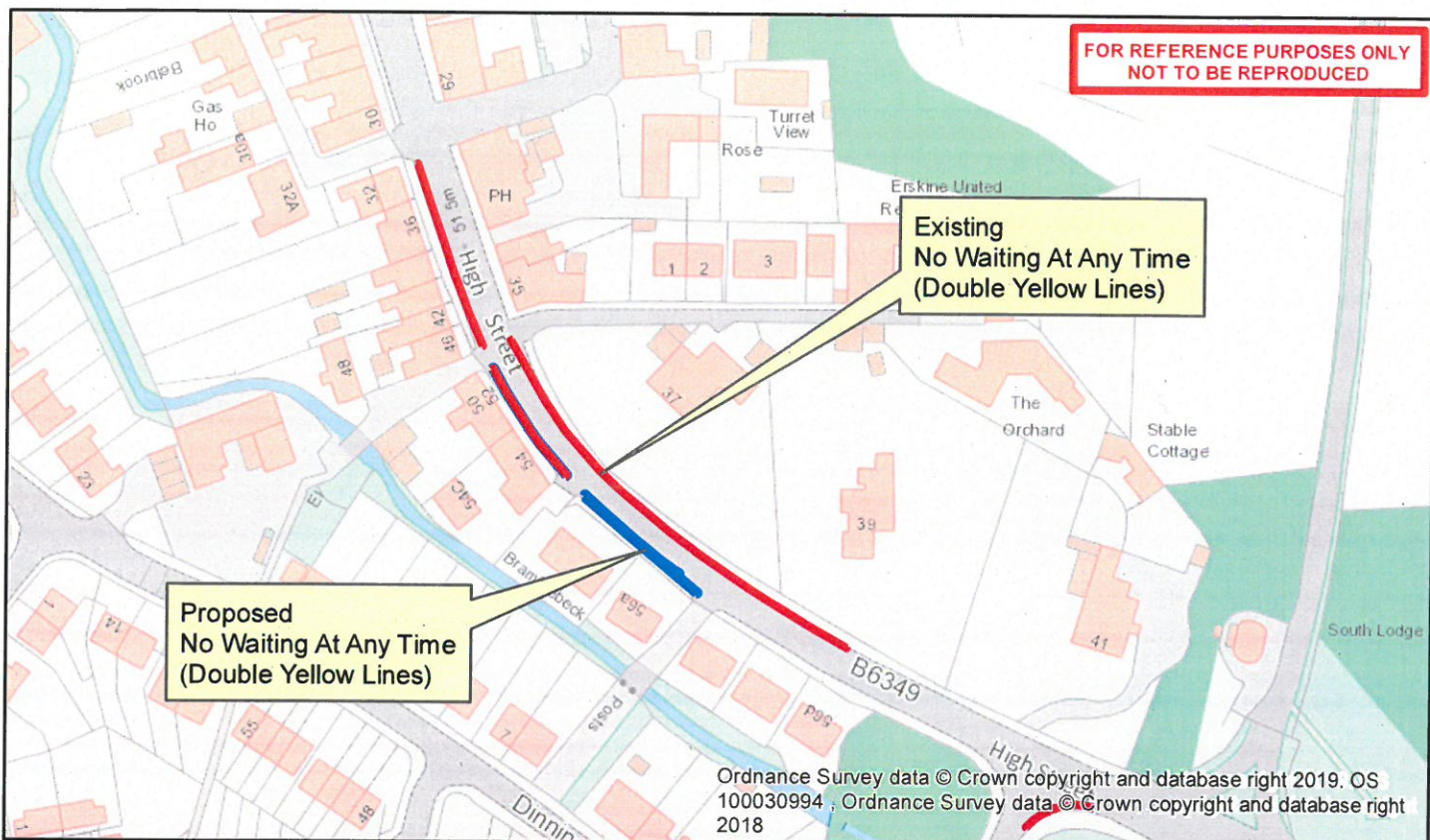

Northumberland Northumberland County Council	Network Management Information System	Title:	High Street Belford TRO_005_45 31 Jan 2020		
Northumberland County Council County Hall Morpeth Northumberland NE61 2EF Tel: 01670 533000	<small>This map is reproduced from Ordnance Survey material with the permission of Ordnance Survey on behalf of the Controller of Her Majesty's Stationary Office. Crown Copyright. Unauthorised reproduction infringes Crown Copyright and may lead to prosecution or civil proceedings. License no. 100046048 (2009).</small>	Drn:	Date:	Scale:	