

**THE COUNTY COUNCIL OF NORTHUMBERLAND**

**ROAD TRAFFIC REGULATION ACT 1984  
(A192 MORPETH - STOBHILL 30 MPH SPEED RESTRICTION) ORDER 2017  
(TROM\_067)**

The Northumberland County Council, in exercise of their powers under Sections 1(1), 2(1) and (2), 82(2), 83(2) and 84(1) and Part III and Part IV of Schedule 9 to the Road Traffic Regulation Act 1984, hereby make the following order:

1. (1) This Order shall come into operation on the 2<sup>nd</sup> October 2017 and may be cited as "The County of Northumberland (A192 Morpeth – Stobhill 30 MPH Restrictions) Order 2017."  
  
(2) The restrictions imposed by this Order shall be in addition to and not in derogation from any restriction or requirement imposed by any regulation made or having effect as if made under the Act or by or under any other enactment.  
  
(3) Except where otherwise stated, any reference in this Order to a numbered article or schedule is a reference to the article or schedule bearing that number in this Order.
2. Save as provided in Article 3, this Order shall render it unlawful for a person to cause or permit a vehicle to proceed at a speed in excess of 30 mph on those lengths of highway detailed in Schedule 1.
3. Nothing in Article 2 shall make it unlawful for a person to drive in excess of the stated speed limit on the length of roads specified in that Article if it is being used for police, fire and rescue or ambulance purposes.

**GIVEN** under the Common Seal of the County Council of Northumberland this 18<sup>th</sup> day of September 2017.

The **COMMON SEAL** of **THE COUNTY COUNCIL OF NORTHUMBERLAND** was hereunto affixed in the presence of:

*N. J. Morrison*

Duly Authorised Officer.



*Seal No  
16638*

## **SCHEDULE 1**

### **(A192 MORPETH - STOBHILL 30 MPH RESTRICTIONS) ORDER 2017 (TROM\_067)**

#### **30 MPH Speed Restriction**

**30 MPH Speed Restrictions on the following lengths of highway  
(and for reference only detailed, on the attached plan)**

<b>NSGID</b>	<b>Road Number</b>	<b>Street Name</b>	<b>Town</b>	<b>Description</b>
06220425	A192	A192 HEPSCOTT PARK TO STOBHILL ROUNDAABOUT	MORPETH	At its junction with Stobhill Roundabout (A196) to a point 287 metres south east of its junction with Stobhill Roundabout (A196) (grid reference 421014 584522)

**THE COUNTY COUNCIL OF NORTHUMBERLAND**

**ROAD TRAFFIC REGULATION ACT 1984  
(A192 MORPETH - STOBHILL 30 MPH RESTRICTIONS) ORDER 2017  
(TROM\_067)**

**STATEMENT OF THE COUNCIL'S REASONS FOR  
MAKING THE ORDER**

The Order is necessary for traffic safety concerns raised as a result of speeding traffic in this area. Extension of existing 30 mph limits to accommodate new traffic calming measures and gateway signage.

split interest, its part of this document may be reproduced in any form without including photocopying or storing in any medium without the prior permission of International Country Council except in connection with the provisions of Copyright, Designs and Patents Act 1988. Unauthorised reproduction may lead to prosecution or damages.

C2 information is saved in the project folder in the following location

S:\Highways\PROJECTS\WVF15  
Local Safety Schemes\WVF15218 -  
Rural Roads - Signs &  
Markings\WVF15218-19 A192 South  
of Stobhill Roundabout\WVMS  
FILES\2015\_12\04 C2 Returns

KEY	Footway construction type F1	Buff tactile paving	Drop kerb type D1	Flush kerb type K10	Pin kerb type K5	Visibility envelope

	No.	Date	Time
100	Feb 7	B	
100	Dec 18	A	

the Controller of Her Majesty's Stationery Office. © Crown Copyright. Published under license from the Controller of Her Majesty's Stationery Office. All rights reserved. No part of this publication may be reproduced, stored in a retrieval system, or transmitted, in any form or by any means, electronic, mechanical, photocopying, recording, or by any information storage or retrieval system, without prior permission in writing from the Controller of Her Majesty's Stationery Office.

Contract	ORTHUMBERLAND COUNTY COMMISSION
----------	---------------------------------

A192 South of Stobhill

<p> </p>	<p> </p>
----------	----------

Northumberland

in	Date	Classified	Processed
MI	DEC 15	GM	GM

Working Number  
 MF152518-19/01/A192/01/01  
 01 Number/PS Number  
 MF152518-19

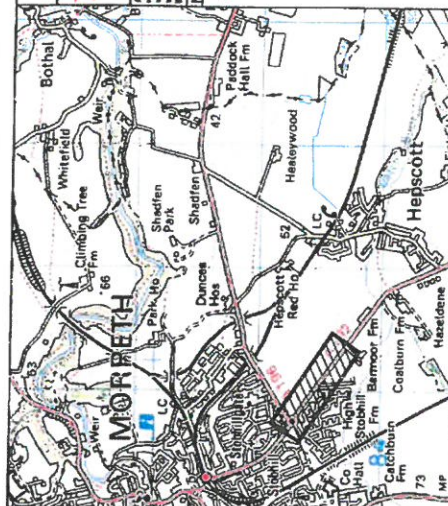

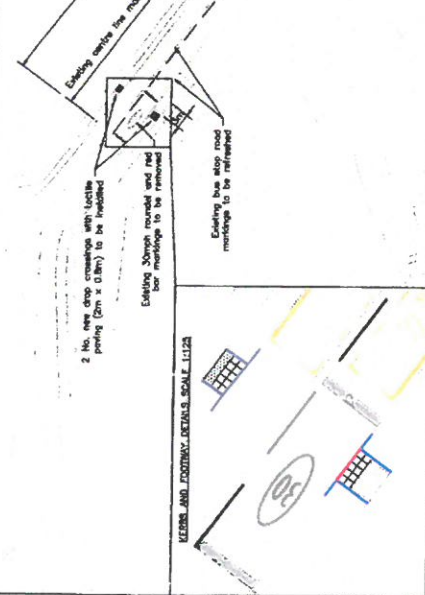
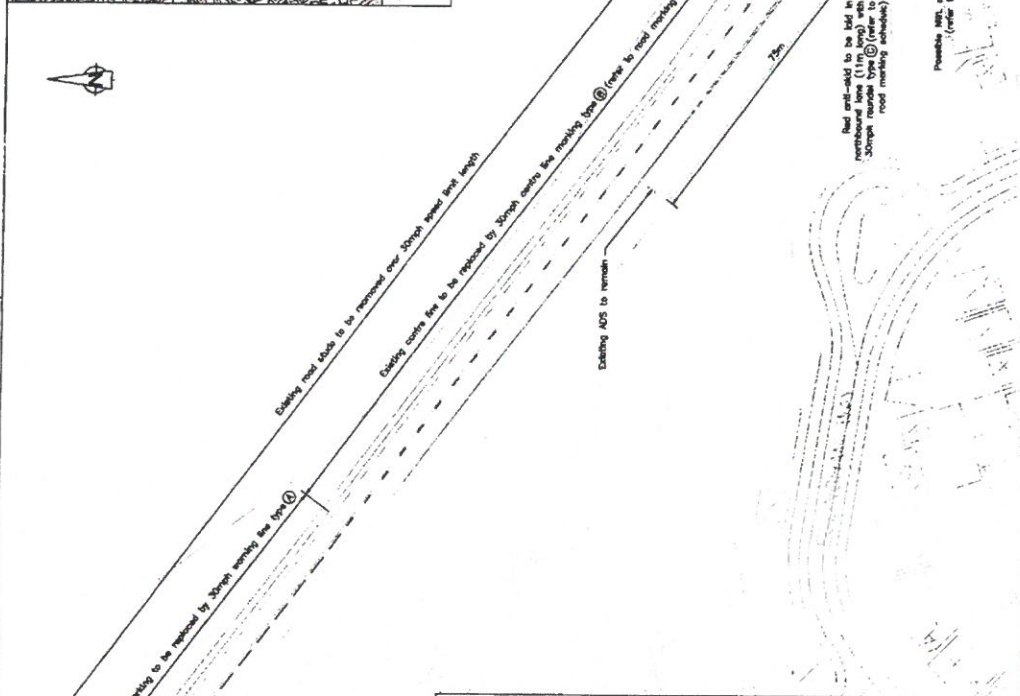

### Location Plan



NEW ROAD MARKING SCHEDULE				
REF	1000 NO. MARK (mm)	CAP WIDTH (mm)	ROAD EDGE	LINE
A	1004	4	100	WHITE CENTRAL DIVISION LINES
B	1008	2	100	WHITE CENTRAL LINE
C	1040	-	-	WHITE SHOULDER REDUCED 7.5m HIGH (MINIMUM 2.5m HIGH)

NOTE:  
 1. NEW MARKINGS TO BE IN WHITE ON YELLOW BUILT UP SURFACES  
 2. NEW MARKINGS TO BE IN WHITE ON BLACK BITUMEN PAVED SURFACES  
 3. DOWEL MARKINGS TO BE CLEAR BEFORE LAYING ASPHALT

NEW TAPPS SIGNS SCHEDULE						
TRAFFIC SIGN	TRAFFIC SIGN NO.	TRAFFIC SIGN DESCRIPTION	TRAFFIC SIGN SYMBOL	TRAFFIC SIGN MESSAGE	TRAFFIC SIGN MESSAGE	TRAFFIC SIGN MESSAGE
1	670 (A.U.)		180 4 2	180 4 2	180 4 2	180 4 2
2	671		-	180 4 2	180 4 2	180 4 2
3	681A		180 4 2	180 4 2	180 4 2	180 4 2

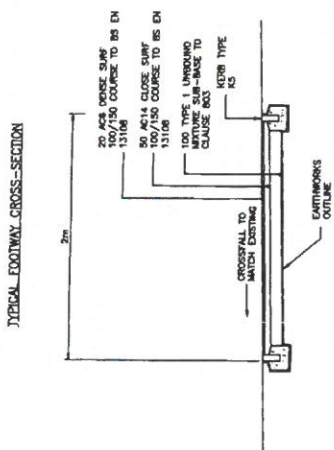

TYPICAL FOOTWAY CROSS-SECTION

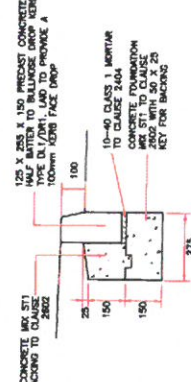

KERB TYPE 01  
125-100mm HALF BATTER DROP

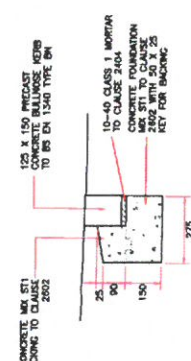

KERB DETAIL K10  
DDOP BULLNOSE KERB

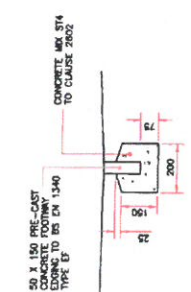

KERB TYPE K5  
FOOTWAY EDGING KERB