

THE COUNTY COUNCIL OF NORTHUMBERLAND
ROAD TRAFFIC REGULATION ACT 1984
(SPITAL ESTATE NEWBIGGIN BY THE SEA AND SURROUNDING AREA
20 MPH SPEED RESTRICTION) ORDER 2017
(TROM_033)

The Northumberland County Council, in exercise of their powers under Sections 1(1), 2(1) and (2), 82(2), 83(2) and 84 and Part III and Part IV of Schedule 9 to the Road Traffic Regulation Act 1984, hereby make the following order:

1. (1) This Order shall come into operation on the 23rd October 2017 and may be cited as "The County of Northumberland (Spital Estate Newbiggin-by-the-Sea and Surrounding Area 20 MPH Speed Restriction) Order 2017."
(2) The restrictions imposed by this Order shall be in addition to and not in derogation from any restriction or requirement imposed by any regulation made or having effect as if made under the Act or by or under any other enactment.
(3) Except where otherwise stated, any reference in this Order to a numbered article or schedule is a reference to the article or schedule bearing that number in this Order.
2. Save as provided in Article 3, this Order shall render it unlawful for a person to cause or permit a vehicle to proceed at a speed in excess of 20 mph on those lengths of highway detailed in Schedule 1.
3. Nothing in Articles 1 and 2 shall make it unlawful for a person to drive in excess of the stated speed limit on the length of roads specified in that Article if it is being used for police, fire and rescue or ambulance purposes.

GIVEN under the Common Seal of the County Council of Northumberland this 10th day of October 2017.

The **COMMON SEAL** of **THE COUNTY COUNCIL OF NORTHUMBERLAND** was hereunto affixed in the presence of:



Duly Authorised Officer.



Seal no
16924

SCHEDULE 1

**20 MPH Speed Restrictions on the following lengths of highway
(and for reference only detailed, on the attached plan)**

NSGID	Road Number	Street Name	Town
42002312	U6518	AVIS AVENUE for its entire length	NEWBIGGIN-BY-THE-SEA
42001292	U6518	DERWENTWATER ROAD for its entire length	NEWBIGGIN-BY-THE-SEA
42000603	U6518	HAWESWATER CRESCENT for its entire length	NEWBIGGIN-BY-THE-SEA
42000553	U6518	HEPPLE ROAD for its entire length	NEWBIGGIN-BY-THE-SEA
42003942	U6518	RYDAL MOUNT for its entire length	NEWBIGGIN-BY-THE-SEA
42003642	U6518	SPITAL CRESCENT for its entire length	NEWBIGGIN-BY-THE-SEA
42005427	U6518	SPITAL ROAD for its entire length	NEWBIGGIN-BY-THE-SEA
42003041	U6518	ULLSWATER ROAD for its entire length	NEWBIGGIN-BY-THE-SEA
42002688	U6518	WINDERMERE ROAD for its entire length	NEWBIGGIN-BY-THE-SEA

THE COUNTY COUNCIL OF NORTHUMBERLAND
ROAD TRAFFIC REGULATION ACT 1984
(SPITAL ESTATE NEWBIGGIN BY THE SEA AND SURROUNDING AREA
20 MPH SPEED RESTRICTION) ORDER 2017
(TROM_033)

STATEMENT OF THE COUNCIL'S REASONS FOR
MAKING THE ORDER

The Order is necessary as this area of Newbiggin-by-the Sea has traffic safety concerns as a result of excessive speeding in a residential area.

This Order compliments Northumberland County Council's initiative to introduce 20 miles per hour speed limits outside of schools.

JUNCTION ENTRY LAYOUT
SCALE 1:200

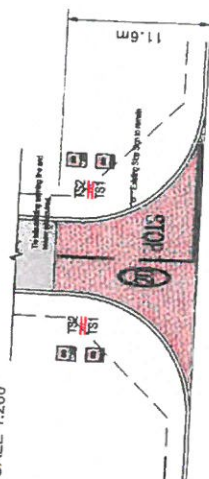

20mph Red Surface Entry Layout at junction
(Antiskid textured surfacing)

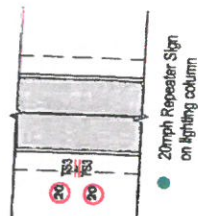

20mph Repeater Sign on lighting column

[illegible][illegible]

Proposed Entry Layout:
Antiskid textured surfacing, colour red

Existing road humps ahead signs and poles to be removed and replaced with proposed 20mph Zone/Zone ends signs including new 76mm posts.