



Northumberland County Council

RECORD OF DECISION TAKEN BY THE DIRECTOR OF ENVIRONMENT AND TRANSPORT

Paul Jones – Director of Environment & Transport

**Proposed School Keep Clear Amendments – Malvin’s Close Academy,
Blyth**

**Cabinet Member: Councillor John Riddle, Improving Our Roads &
Highways**

19 January 2024

Purpose of Report

This report sets out the background to the proposal to amend the existing ‘No stopping on entrance markings’ (School Keep Clear) parking restrictions outside Malvin’s Close Academy in Blyth.

Recommendation

It is recommended that the existing parking restrictions are amended as proposed in order to improve road safety in the area.

Link to Corporate Plan

This report is relevant to the following key themes in the Corporate Plan for 2023-26:

‘Thriving Places and Culture – Neighbourhoods are safe, clean and well maintained’

Key Issues

1. Northumberland County Council has received concerns regarding obstructive and indiscriminate parking directly outside the entrance to Malvin’s Close Academy on Albion Way in Blyth.
2. ‘No stopping on entrance markings’ in the form of School Keep Clear restrictions are currently in place on Albion Way in order to prohibit

Delegated Decision

vehicles from parking outside the entrance to Malvin's Close Academy during school hours, however the current alignment allows motorists to use a section of the junction to park on.

3. Amendments to the alignment of the School Keep Clear restrictions are therefore proposed in order to alleviate these concerns.
4. The scheme is supported by the local County Councillor and school representatives.
5. The scheme is to be funded through the 2023/24 Local Transport Plan (LTP) programme.

Background

Albion Way is a single carriageway road situated directly outside Malvin's Close Academy which includes a school entrance access with waiting and loading restrictions in place to deter motorists from parking near the access. 'No stopping on entrance markings' commonly known as School Keep Clear zig-zag markings have been implemented across the junction of Albion Way and the entrance to Malvin's Close Academy, as per the Council's policy to do so outside all its schools where possible.



Fig. 1: Example of existing layout on Albion Way, Blyth (Source: Google Maps, 2024)

As can be observed in Figure 1, the restrictions extend across the junction of the school's access as opposed to following the kerblines and concerns have subsequently been raised regarding vehicles parking within the junction, thereby avoiding the markings. By doing so, this obstructs the uncontrolled crossing for pedestrians attempting to cross the carriageway, obstructs the footway outside the school and obstructs visibility for road users which creates road safety issues in an area where vulnerable pedestrians such as schoolchildren are more likely to be present.

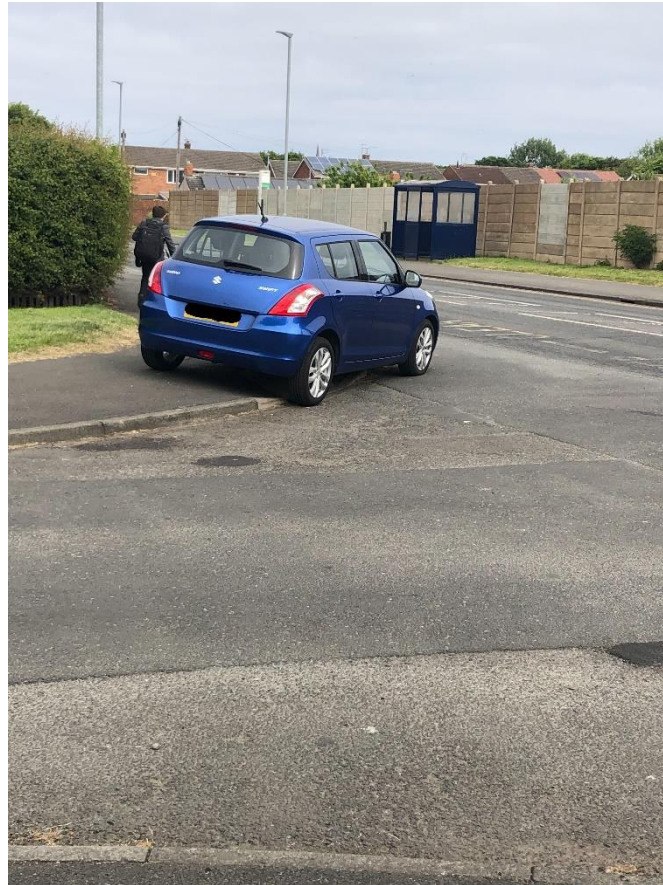

Fig. 2: Example of current parking behaviour outside Malvin's Close Academy, Blyth

As a result, the School Keep Clear zig-zag markings are proposed to be removed from the centre of the junction and extended into the junction following the kerblines, in order to alleviate the concerns raised and to prohibit vehicles from stopping directly outside Malvin's Close Academy.

The maximum length of School Keep Clear zig-zag markings prescribed by the Traffic Signs Regulations and General Directions 2016 is 43.56 metres, meaning on the western extents of the junction the markings would be slightly shorter than what is currently in place. Whilst enough forward visibility would be provided at the junction with these new markings, 'No Waiting at Any Time' restrictions in the form of double yellow lines are proposed to replace this short section so that vehicles are still prohibited from parking near the school entrance.

The proposed amendments to the existing restrictions can be observed in Appendix A. It is intended to increase road safety, maintain the free flow of traffic where possible and to protect the amenity of the area. Northumbria Police, other emergency services, relevant statutory consultees and directly affected properties will be notified of this amendment as part of the process for making the Traffic Regulation Order.

Delegated Decision

Implications Arising out of the Report

Policy	Consistent with existing policies.
Finance and value for money	Scheme will be financed through the LTP 2023/24 programme.
Legal	Motorists will be required to comply with the Traffic Regulation Order.
Procurement	None
Human Resources	None
Property	None
Equalities Yes <input type="checkbox"/> No <input type="checkbox"/> N/A <input type="checkbox"/>	N/A
Risk Assessment	The proposal is designed to reduce the risks associated with obstructive and indiscriminate parking.
Crime & Disorder	Regulations in place to carry out enforcement.
Customer Consideration	Statutory consultees have been informed.
Carbon reduction	None
Wards	Cowpen

Delegated Decision

Background Papers

File reference – S:\Highways\PROJECT\22\HE Minor Improvements\HE223627D - Malvins Close Academy

Appendix A – Scheme Layout

Author

Report Author **William Binks, Programme Officer**

Delegated Decision

DECISION TAKEN

Title of Officer	Director of Environment & Transport
Subject	Proposed amendments to existing parking restrictions at Malvin's Close Academy, Blyth
Consultation	Not required on grounds of road safety, however statutory consultees have been informed
Decision Taken	To amend the existing 'No stopping on entrance markings' (School Keep Clear zig-zag markings) at Malvin's Close Academy, Blyth

Signature of Director







Date

22nd February 2024

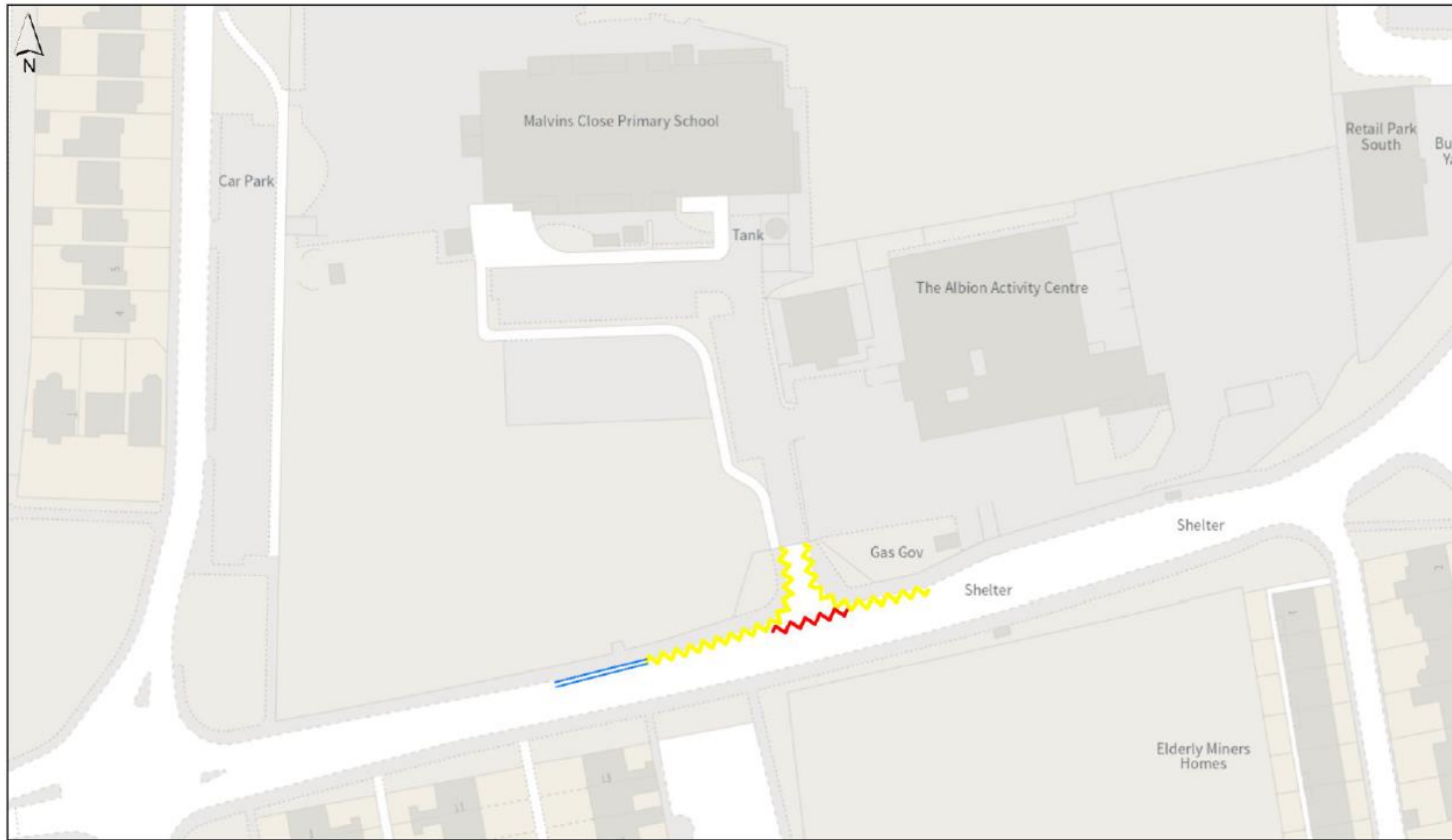
Delegated Decision

Appendix A – Scheme Layout



 <p>Northumberland County Council</p> <p><small>Northumberland County Council County Hall Morpeth Northumberland NE61 2EF Tel: 0345 600 6400</small></p>	<p>Proposed Parking Restrictions Albion Way Blyth</p> <p><small>This map is reproduced from Ordnance Survey material with the permission of Ordnance Survey on behalf of the Controller of Her Majesty's Stationary Office. Crown Copyright. Unauthorised reproduction infringes Crown Copyright and may lead to prosecution or civil proceedings. License no. 100049048 (2010).</small></p>	<p>Key:</p> <ul style="list-style-type: none">  Proposed School Keep Clear Restrictions Mon-Fri 8am-5pm  Existing School Keep Clear Restrictions to be Removed  Proposed 'No Waiting at Any Time' Restrictions (Double Yellow Lines) to replace existing School Keep Clear Restrictions 	
<p><small>Drn: WB</small></p>		<p><small>Date: 19.01.24</small></p>	<p><small>Scale: 1:1,000</small></p>