



# Northumberland

## County Council

### **RECORD OF DECISION TAKEN BY DIRECTOR OF ENVIRONMENT AND TRANSPORT**

**Paul Jones**

---

**Grace Darling Church of England Primary School 20 MPH Speed Limit**

**Cabinet Member: Councillor John Riddle**

**29 June 2023**

---

### **Purpose of Report**

This report sets out the background to the proposals to introduce a 20 MPH speed limit in the vicinity of Grace Darling Church of England Primary School in Newbiggin-by-the-Sea.

### **Recommendations**

It is recommended that the 20 MPH speed limit should be introduced as proposed in order to improve road safety in the area around the school. In addition, it is also recommended that the proposed physical traffic calming measures are also introduced in order to maintain low speeds which will complement the new speed limit.

### **Link to Corporate Plan**

This report is relevant to the following key themes in the Corporate Plan for 2023-26:

‘Thriving Places and Culture – Neighbourhoods are safe, clean and well maintained’

### **Key Issues**

1. The County Council has received concerns regarding traffic speeds in the residential streets near Grace Darling Church of England Primary School in Newbiggin-by-the-Sea.
2. The provision of a 20 MPH speed limit adjacent to Grace Darling Church of England Primary School is in accordance with the County Council’s

## **Delegated Decision**

---

current policy to introduce 20 MPH speed limits at all schools provided it is feasible to do so.

3. Physical traffic calming measures in the form of two raised tables are also proposed to complement the 20mph speed limit. These measures will encourage motorists to drive at an appropriate speed.
4. The scheme is supported by the local County Councillors, Newbiggin Town Council and school representatives.
5. The scheme is to be funded through the 2023/24 Local Transport Plan (LTP) programme, together with contributions from Councillor Simpson and Councillor Lang's Members' Local Improvement Scheme allocation.

### **Background**

The introduction of speed limit changes near Grace Darling Church of England Primary School forms part of the 2023/24 Local Transport Plan. The scheme ties in with the County Council's road safety initiative to introduce reduced speed limits adjacent to all schools in Northumberland provided it is feasible to do so. Evidence suggests that measures of this kind adjacent to schools provide a safer environment for all road users.

Concerns have been raised regarding vehicles speeding through the roads situated outside of the school, which presents road safety issues for pedestrians such as schoolchildren, cyclists and those navigating through the route with the risk of collisions occurring.

As a result, a 20 MPH speed limit is proposed to be introduced in order to alleviate these concerns and covers the areas identified below in Figure 1. The measures will consist of new regulatory traffic signs along with road markings in the form of roundels at the entrance of the estate to indicate the new speed limit.

Central Parkway is the main route directly outside the school, this is a long straight road which can lend itself to excessive speeds. In order to address this issue, physical traffic calming measures in the form of two raised tables are also to be introduced.

The scheme has the full support of Councillor Simpson and Councillor Lang who have both made contributions to this scheme from their Members Local Improvements Scheme allowance.

Delegated Decision

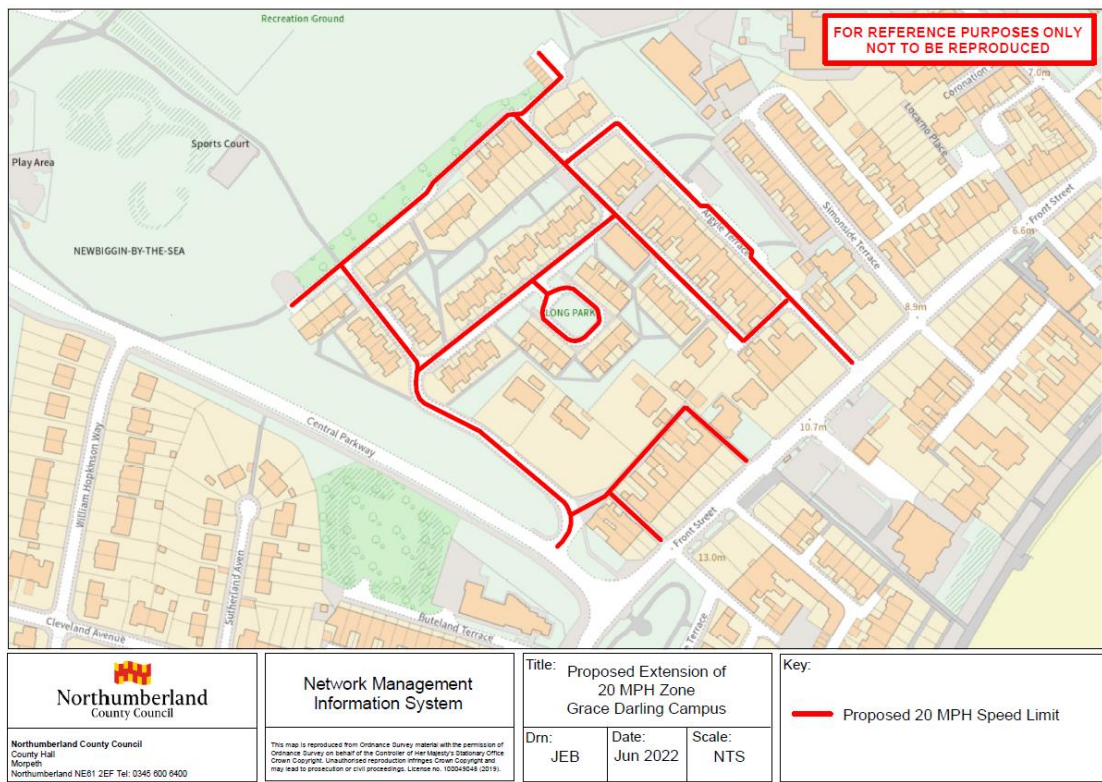

Fig. 1: Proposed 20 MPH speed limit extents at Grace Darling C of E Primary School.

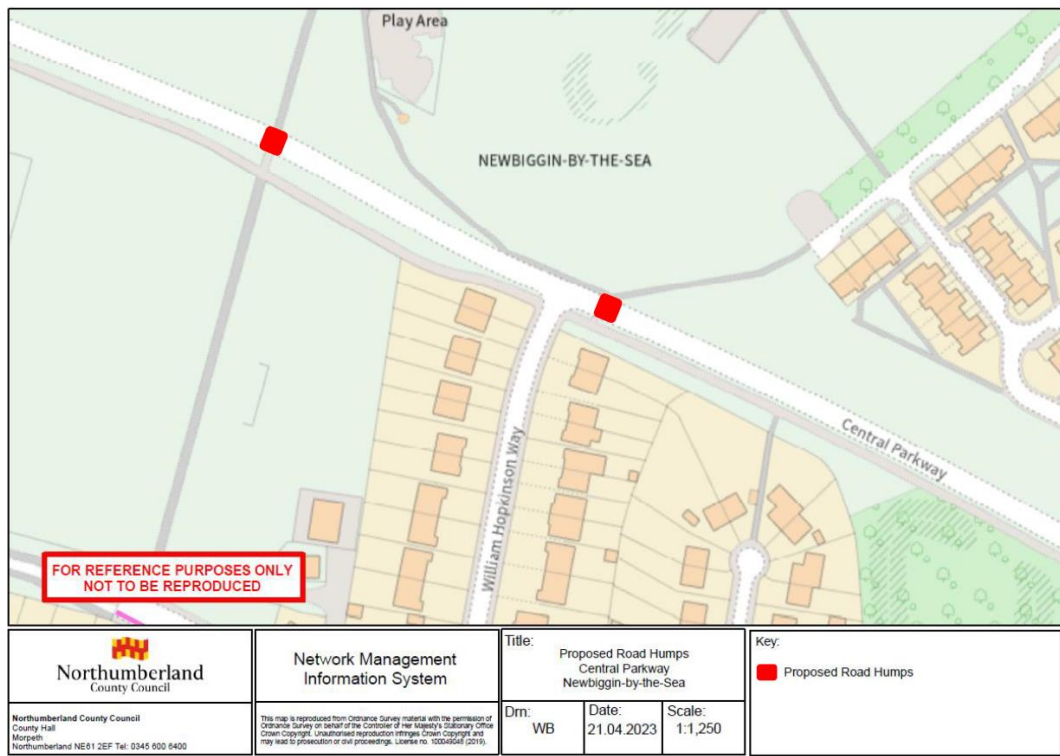

Fig. 2: Proposed raised table locations at Central Parkway, Newbiggin

Full details of the proposals are available in Appendix A. They are intended to increase road safety by reducing speed limits and to protect the amenity of the area overall. Northumbria Police, other emergency services and relevant

## **Delegated Decision**

---

statutory consultees will be notified of these amendments as part of the process for making the permanent Orders.

## Delegated Decision

---

### Implications Arising out of the Report

<b>Policy</b>	Consistent with existing policies
<b>Finance and value for money</b>	The scheme will be financed through the LTP 2023/24 Programme
<b>Legal</b>	Motorists will be required to comply with the Traffic Regulation Order
<b>Procurement</b>	None
<b>Human Resources</b>	None
<b>Property</b>	None
<b>Equalities</b>	N/A
<b>Risk Assessment</b>	The proposal is designed to reduce the risks associated with driving at speed
<b>Crime &amp; Disorder</b>	Regulations in place to carry out enforcement
<b>Customer Consideration</b>	A reduction in speed will lead to a safer environment for all road users
<b>Carbon reduction</b>	Speed reduction assists with carbon reduction
<b>Ward</b>	Seaton with Newbiggin West

## **Delegated Decision**

---

### **Background Papers**

File reference – S:\Highways\PROJECT\20\HE Minor Improvements\HE203424D - Grace Darling Campus, Newbiggin

Appendix A – Scheme Layout

### **Author**

---

**Report Author     William Binks, Programme Officer**

**DECISION TAKEN**

<b>Title of Officer</b>	Director of Environment & Transport
<b>Subject</b>	Proposed 20 MPH Speed Limit at Grace Darling Church of England Primary School
<b>Consultation</b>	Not required – NCC policy is to introduce 20 MPH speed limits at all schools provided it is feasible to do so. However statutory consultees have been informed
<b>Decision Taken</b>	<p>To introduce a 20 MPH Speed Limit in the area surrounding Grace Darling Church of England Primary School.</p> <p>To introduce the physical traffic calming measures in the form of two raised tables as proposed.</p>

**Signature of Director**



---

**Date**

7<sup>th</sup> August 2023

---







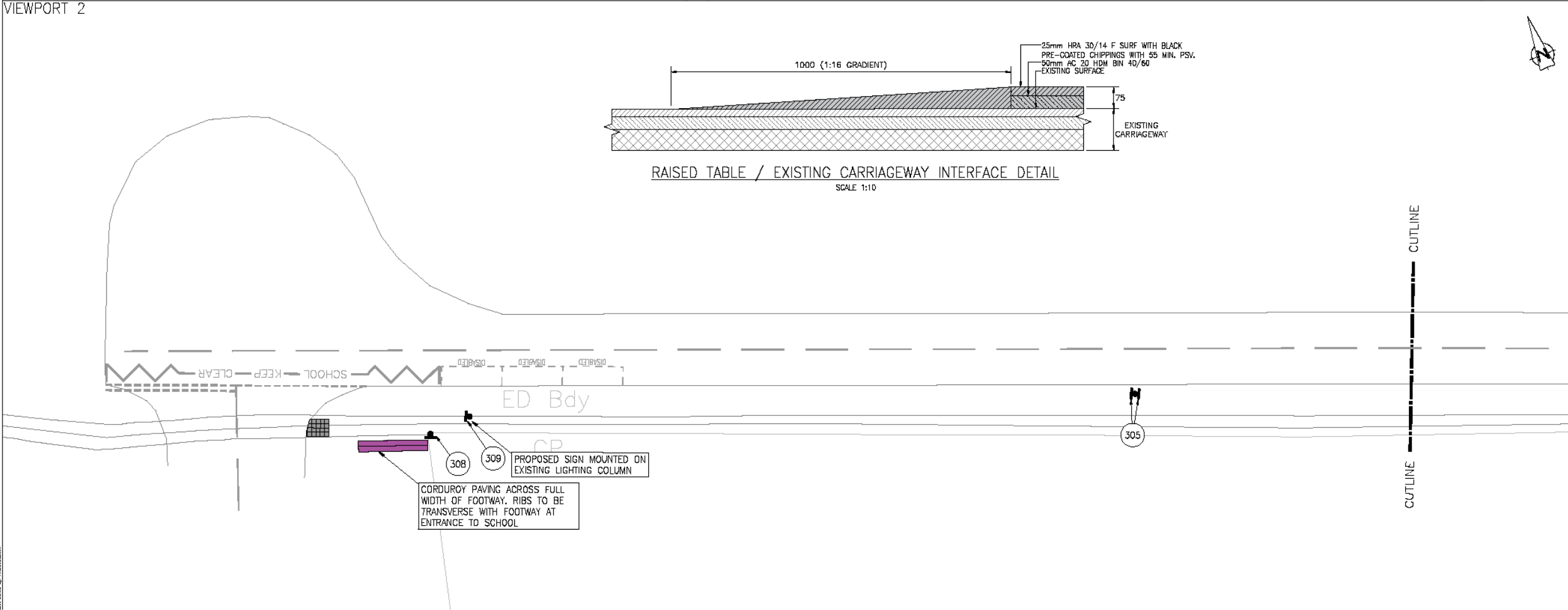
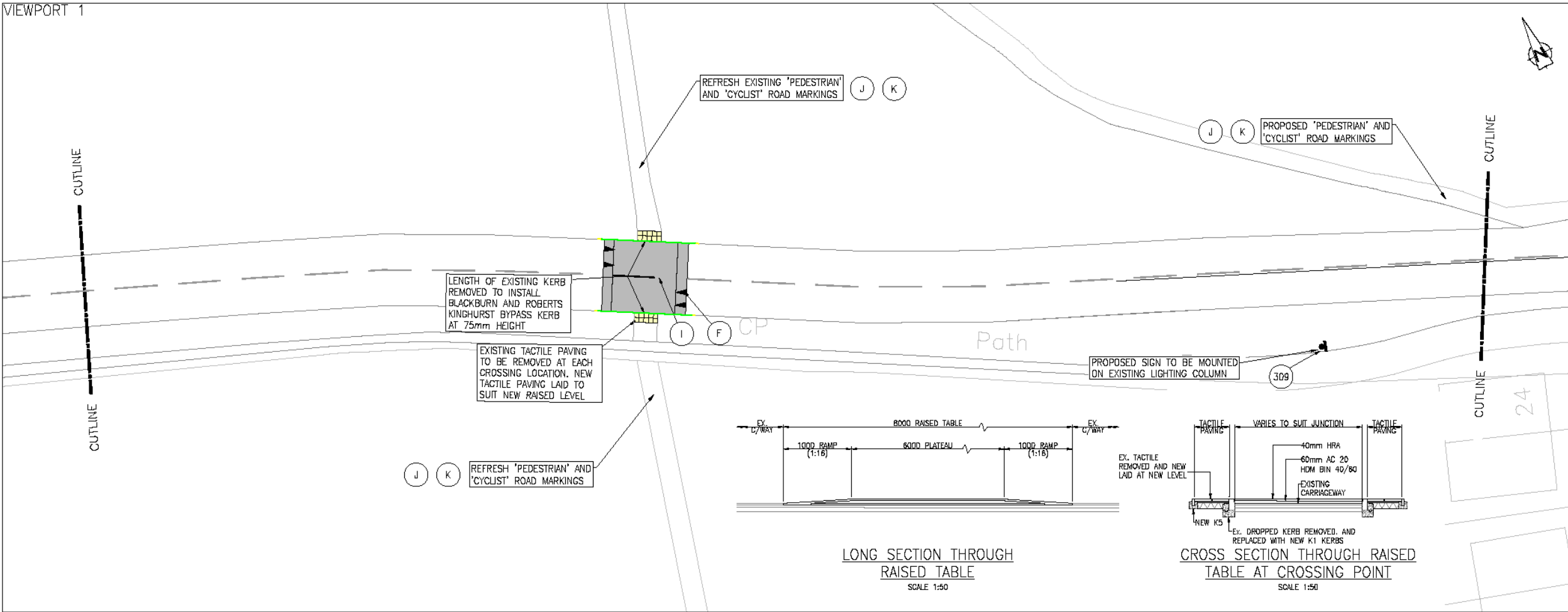

Contract No.: 3

Drawing No.: A1

Northumberland  
County Council

All rights reserved. No part of this document may be reproduced in any material form (including photocopying or storing in any medium) without the written permission of Northumberland County Council except in accordance with the provisions of Copyright, Designs and Patents Act 1988. Unauthorised reproduction may lead to prosecution or civil proceedings.

**NOTES:**

- 1.1. ALL DIMENSIONS IN MILLIMETRES (mm) UNLESS STATED OTHERWISE.
- 1.2. ALL LEVELS IN METRES (m) IN REFERENCE TO GPS CO-ORDINATE SYSTEM.
2. ROAD MARKINGS
- 2.1. ROAD MARKINGS TO BE IN WHITE (UNLESS NOTED OTHERWISE IN SCHEDULE) THERMOPLASTIC SCREENED WITH APPLIED GLASS BEADS.
- 2.2. ROAD MARKINGS SHOULD BE IN ACCORDANCE WITH CLASSE 1212 OF SHW.
- 2.3. RETRO-REFLECTIVITY REQUIREMENTS COMMENCE FROM THE DATE OF APPLICATION OR DATE OF TENDERING, WHICHEVER IS LATER, AND SHALL LAST FOR THE FUNCTIONAL LIFE OF THE MARKING.
- 2.4. MARKINGS TO HAVE A REQUIREMENT OF A MINIMUM RETRO-REFLECTIVITY VALUE OF 100 MCD/M<sup>2</sup>/LX.
- 2.5. THE MINIMUM LAID THICKNESS IS 2.0mm FOR SCREENED MARKINGS AND 1.5mm FOR SPRAY APPLIED MARKINGS.
- 2.6. IN NO CASE SHALL ANY MATERIAL BE LAID MORE THAN 6mm THICK.
- 2.7. ALL DEBRIS TO BE REMOVED FROM ROAD SURFACE PRIOR TO LAYING OF MARKINGS.
3. TRAFFIC SIGNS
- 3.1. NEW TRAFFIC SIGNS TO COMPLY WITH BS EN 12899-1:2007, AND NATIONAL ANNEX, BE MANUFACTURED FROM ALUMINIUM COMPOSITE PANEL WITH CLASS R40 SIGN FACE SHEETING UNLESS STATED OTHERWISE IN THE TRAFFIC SIGN SCHEDULE.
- 3.2. DESIGN WIND-LOADING TO DETERMINE SIGN SUPPORT AND FOUNDATION DESIGN TO BE EN 12899-1:2007, AND NATIONAL ANNEX, HAS BEEN ASSESSED USING RICHMAN "WINDLOAD" SOFTWARE OR SIMILAR APPROVED SOFTWARE.
- 3.3. ALL MECHANICAL FASTENERS FOR NEW SIGNS TO BE PROCURED ONLY FROM NISS 3 APPROVED SOURCES.
- 3.4. ENSURE POSTS DO NOT PROTRUDE ABOVE SIGN EDGE.
- 3.5. ENSURE A MINIMUM OF 0.5m CLEARANCE FROM EDGE OF CARRIAGEWAY.
- 3.6. ALL EXISTING TRAFFIC SIGNS WITHIN SCHEME LIMITS ARE TO BE CLEARED DOWN.

**LEGEND:**

- PROPOSED LINING
- EXISTING LINING
- K1 KERB
- PROPOSED TRANSITION KERBS
- PROPOSED SIGN
- EXISTING SIGN
- BLISTER TACTILE FOOTWAY TYPE F4 CONSTRUCTION
- BITUMEN CONSTRUCTION OF RAISED TABLE
- CORDUROY PAVING FOOTWAY TYPE F4 CONSTRUCTION

PARKING RESTRICTIONS REMOVED	AR	RWDD	RWDD	D
TITLE REVISED TO SIMPLIFY OPTIONS	AR <th>RWDD</th> <th>RWDD</th> <th>C</th>	RWDD	RWDD	C
SCHEME REVISED BASED ON RSA 1/2 COMMENTS	CE <th>RWDD</th> <th>RWDD</th> <th>B</th>	RWDD	RWDD	B

Revision:

Rev	By	Date	Appr	Rev
1	CE	22/02/23		

Reproduced from the Ordnance Survey mapping with permission of the Controller of Her Majesty's Stationery Office. © Crown copyright. Unauthorised reproduction infringes Crown copyright and may lead to prosecution or civil proceedings. NORTHUMBRIA COUNTY COUNCIL - O.S. Licence No. 10004540 (2008)

Drawing Sheet: CONTRACT

Client: NORTHUMBRIA COUNTY COUNCIL  
COUNTY HALL, MORPETH  
NORTHUMBRIA, NE61 2EF

Job Title: GRACE DARLING CAMPUS  
NEWBIGGIN 20MPH ZONE  
PHASE 1

Drawing Title: PEDESTRIAN CROSSING AND  
PARKING RESTRICTIONS  
SHEET 3 OF 6

Scale(s): 1:200

Northumberland  
County Council

Technical Services

Drawn	Date	Checked	Approved
CE	FEB' 22	RWDD	RWDD

Drawing Number: HE203424D-00-006519-10-003

Revision: D

Drawing Number: HE203424D





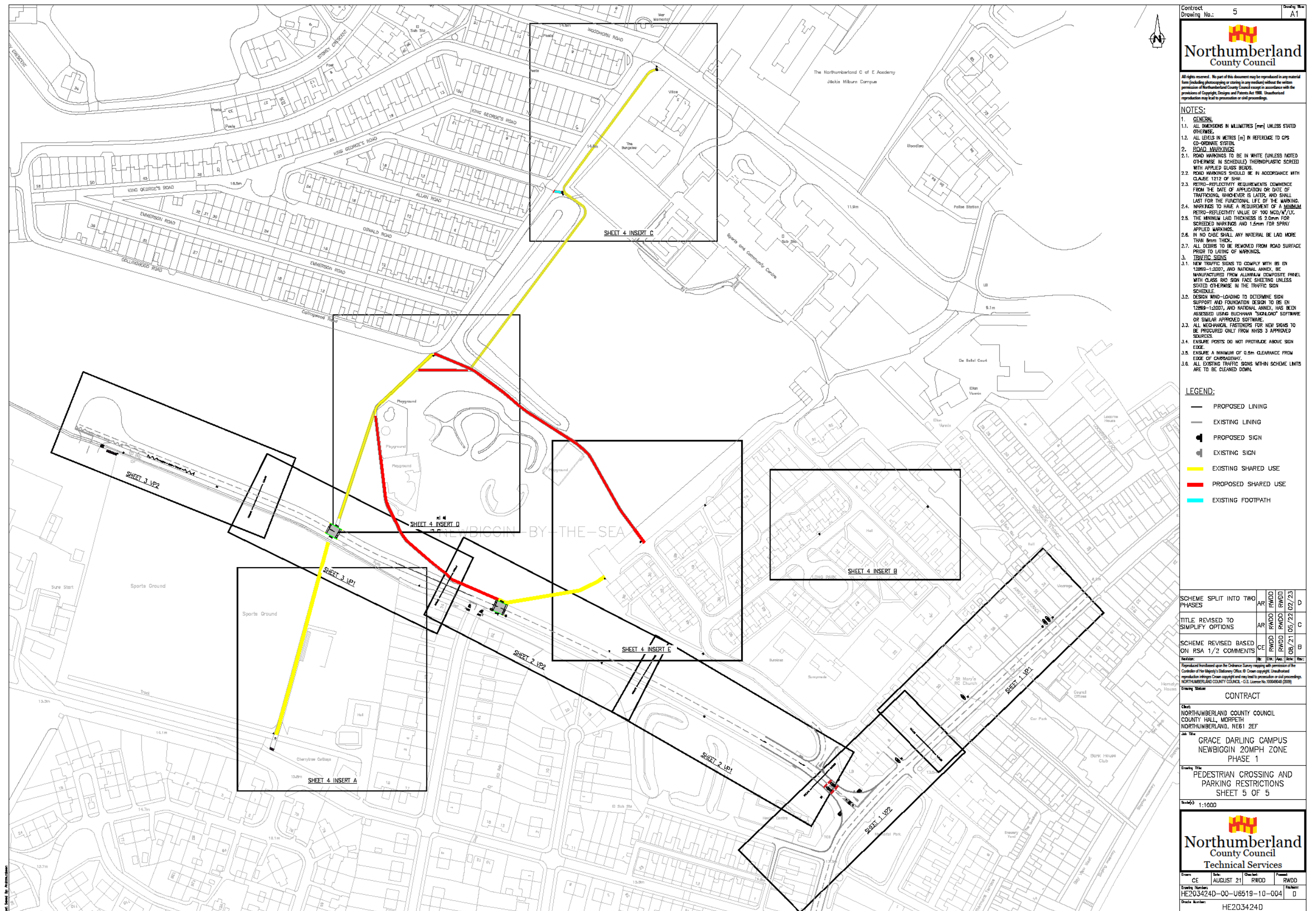

ROAD MARKINGS SCHEDULE										
REF	SCHED.	PART	ITEM	DIAG. No.	DIAGRAM	MARK (mm)	GAP (mm)	WIDTH (mm)	ROAD STUDS	USE
(A)	7	4	1	1018.1		CONTINUOUS		100	—	DOUBLE YELLOW LINES
(C)	10	2	9	1065		4300	—	1500	—	SMALL 20 ROUND
(D)	10	2	9	1065		4300	—	1500	—	SMALL 30 ROUND
(E)	—	—	—	—		TRANSVERSE		1000	—	RED SURFACE TREATMENT BAND
(F)	11	4	33	1082		VARIES		750	—	HUMP TRIANGLE
(G)	9	6	3	1003A		600	300	200	—	GIVE WAY LINES
(H)	11	4	8	1008A		600	300	100	—	GIVE WAY EXTENSION
(I)	11	4	2	1004		4000	2000	100	—	CENTRELINE
(J)	11	4	28	1057		1215	—	750	—	CYCLE SYMBOL
(K)	—	—	—	—		—	—	—	—	WALKING MAN ROAD MARKING

TO BE READ IN CONJUNCTION WITH TSP&GD 2016

TO BE READ IN CONJUNCTION WITH TSR&GD 2016

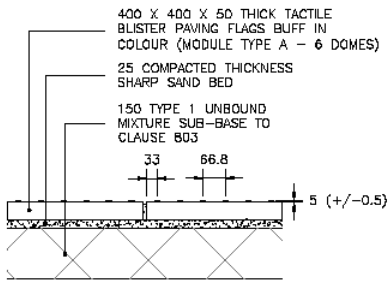

FOOTWAY TYPE F4  
PROPOSED BUFF COLOURED TACTILE BLUSTER PAVING  
SCALE 1/10

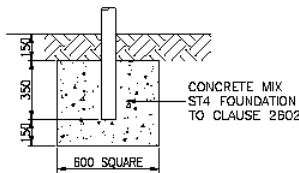



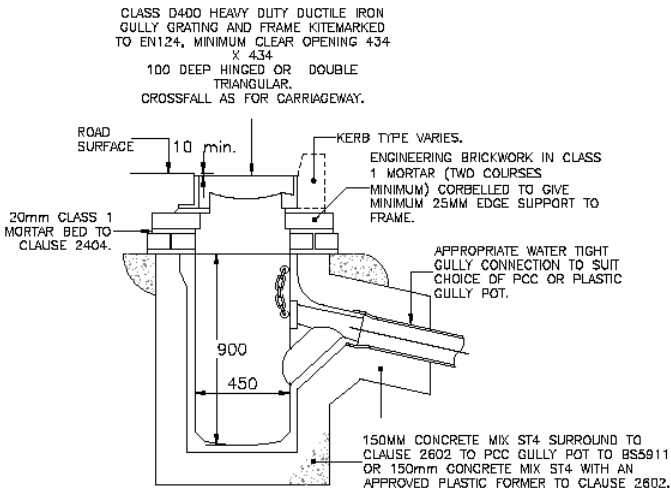







SIGN POST FOUNDATION DETAIL



CHANNEL GULLY TYPE G1

SCALE: NTS

NEW TRAFFIC SIGNS (300 SERIES)											
REF.	TSR&GD 2016 DIAG. NO.	"X" HEIGHT (mm)	LEGEND	No. OFF	SURFACE	APPROX. SIZE (m)	POSTS / SIGNS			MOUNT HEIGHT (m)	REMARKS
							DIA. (mm)	LENGTH (m)	No.		
(301)	674	80		1	CLASS RA2	0.6 x 1.05	—	—	—	2.1	TO BE MOUNTED ON EXISTING LIGHTING COLUMN.
(302)	675A	VARIES (40–50)		1	CLASS RA2	0.6 x 0.8	—	—	—	SEE REMARKS	MOUNTED ON REVERSE OF SIGN REF 301.
(303)	674	80		5	CLASS RA2	0.6 x 1.05	76	3.85	1	2.1	TO BE MOUNTED ON NEW 76mm STEEL POST.
(304)	675A	VARIES (40–50)		5	CLASS RA2	0.6 x 0.8	—	—	—	SEE REMARKS	MOUNTED ON REVERSE OF SIGN REF 303.
(305)	670	—		6	CLASS RA2	0.3	—	—	—	2.1	TO BE MOUNTED ON EXISTING LIGHTING COLUMN.
(306)	670	—		2	CLASS RA2	0.3	76	2.9	1	2.1	TO BE MOUNTED BACK TO BACK ON NEW 76mm DIA STEEL POST. TWO SIGNS PER POST.
(307)	670	—		2	CLASS RA2	0.3	76	2.9	1	2.1	TO BE MOUNTED ON NEW 76mm DIA STEEL POST (ALONG ONE-WAY STREETS)
(308)	956	—		6	CLASS RA2	0.3	76	2.9	1	2.3	TO BE MOUNTED AT THE REAR OF THE FOOTWAY, ORIENTATION AS PER PLAN
(309)	956	—		5	CLASS RA2	0.3	—	—	—	2.3	TO BE MOUNTED ON EXISTING POSTS OR COLUMNS ORIENTATION AS PER PLAN
(310)	545	—		1	CLASS RA2	0.74 x 0.94	76	3.35	1	2.1	SIGN MOUNTED ON NEW POST FACING TRAFFIC HEADING TOWARDS THE SCHOOL
(311)	545	—		1	CLASS RA2	0.74 x 0.94	—	—	—	2.1	SIGN MOUNTED ON EXISTING LIGHTING COLUMN FACING TRAFFIC HEADING TOWARDS THE SCHOOL

TO BE READ IN CONJUNCTION WITH TSR&GD 2016

TO BE READ IN CONJUNCTION WITH TSR&GD 2016

EXISTING TRAFFIC SIGNS TO BE RELOCATED				
REF.	LEGEND	No. OFF	APPROX. SIZE (m)	REMARKS
(101)		2	0.6 x 0.8	EXISTING SIGN TO BE SET ASIDE FOR REUSE AS A SIGN 303, STEEL POST TO REMAIN
(102)		2	0.6 x 0.8	EXISTING SIGN TO BE SET ASIDE FOR REUSE AS A SIGN 304, STEEL POST TO REMAIN

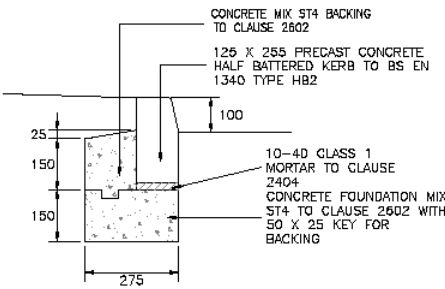

KERB TYPE K1  
100mm KERB FACE HALF BATTERED KERB  
Scale 1/10

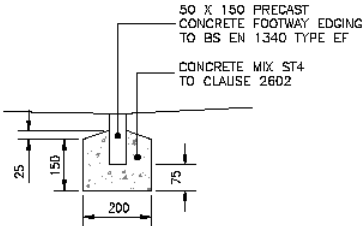

KERB TYPE K5  
FOOTWAY EDGING KERB  
Scale 1/10

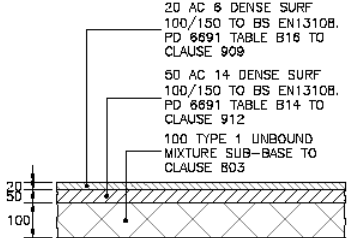

FOOTWAY TYPE F1  
FLEXIBLE CONSTRUCTION (170mm DEPTH)  
Scale 1/10

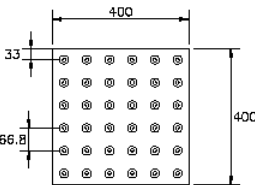

DETAIL OF TACTILE BLUSTER PAVING  
FLAG (FOR TYPE F4 PAVING)  
Scale 1/10

Contract Drawing No.: 6

Drawing No.: A1

All rights reserved. No part of this document may be reproduced in any material form (including photocopying or storing in any medium) without the written permission of Northumberland County Council except in accordance with the provisions of Copyright, Designs and Patents Act 1988. Unauthorised reproduction may lead to prosecution or civil proceedings.

NOTES:

1. GENERAL

1.1. ALL DIMENSIONS IN MILLIMETRES (mm) UNLESS STATED OTHERWISE.

1.2. ALL LEVELS IN METRES (m) IN REFERENCE TO GPS CO-ORDINATE SYSTEM.

SCHEME REVISED BASED ON RSA 1/2 COMMENTS

CE

RWDD

08/21

EB

Reproduced from the Ordnance Survey mapping with permission of the Controller of Her Majesty's Stationery Office. © Crown copyright. Unauthorised reproduction infringes Crown copyright and may lead to prosecution or civil proceedings. NORTHUMBERLAND COUNTY COUNCIL - O.S. License No. 10004548 (2008)

Drawing Status

CONTRACT

Client  
NORTHUMBERLAND COUNTY COUNCIL  
COUNTY HALL, MORPETH  
NORTHUMBERLAND, NE61 2EF

Job Title  
GRACE DARLING CAMPUS  
NEWBIGGIN  
20MPH ZONE

Drawing Title  
STANDARD DETAILS

Scale(s)  
NTS

Northumberland County Council  
Technical Services

Drawn  
CE

Date  
AUGUST 21

Checked  
RWDD

Revised  
RWDD

Drawn  
HE203424D-00-U6519-10-006

Revised  
B

Drawing Number  
HE203424D