

All rights reserved. No part of this document may be reproduced in any material form (including photocopying or storing in any medium) without the written permission of Northumberland County Council except in accordance with the provisions of Copyright, Designs and Patents Act 1988. Unauthorised reproduction may lead to prosecution or civil proceedings.

NOTES:

1. **TRAFFIC SIGNS**
 - 1.1. NEW TRAFFIC SIGNS TO COMPLY WITH BS EN 12899-1:2007, AND NATIONAL ANNEX, BE MANUFACTURED FROM ALUMINIUM COMPOSITE PANEL WITH GLASS PA2 SIGN FACE SHEETING UNLESS STATED OTHERWISE IN THE TRAFFIC SIGN SCHEDULE.
 - 1.2. DESIGN WIND-LOADING TO DETERMINE SIGN SUPPORT AND FOUNDATION DESIGN TO BS EN 12899-1:2007, AND NATIONAL ANNEX, HAS BEEN ASSESSED USING BUCHANAN "SIGNLOAD" SOFTWARE OR SIMILAR APPROVED SOFTWARE.
 - 1.3. ALL MECHANICAL FASTENERS FOR NEW SIGNS TO BE PROCURED ONLY FROM WHIS 3 APPROVED SOURCES.
 - 1.4. ENSURE POSTS DO NOT PROTRUDE ABOVE SIGN EDGE.
 - 1.5. ENSURE A MINIMUM OF 0.5m CLEARANCE FROM EDGE OF CARRIAGEWAY AND 1.2m ON HIGH SPEED DUAL CARRIAGEWAY.
 - 1.6. EXACT LOCATION OF SIGNS TO BE AGREED WITH DESIGNER ON SITE PRIOR TO COMMENCEMENT OF WORKS.
2. **ROAD MARKINGS**
 - 2.1. NEW MARKINGS TO BE IN WHITE THERMOPLASTIC SCREED WITH APPLIED GLASS BEADS.
 - 2.2. ROAD MARKINGS SHOULD BE IN ACCORDANCE WITH CLAUSE 1212 OF SHW, RETRO-REFLECTIVITY REQUIREMENTS FROM THE DATE OF APPLICATION OR DATE OF TRAFFICKING, WHICHEVER IS LATER, AND SHALL LAST FOR THE FUNCTIONAL LIFE OF THE MARKING.
 - 2.3. MARKINGS TO HAVE A REQUIREMENT OF A MINIMUM RETRO-REFLECTIVITY VALUE OF 200 MCD/M²/LX.
 - 2.4. THE MINIMUM LAD THICKNESS IS 2.0mm FOR SCREEDED MARKINGS AND 1.5mm FOR SPRAY APPLIED MARKINGS. IN NO CASE SHALL ANY MATERIAL BE LAID MORE THAN 6mm THICK.
 - 2.5. ALL HATCHED ROAD MARKINGS AND TRAFFIC ISLANDS TO BE SWEEP CLEAN OF DETRITUS MATERIAL PRIOR TO LAYING OF ANY ROAD MARKINGS.
 - 2.6. BETWEEN POINT x AND y REMOVE ALL EXISTING CARRIAGEWAY CENTRE LINE, ARROW, HATCHED AND "SLOW" ROAD MARKINGS TO ALLOW NEW ROAD MARKING LAYOUT TO BE LAID.
3. **GENERAL**
 - 3.1. THIS DRAWING TO BE READ IN CONJUNCTION WITH: HFD19545/00/A196/01/02 AND 03.
 - 3.2. ALL WORKS TO BE AGREED ON SITE PRIOR TO COMMENCEMENT.
 - 3.3. ANY QUERIES PLEASE CONTACT JOHN MATHER, COUNTY HALL, TEL No. 01670 624131.

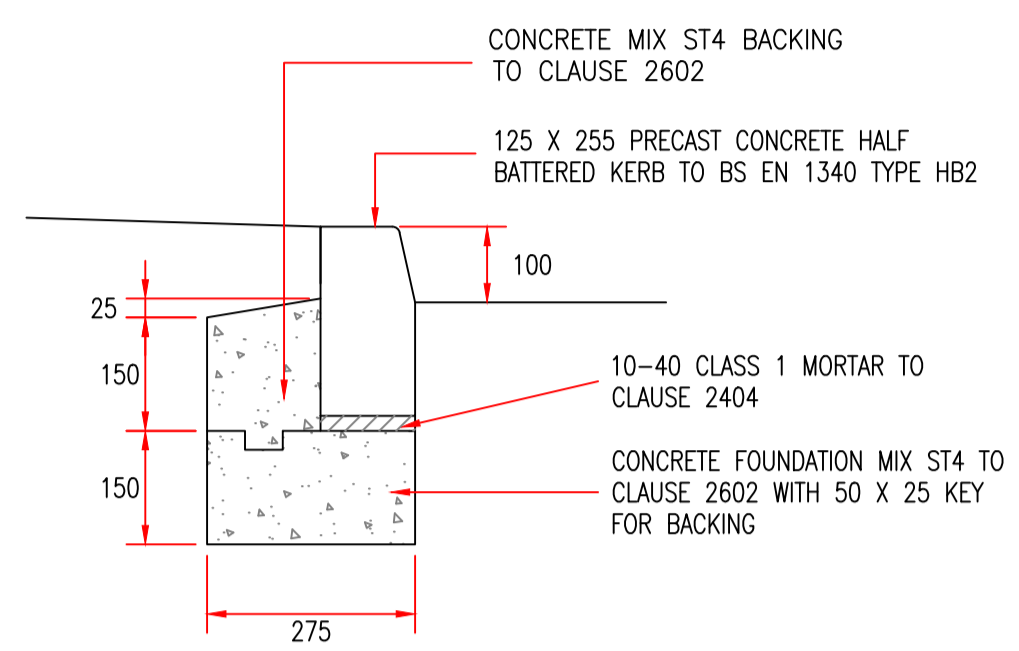

KERB TYPE K1
100mm KERB FACE HALF BATTERED KERB
SCALE 1/10

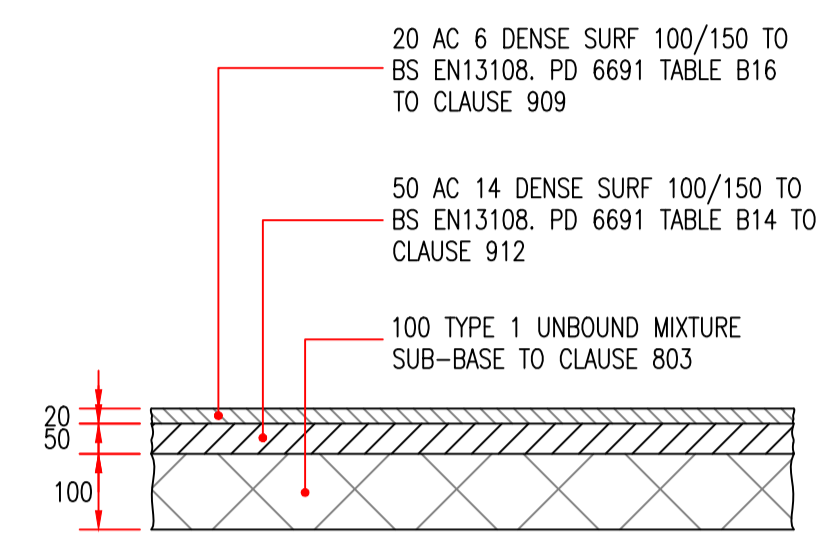

FOOTWAY TYPE F1
FLEXIBLE CONSTRUCTION (170mm DEPTH)
SCALE 1/10

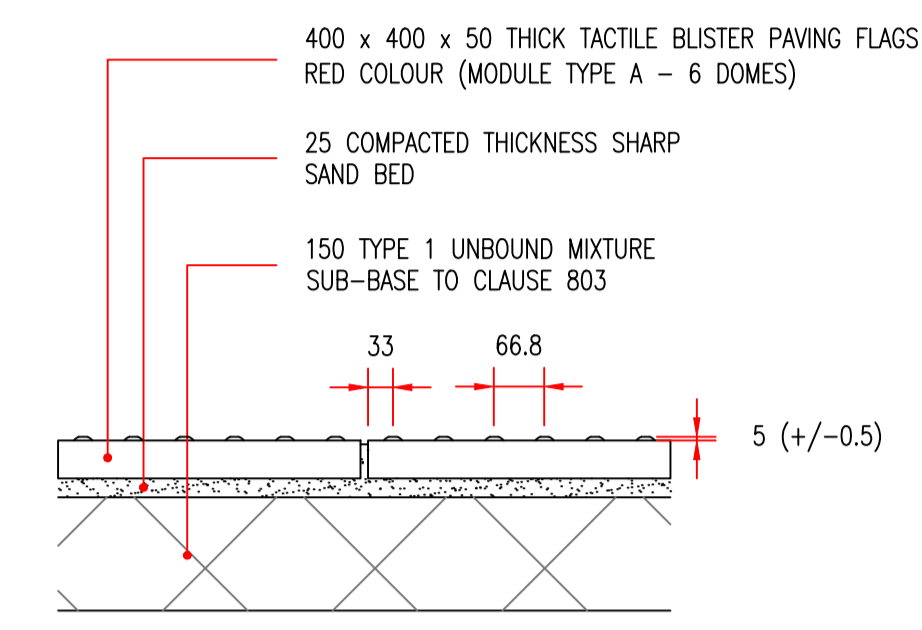

FOOTWAY TYPE F4
PROPOSED RED COLOURED TACTILE BLISTER PAVING
SCALE 1/10

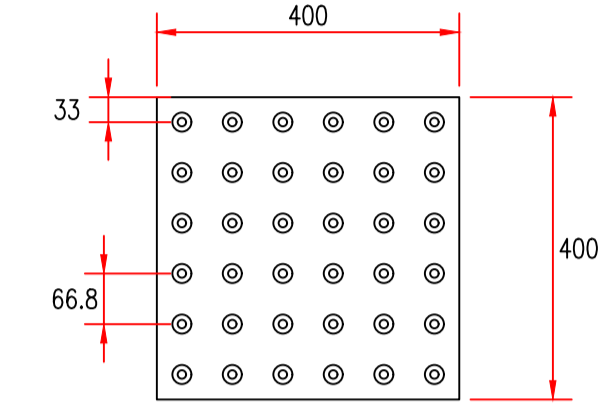

DETAIL OF RED TACTILE BLISTER PAVING FLAG (FOR TYPE F4 PAVING)
SCALE 1/10

Missing or invalid reference file: .\Detail A -Speed Cushions.pdf sheet: 1

DETAIL 'A'
ROSEHILL HIGHWAYS LTD
1.75m WIDE TWO PIECE SPEED CUSHIONS
SCALE 1/20

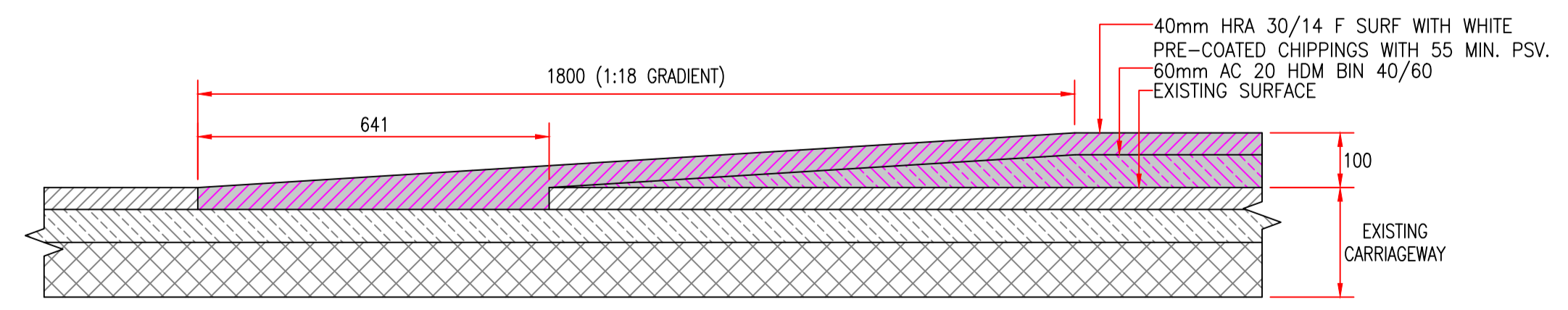

RAISED TABLE/EXISTING CARRIAGEWAY INTERFACE DETAIL
SCALE 1/10

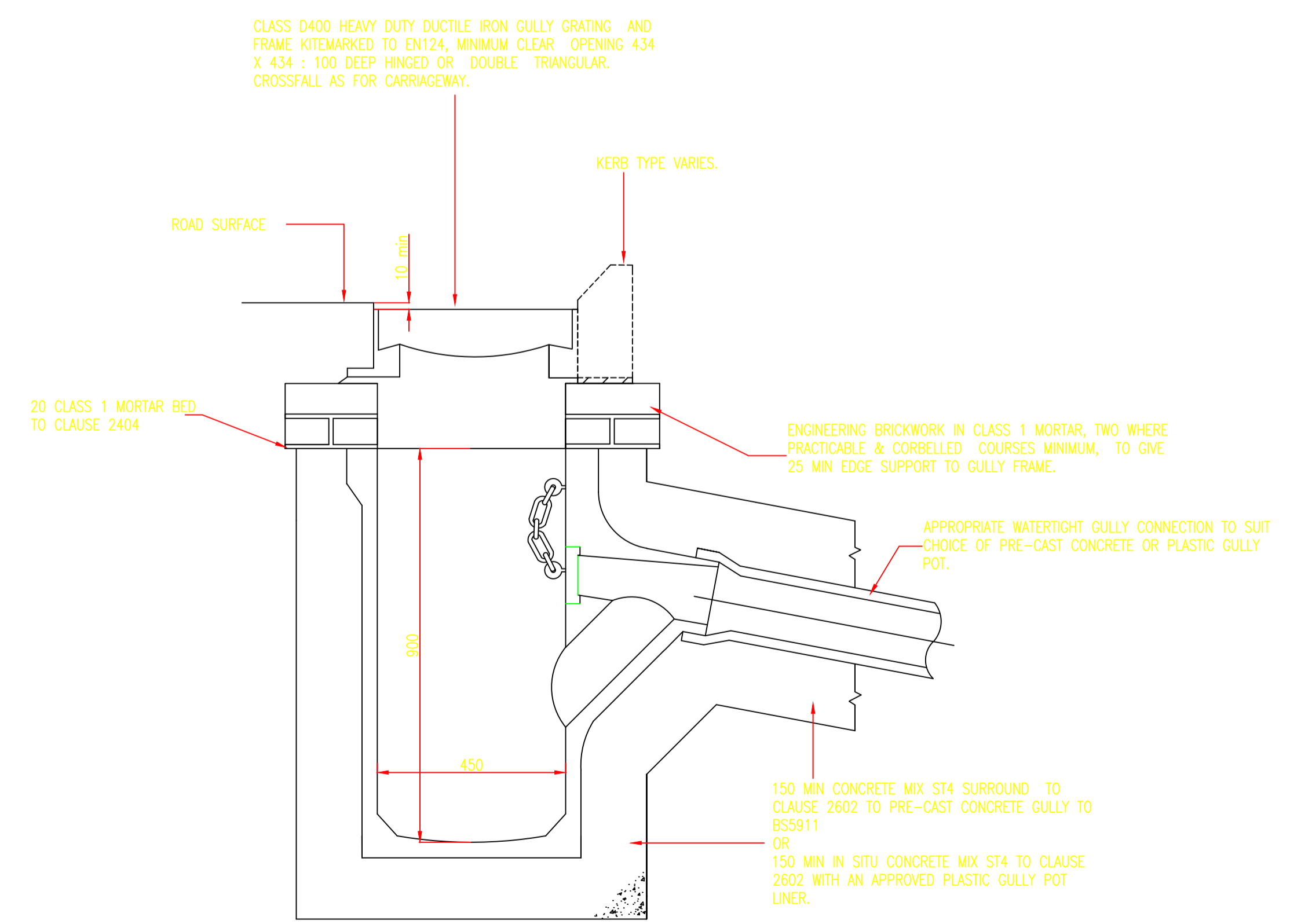

CHANNEL GULLY TYPE G1
SCALE 1/10

Revision	By	CHK	App.	Date	Rev.

Reproduced from based upon the Ordnance Survey mapping with permission of the Controller of Her Majesty's Stationery Office. Crown copyright. Unauthorised reproduction infringes Crown copyright and may lead to prosecution or civil proceedings. NORTHUMBERLAND COUNTY COUNCIL - O.S. License No 100049048 (2009)

CONSTRUCTION

Client:
NORTHUMBERLAND COUNTY COUNCIL
COUNTY HALL, MORPETH
NORTHUMBERLAND, NE61 2EF

Job Title:
A196 NORTH SEATON ROAD
ASHINGTON

Drawing Title:
STANDARD DETAILS
(Sheet 3 of 3)

Scale(s): 1:250 & AS SHOWN

Drawn	Date	Checked	Passed
SY	SEP'20	KB	GM

Drawing Number: HFD19545/06/A196/01/03
Revision:
Oracle Number: HFD19545