



Northumberland County Council

RECORD OF DECISION TAKEN BY SERVICE DIRECTOR - LOCAL SERVICES

Paul Jones

**Proposed Parking Restrictions,
U9553 Bassington Avenue, Cramlington**

18th September 2018

Cabinet Member: Councillor Glen Sanderson

Purpose of Report

To consider the introduction of parking restrictions on Bassington Avenue, Cramlington.

Recommendations

Taking into account comments made during the consultation process, it is recommended that the following restrictions are introduced on Bassington Avenue, Cramlington:

No Waiting at Any Time restrictions (Double yellow Lines), No Waiting between 08:00 - 18:00 restrictions (Single Yellow Lines) and HGV directional signage with a change to the junction priority.

Link to Corporate Plan

Living - "We want you to feel safe, healthy and cared for"
Enjoying - "We want you to love where you live"

Key Issues

1. Residents have raised safety concerns for both pedestrians and motorists caused by parked cars on Bassington Avenue, Cramlington.
2. The scheme is to be funded by Councillor Flux, through his Members Local Improvement Allowance.

Delegated decisions

Background

1. Residents contacted their local Ward member with concerns regarding safety issues for both pedestrians and motorists caused by parked cars on Bassington Avenue, Cramlington.
2. Indiscriminate parking on the road is making it difficult for residents to negotiate this road safely.
3. After meeting with Councillor Flux, officers proposed that "No Waiting at Any Time" restrictions be introduced in order to alleviate these concerns.
4. A consultation letter was sent to 28 statutory consultees on the proposed parking restrictions. A copy of the consultation letter and plan are attached in Appendix A.
5. 5 responses were received as a result of the consultation letter, with 4 in favour 0 against and 1 neither for nor against the proposal. A summary of the responses is attached as Appendix B.
6. A number of consultees recommended that HGV's should use a different route, so they do not come past the new housing estate and also that timed parking restrictions (single yellow lines) be introduced to allow residents to park in the evening on Bassington Avenue. This has been included in the scheme.
7. The results of the consultation were discussed with Councillor Flux, who agreed that the consultees' suggestions should be taken into account and the restrictions be revised as shown on the attached plan Appendix C.
8. The scheme is supported by Councillor Flux and funded through his Members' Local Improvement Allocation.

Delegated decisions

Implications Arising out of the Report

| | |
|---|--|
| Policy | None |
| Finance and value for money | Funded through the Members Local Improvement allocation for Councillor Flux |
| Legal | Preparation of Traffic Regulation Orders (TRO) |
| Procurement | |
| Human Resources | None |
| Property | None |
| Equalities (Impact Assessment attached) Yes <input type="checkbox"/> No <input type="checkbox"/> N/A <input type="checkbox"/> | None |
| Risk Assessment | |
| Crime & Disorder | Traffic safety concerns i.e. Obstruction / congestion of the highway |
| Customer Consideration | Scheme is anticipated to improve road safety for pedestrians, residents and road users in the area |
| Carbon reduction | |
| Wards | Cramlington West |

Background papers:

File ref: HO186420-02

Appendix Index

- Appendix A - Consultation Letter and Plan
- Appendix B - Consultation Responses
- Appendix C - Scheme Plan

Delegated decisions

Report sign off.

Authors must ensure that relevant officers and members have agreed the content of the report:

| | initials |
|--------------------------|----------|
| Finance Officer | |
| Monitoring Officer/Legal | |
| Human Resources | |
| Procurement | |
| I.T. | |
| Director | |
| Portfolio Holder(s) | |

Author and Contact Details

Report Author **Sarah Hudson Technical Assistant (M.S.S)**
(01670) 624130
Sarah.Hudson@northumberland.gov.uk



**Northumberland
County Council**

I
The Occupier

Your ref:
Our ref: 2017/055_02
Enquiries to: Andy Walker
Email: Highwaysprogramme@northumberland.gov.uk
Tel direct: 0345 600 6400
Date: 20th June 2018

Dear Sir/Madam,

**Proposed Parking Restrictions,
Bassington Avenue, Cramlington**

Road users have raised concerns with the Police, Cramlington Town Council and County Councillor Flux, regarding vehicles being parked on Bassington Avenue causing safety issues for both pedestrians and motorists. Councillor Flux has therefore requested that "No Waiting at Any Time" restrictions be introduced at this location in order to alleviate these concerns.

I am therefore writing in accordance with Regulation 5 of the Local Authorities Traffic Orders (Procedure) (England and Wales) Regulations 1996 (as amended) to formally ask for your comments on the proposal to introduce No Waiting At Any Time Restrictions on U9553 Bassington Avenue, Cramlington as shown on the attached plan.

If you have any comments or observations regarding this proposal please can you email or write to Highways Programme, County Hall, Morpeth, NE61 2EF before the 20th July 2018.

Yours faithfully

Andy Walker
Technical Assistant (Members Small Schemes)



Andy Walker, Technical Assistant, Highways Programme
County Hall, Morpeth, Northumberland, NE61 2EF



Delegated decisions

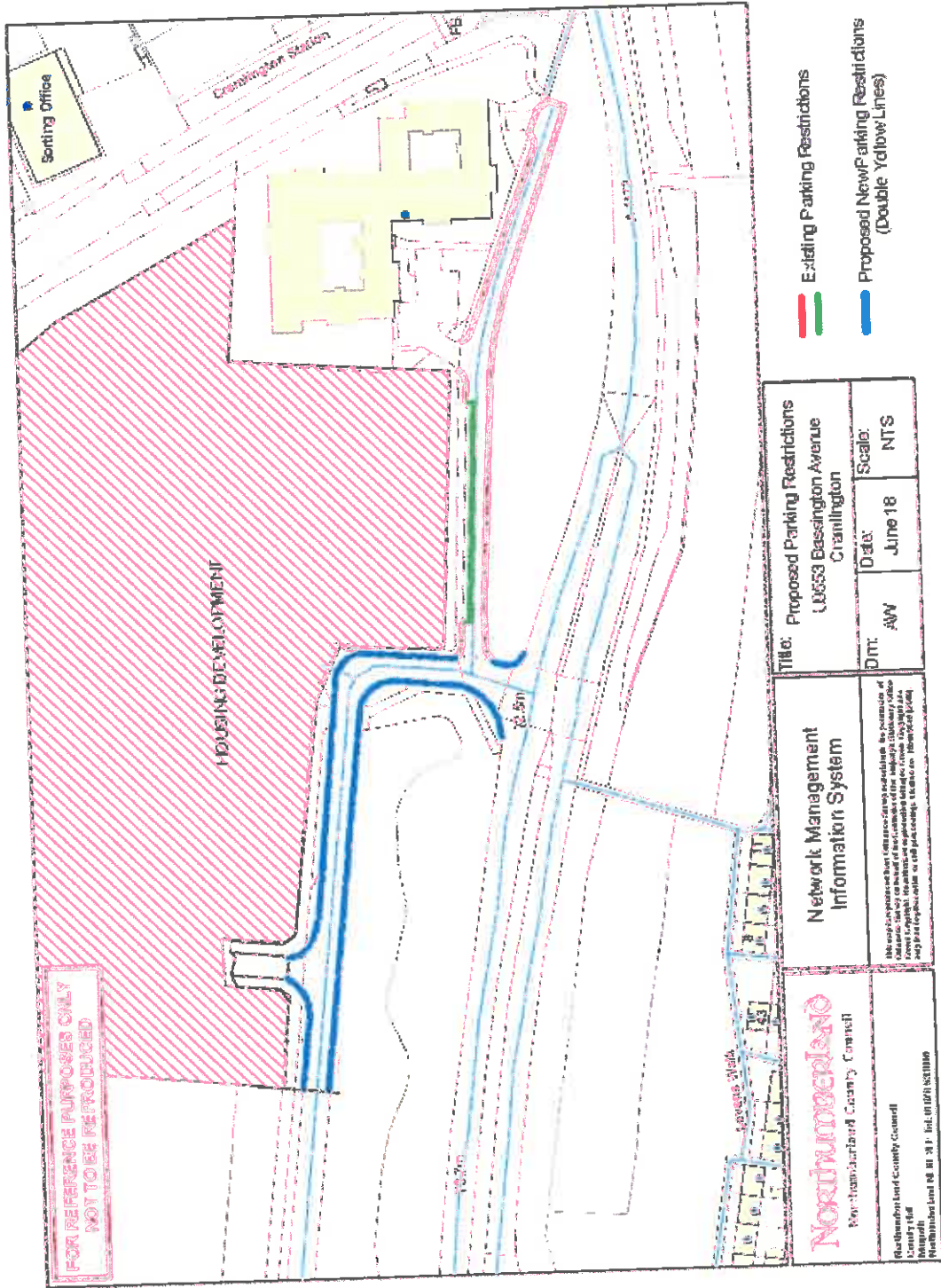

FOR REFERENCE PURPOSES ONLY
NOT TO BE REPRODUCED

Northumberland
Northumberland County Council
Northumberland County Council
Mansfield
Northumberland NE1 2J Tel: 01661 450100

Network Management Information System

This plan is prepared for the use of the Council and its officers. It is not to be used for any other purpose. The Council is not responsible for any loss or damage caused by the use of this plan. The Council is not responsible for any loss or damage caused by the use of this plan.

| | | |
|---|---------------|------------|
| Title: Proposed Parking Restrictions 53 Basington Avenue Crainlington | | Scale: NTS |
| Dt: AW | Date: June 18 | NTS |

- Existing Parking Restrictions
- Proposed New Parking Restrictions (Double Yellow Lines)

Delegated decisions

Appendix B

| FOR | AGAINST | REMARKS |
|-----|---------|--|
| 1 | | <p style="text-align: center;"><u>Other Relevant Comments</u></p> <p>I have seen the proposals for the parking restrictions at Bassington Manor they look exactly what we want have been campaigning for as it is dangerous with poor visibility coming in and out of the estate and access is also very poor off the dual carriageway would also appreciate it if someone could look into HGVs accessing and exiting from a different entrance as we got stuck across the dual carriageway the other day due to HGVs coming in and out past the estate which is not ideal.</p> |
| 1 | | <p>I'm writing you regarding the document shared by Barry Flux "Proposed parking restrictions Bassington Avenue, Cramlington". I live in Bassington Manor housing development and I'm very happy with the proposal of double yellow line at Bassington Avenue. With our development built the traffic of that road is quite constant and it has become a problem for the neighbours to get all the cars of commuters taking the train and leaving them all day parked. The road has been converted into a single line road and it's especially worrying when we have heavy vehicles using it due to the industrial estate. In regards with the area that is restricted parking right now next to the Care Home (green line in the chart). I really don't understand the restriction because there is no way to track if a vehicle has been parked for more than 4 hours. I think it will be good to have that area as parking permit only for the neighbours of Bassington Manor and also visitors/workers of the Care Home. But that is just my personal opinion. If you decide to convert it to a free parking area, again the problem will be that cars will be parked all day because commuters will use it as a train station parking and people that visit the care home won't be able to park. I only wanted to express my thoughts about the plan as a neighbour of that area.</p> |
| | 1 | <p>Thank you for your correspondence dated 20th June 2018 in which you invite us to offer our comments on the above proposal. I would inform you that as an Emergency Service we may be required to use the above road(s) for access and egress in the event of being activated to attend an emergency call, or to convey patients to hospital for out patient appointments. I would thank you for your consultation on this matter and offer our support for the on-going road safety programme.</p> |
| 1 | | <p>I would be in support of this introduction as there has been a noticeable increase in vehicles parking in this location and access to the A1172 is busier due to the introduction of the new housing development.</p> |

Delegated decisions

| | |
|--------------|--|
| | <p>The front of my home looks directly onto Bassington Avenue. However my address is actually Tavern Close. Whilst searching yesterday for a planning application I found the following letter:</p> <p>'Road users have raised concerns with the Police, Craxington Town Council and County Councillor Flux, regarding vehicles being parked on Bassington Avenue causing safety issues for both pedestrians and motorists. Councillor Flux has therefore requested that "No Waiting at Any Time" restrictions be introduced at this location in order to alleviate these concerns. I am therefore writing in accordance with Regulation 5 of the Local Authorities Traffic Orders (Procedure) (England and Wales) Regulations 1996 (as amended) to formally ask for your comments on the proposal to introduce No Waiting At Any Time Restrictions on U9533 Bassington Avenue, Craxington as shown on the attached plan.</p> <p>If you have any comments or observations regarding this proposal please can you email or write to Highways Programme, County Hall, Morpeth NE51 2EP before the 20th July 2019?</p> <p>Please note I never received a letter and I have not seen any placard along the road to notify local residents of this consultation. My neighbours do not appear to be aware of the consultation and I wondered whether any residents on Tavern Close and Brother Way whose homes are next to Bassington Avenue have been consulted?</p> <p>I would object to the no waiting at any time proposition although I do agree that between the hours of 8-4pm the excessive parking by commuters who use the train station obstructs the view coming out of the estate to drivers, and this coupled with lorries leaving and entering the industrial estate makes this section of Bassington Avenue dangerous. The lorries have also damaged the verge and grass on the left hand corner from the main road opposite my home from repeatedly curbing the corner off. Bollards have now been placed there however since these were added and the path was replaced (was this by the council or by the builder?) there has been no landscaping or grass sown and the area looks untidy and damaged.</p> <p>I believe I have seen estate plans for the Bassington Manor development which actually had visitor parking marked on the main road in the area where the junction was closed. At the weekend there is usually a few residents cars and vans parked on the Bassington Avenue and this does not cause a hazard. I would be concerned that if visitors and residents could not park on Bassington Avenue this would increase hazardous parking on the estate and my own driveway (ahmed with neighbours) would be frequently blocked as visitors in neighbouring homes have had to be asked to move their cars, as they park across the drive.</p> <p>Also, when the junction into the estate was closed off no drainage was added at that corner and the road floods (when it rains).</p> <p>Could you also let me know when the council plans to adopt the highways in the estate? The tarmacking around the lampposts closest to my home is not complete.</p> |
| | <p>In relation to the consultation I would propose: 1. That there is a parking restriction on this section of Bassington Avenue between the hours of 8am and 4pm, and double yellow lines are placed around the junctions. Similar to the section close to Craxington House. Alternatively residents permits could be provided. 2. That there is a restriction or signage asking lorries/HGV's etc. to leave the industrial estate using alternative exits or the exit closest to the factory unit at the top of Bassington Avenue. The current industrial development on Bassington Avenue for some unknown reason actually has a sign which directs lorries leaving the site to the left, towards the house's rather than to the larger, safer, and quieter junction to the right. I've repeatedly seen companies who are based in the central area of the industrial estate leave via the junction opposite my home when the Hub way roundabout or Nelson Drive/A1171 roundabout seems a more obvious choice (I wonder if sat navs direct them along Bassington Drive?) Finally I wondered how the \$100 money from the sale of houses on the estate was spent? There is no play area for local children and the only green space close to the estate directly opens out on the dual carriageway. Is there any plan to provide green space/play areas for the children?</p> |
| <p>1</p> | <p>2. That there is a restriction or signage asking lorries/HGV's etc. to leave the industrial estate using alternative exits or the exit closest to the factory unit at the top of Bassington Avenue. The current industrial development on Bassington Avenue for some unknown reason actually has a sign which directs lorries leaving the site to the left, towards the house's rather than to the larger, safer, and quieter junction to the right. I've repeatedly seen companies who are based in the central area of the industrial estate leave via the junction opposite my home when the Hub way roundabout or Nelson Drive/A1171 roundabout seems a more obvious choice (I wonder if sat navs direct them along Bassington Drive?)</p> |
| <p>4 0 1</p> | |

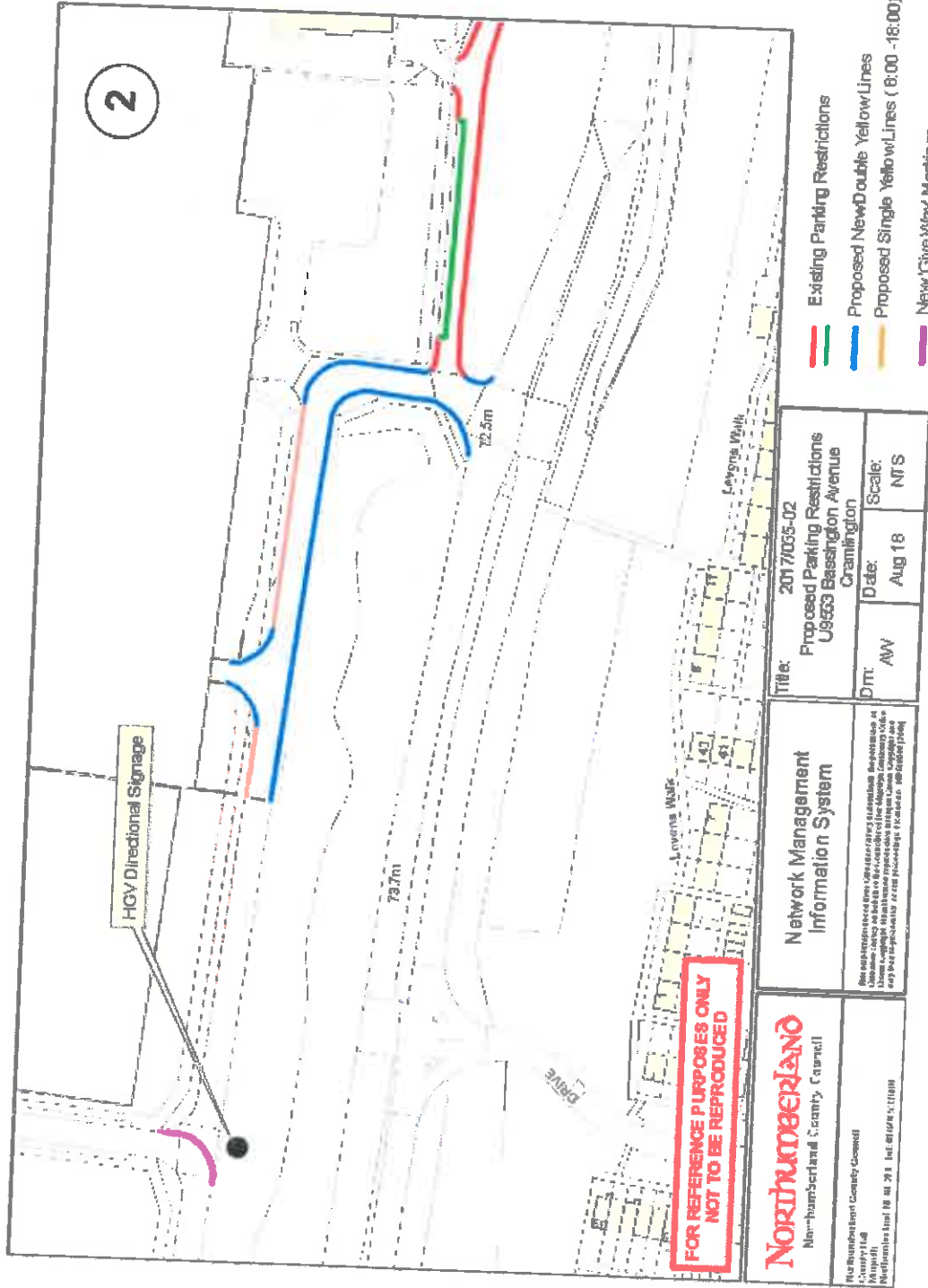

Delegated decisions

DECISION TAKEN

Title of Officer:

Service Director, Local Services

Subject:

Proposed No Waiting at Any Time restrictions (Double yellow Lines), No Waiting between 08:00 - 18:00 restrictions (Single Yellow Lines) and HGV directional signage with a change to the junction priority be introduced on Bassington Avenue, Cramlington.

Consultation

For: 4
Against: 0
Neutral: 1

Decision Taken:

To introduce the parking restrictions as proposed

Signature of Director

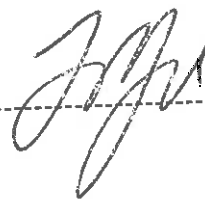

Date

5/10/18