



# **Northumberland**

## **County Council**

### **RECORD OF DECISION TAKEN BY SERVICE DIRECTOR - LOCAL SERVICES**

**Paul Jones - Service Director - Local Services**

---

**PROPOSED 40MPH SPEED LIMIT, A6105 DUNS ROAD, BERWICK**

**Cabinet Member: Councillor Glen Sanderson**

---

#### **Purpose of Report**

To consider a proposal to provide a 40mph speed limit on a section of the A6105 'Duns Road' Berwick upon Tweed.

#### **Recommendations**

It is recommended that the proposed 40mph speed limit should be implemented.

#### **Link to Corporate Plan**

Living - "We want you to feel safe, healthy and cared for"

Enjoying - "We want you to love where you live"

#### **Key Issues**

1. The County Council has received concerns from residents via the local ward member over traffic speeds on a section of the A6105 Duns Road.

## Delegated decisions

### Background

1. The County Council has received concerns from residents via the local ward member over traffic speeds on a section of the A6105 Duns Road.
2. The A6105 runs from Berwick in a northwesterly direction to the Scottish border and on to Duns.
3. The section of road in question runs from the junction with the A1 Berwick bypass for approximately 450m to just beyond the junction with Halidon Hill. The road slopes down from Halidon Hill to the A1 and includes a bend at the Halidon Hill junction. Currently it is subject to the national speed limit of 60mph. Its location is shown in Figure 1, below.

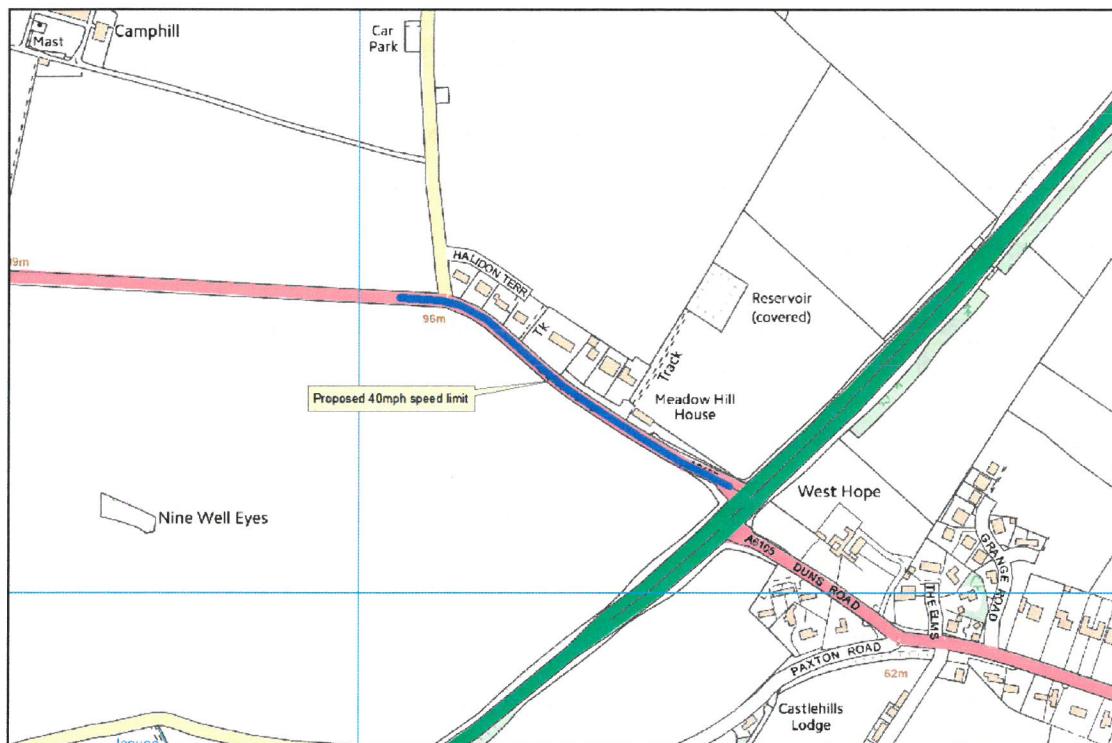

**Fig. 1. Location Plan**

4. The road is fronted by residential properties at 'Meadow Hill' and 'Halidon Terrace'. In addition, residential development has recently taken place at Camphill, which is accessed via Halidon Hill.
5. As well as residential traffic, Halidon Hill is subject to visitor traffic accessing the historic battlefield site which is signed by brown and white tourism signs, and also provides a popular viewpoint.
6. Residents have cited concerns over traffic speeds, both going uphill as vehicles accelerate having left the A1, and downhill.

## Delegated decisions

---

7. There has been one slight injury accident near the A1 junction, however, residents also cite several examples of damage-only accidents, particularly at the bend in the road at the Halidon Hill junction where vehicles have left the road, some of which have required a police presence.
8. Guidance on speed limits states that 40 mph speed limits can be applied to rural roads where there are bends, junctions or accesses, substantial development or where there are vulnerable road users. This section of Duns Road is considered to meet these criteria.
9. Residents and statutory consultees were therefore consulted on a proposal to provide a 40mph speed limit. The consultation plan is the same as Figure 1, above.
10. Ten responses were received, 9 of which were from residents. The results were:
  - 9 For (90%)
  - 1 Neutral (10%)
  - 0 Against
11. The neutral response was from the Ambulance Service. A copy of the responses is shown in Appendix A.
12. As well as speed and the accidents referred to above, residents also highlighted the difficulty getting in and out of the Halidon Hill junction and concerns over the safety of pedestrians using the footway.
13. The local ward member is in favour of the proposal.
14. It is therefore recommended that the proposed 40mph speed limit should be implemented.

## Delegated decisions

---

### Implications Arising out of the Report

<b>Policy</b>	
<b>Finance and value for money</b>	The proposal will be funded by the Traffic Management element of the LTP programme.
<b>Legal</b>	Motorists will be required to observe the speed limit.
<b>Procurement</b>	None
<b>Human Resources</b>	None
<b>Property</b>	None
<b>Equalities</b> (Impact Assessment attached) Yes <input type="checkbox"/> No <input type="checkbox"/> N/A <input type="checkbox"/>	None
<b>Risk Assessment</b>	None
<b>Crime &amp; Disorder</b>	None
<b>Customer Consideration</b>	Residents and statutory consultees have been consulted.
<b>Carbon reduction</b>	None
<b>Wards</b>	Berwick North

### Background papers:

File ref: HE185325

## **Delegated decisions**

---

### **Report sign off.**

***Authors must ensure that relevant officers and members have agreed the content of the report:***

	initials
Finance Officer	n/a
Monitoring Officer/Legal	n/a
Human Resources	n/a
Procurement	n/a
I.T.	n/a
Director	PJ
Portfolio Holder(s)	GS

### **Author and Contact Details**

---

Report Author     ***Richard McKenzie – Senior Programmes Officer***  
(01670) 624099  
[Richard.Mckenzie@northumberland.gov.uk](mailto:Richard.Mckenzie@northumberland.gov.uk)

## Delegated decisions

### Appendix A Consultation Responses

F O R	A G A I N S T R	N E I T H R	
			<b>Other Relevant Comments</b>
1			This section of the road has had many accidents over the years. Traffic speeds down a long straight from Duns and then the sharp bend at the Halidon Hill turning causes cars to loose control at speed. I would prefer the speed limit to be 30mph but am unsure how the limit could be enforced.
		1	Thank you for your correspondence dated 17th May 2018 in which you invite us to offer our comments on the above proposal. I would inform you that as an Emergency Service we may be required to use the above road(s) for access and egress in the event of being activated to attend an emergency call, or to convey patients to hospital for out-patient appointments. I would thank you for your consultation on this matter and offer our support for the on-going road safety programme.
1			The pathway in places has become very narrow. Debris needs to be cleared off path and the hedge cut further back so that pedestrians do not have to walk out into the road.
1			Hopefully this will slow down the reckless and inconsiderate drivers on this section of Duns Road. Several accidents in the last year show the need for this. I feel very strongly on this matter.
1			I believe a reduction to be essential having observed the remains of several minor collisions and two requiring police/ambulance attendance and also one incidence of a vehicle leaving the road, all in less than one year. Add to this the popularity of the road with the local midfield car fraternity and motorcyclists who think they are on a race track. Can the old signs for new road junction and no right turn be removed as the junction has now existed many years and redundant signage can confuse motorists.
1			30mph would be even better
1			I would welcome a speed limit of 30mph on this stretch as when I am waiting to turn first right, after having left the A1 very often I have heard the screech of brakes behind me as traffic is traveling too fast. Also, trying to exit at this junction can be perilous with traffic travelling too fast towards the A1 junction. Furthermore, during icy conditions I need extra time to access the Duns Road from camphiland on my return journey home more time is needed to cross traffic to climb Halidon Hill.
1			<p>My wife and I are delighted to hear of the proposed speed restrictions along part of the A6105, therefore we support the Council's proposal, in fact we really wish the speed limit could be reduced even further.</p> <p>We have lived at Halidon Terrace for almost three years and are amazed at the speed that vehicles travel in either direction between the A1 and Halidon Hill junction.</p> <p>We are aware from our neighbours there have been several accidents over the years where vehicles have taken the bend at Halidon Hill junction too fast, mounted the footway and crashed into our neighbours hedge. It can be quite frightening walking along this very narrow footway with vehicles passing within inches of you, even more unpleasant when it's wet.</p> <p>In addition, pulling into or out of Halidon Hill can be hazardous when driving, particularly when waiting for a gap in the traffic on the blind bend and with vehicles coming up behind at speed, we are always waiting for the inevitable collision to occur.</p> <p>During times of rain, surface water cascades down Halidon Hill where there are no surface water gullies and flows across the A6105, we are always concerned that vehicles could aquaplane and lose control. In winter, this water sometimes freezes making an additional hazard.</p> <p>The hot rolled asphalt road surface is also particularly noisy when vehicles pass by our properties, they often accelerate hard along this section of carriageway aiding noise pollution, not least the 'boy racers' who regularly frequent the view point at Halidon Hill, it can be very unpleasant for us as our house are so close to the road.</p> <p>We do hope that something will be done to reduce the traffic speed so as to make our lives more bearable and improve road safety.</p>
1			I welcome the suggestion of changing the speed limit to 40mph. It is a dangerous front of the road and there have been a few accidents. I often see pedestrians walking along the pavement which is too narrow. I think consideration should be given to maintaining the pavement which seems to have become narrow due to overgrown vegetation
1			Unsure how this will be enforced. We have a disabled child who we take in the car, we leave Meadow Hill onto the road and the amount of times idiots have had to slam the brakes on is ridiculous. Also how about putting mirrors on the road from Meadow Hill and Halidon Hill road ends, would help a lot.
9	0	1	

## DECISION TAKEN

**Title of Officer(s) and Portfolio  
Holder (where appropriate):**

Paul Jones - Service Director - Local Services

**Subject:**

**PROPOSED 40MPH SPEED LIMIT, A6105 DUNS  
ROAD, BERWICK**

**Consultation**

- 9 For (90%)
- 1 Neutral (10%)
- 0 Against

**Decision Taken:**

The proposed 40mph speed limit should be implemented.

Signature of Director/  
officer/Portfolio Holder where  
appropriate)\*



**Date**



\* delete as appropriate

