



Northumberland County Council

**RECORD OF DECISION TAKEN BY
ACTING DIRECTOR OF LOCAL SERVICES AND HOUSING**

Paul Jones

**Proposed No Waiting & Loading at Any Time Restrictions,
West End Place, Tweedmouth**

25th November 2016

Purpose of Report

To consider the results of the public consultation exercise, regarding proposed No Waiting at any time restrictions at the junction of West End Place and West End Road, Tweedmouth.

Recommendations

It is recommended that the following, 'No Waiting and Loading at any Time' restriction (double yellow lines) be introduced to the junction of U109 West End Place and West End Road, Tweedmouth.

Key Issues

1. This area has been subject to indiscriminate parking over a period of time, causing an obstruction and traffic safety concerns.
2. The Scheme is funded and supported by Councillor James Smith

Background

1. Concerns have been identified to Councillor Smith by residents of West End Road, Tweedmouth on a number of occasions with regard to the indiscriminate parking causing safety concerns in the area.
2. Proposed introduction of a No Waiting and Loading at Any Time restriction (double yellow lines) in West End Road and West End Place, Tweedmouth.

3. It is anticipated that this would help improve the sight lines at the junction and encourage residents to park a safe distance from the corner of West End Place.
4. It is also anticipated that the traffic flow will be improved by restricting parking adjacent to the bus stop.

Consultation

1. These proposals were the subject of a consultation exercise, conducted on the 29th June 2016. This involved the delivery of a consultation letter to 21 residents and 25 statutory consultees, including the emergency services and various disabled and transport associations/organisations. A plan showing the proposals is attached together with a copy of the consultation letter (see Appendix A).
2. The consultation exercise ended on 20th July 2016 and responses were received from 4 consultees, with 2 in favour, 1 against and 1 neither for nor against the proposal. A summary of the responses is attached as Appendix B.
3. Councillor Smith was notified of the results of the consultation.
4. There were a number of useful suggestions and observations provided as a result of the consultation. Following discussions between Councillor Smith and Officers, a revision was proposed, attached as Appendix C. Councillor Smith confirms he wishes to proceed with a revised version of the proposal, this will be funded through his allocation in the Member's Local Improvements Programme.

Recommendations

1. It is recommended that the revised proposal as detailed in Appendix C should proceed. A further consultation was not deemed to be required as the revision takes into consideration the comments and observations provided within the original consultation.
2. The Council has the power to hold a public inquiry before making any traffic regulation order. Such an inquiry might enable disputed evidence to be tested under cross-examination and the need for an order to be critically examined by an independent inspector. In this particular case, officers believe that the extensive consultation process and involvement with interested parties, means that such an inquiry is unlikely to bring any fresh information to light and it is therefore recommended that an inquiry is not held.

File References

S:\Highways\PROJECT\16\HO16 MEMBERS
SCHEMES\HO166121_TWEEDMOUTH_West End Palce_SMITH

Appendix Index

Appendix A - Consultation 1 -Copy of Consultation Letter
Appendix B - Consultation 1 - Summary of Responses
Appendix C – Revised Parking Restrictions

Implications Arising out of the Report

Policy	None
Finance and value for money	Funded through the Member's Local Improvement Programme allocation for Councillor Jim Smith
Legal	
Procurement	
Human Resources	None
Property	None
Equalities (Impact Assessment attached) Yes <input type="checkbox"/> No <input type="checkbox"/> N/A <input type="checkbox"/>	None
Risk Assessment	Introduction of no waiting and loading at any time restriction
Crime & Disorder	Traffic safety concerns i.e. obstruction
Customer Consideration	Scheme is anticipated to improve road safety and traffic flow in the area
Carbon reduction	
Wards	Berwick East

Background papers:

None

Report sign off.

Authors must ensure that relevant officers and members have agreed the content of the report:

	initials
Finance Officer	
Monitoring Officer/Legal	
Human Resources	
Procurement	
I.T.	
Director	
Portfolio Holder(s)	

Author and Contact Details

Report Author **Terry Luck - Programmes Officer (Member Schemes)**
(01670) 622588
Terry.Luck@northumberland.gov.uk

DECISION TAKEN

Title of Officer(s) and Portfolio Holder Director of Local Services and Housing

Subject: Proposed introduction of No waiting and loading at any time restriction (revised)

Consultation

- 4 Responses
- 2 For
- 1 Against
- 1 Neither for nor against

Decision Taken: Introduce No Waiting and Loading at Any Time Restriction (revised).

Signature of Director



Date

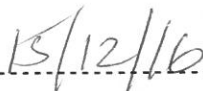

NORTHUMBERLAND

Northumberland County Council

County Hall • Morpeth • Northumberland • NE61 2EF
 • Web: www.northumberland.gov.uk

The Occupier

Our Ref: 2014/173
 Your Ref:
 Contact: Mr T Luck
 Direct Line: 01670 622588

E-mail: HighwaysProgramme@northumberland.gov.uk
 Wednesday 29th June 2016

Dear Sir/Madam

Proposed No Waiting at Any Time Restrictions, West End Place, Tweedmouth

Residents have raised concerns with County Councillor Smith, about indiscriminate parking at the junction of West End Place and West end Road, Tweedmouth which is causing a potential road safety issue. County Councillor Smith has therefore agreed to fund the introduction of No Waiting at Any Time Restrictions, subject to favourable consultation with affected residents, which should assist in improving the current situation.

I am therefore writing in accordance with Regulation 5 of the Local Authorities Traffic Orders (Procedure) (England and Wales) Regulations 1998 (as amended) to formally ask for your comments on the proposal to introduce No Waiting At Any Time Restrictions at West End Place as shown on the attached plan.

The County Council is seeking your views on the proposals and a freepost response form is attached to facilitate the consultation process. It should be stressed that this is a genuine consultation and that comments received will be carefully considered.

Regrettably, it is not possible to reply to individual comments, but you may wish to note that comments may be included in a Decision Report, to the Executive Director of Local Services and Housing and may be available for public inspection. The closing date for any comments you may wish to make is Wednesday 20th July 2016. If you wish to respond to this consultation online, please visit the web address <http://trafficconsult.northumberland.gov.uk/>.

I would urge you to take the opportunity to comment on this important matter as any decision taken will be based upon the responses received from residents who take time to return the consultation form.

Yours faithfully



Terry Luck
 Programme Officer



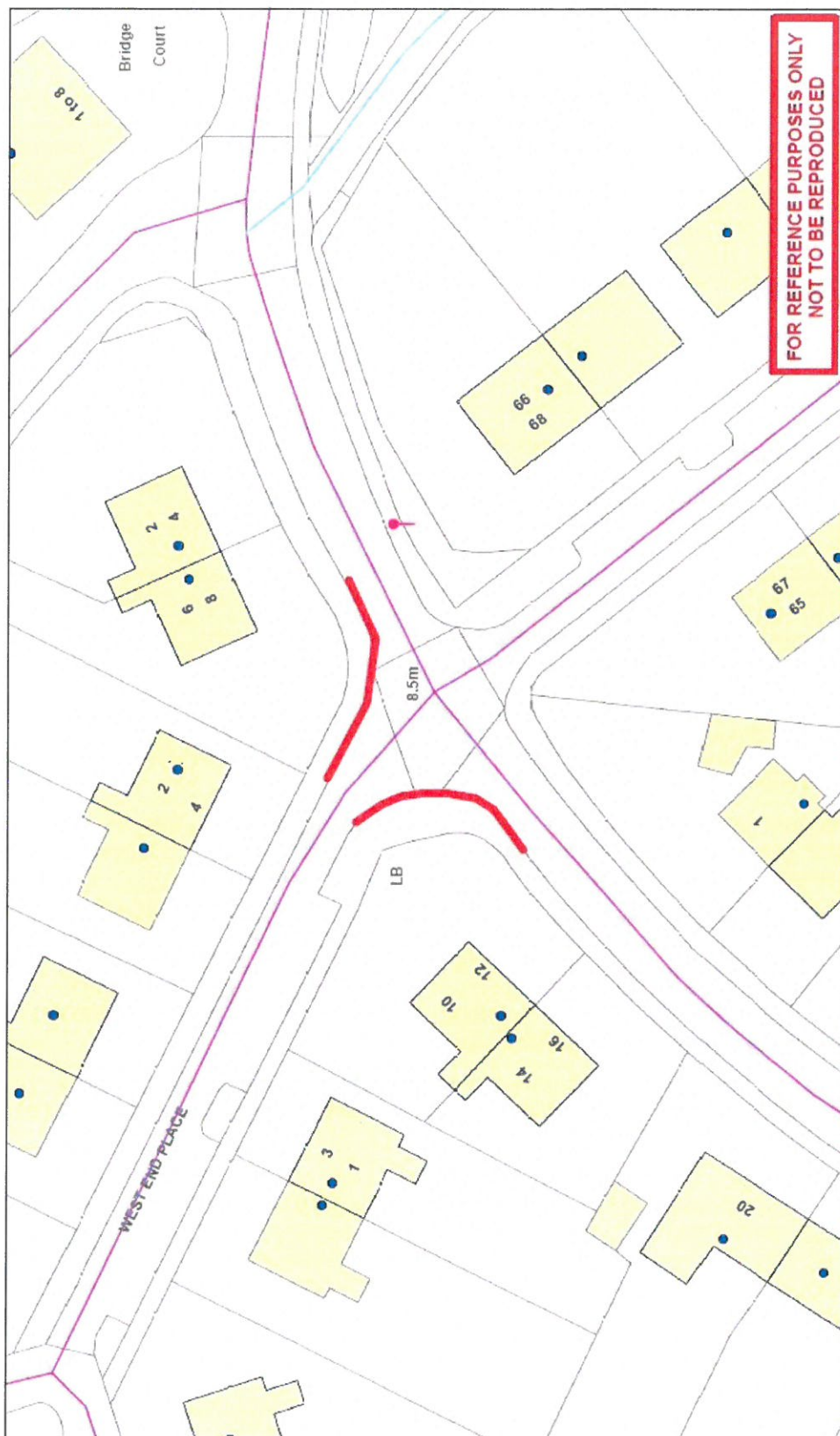

<p>Northumberland Northumberland County Council</p> <p>Northumberland County Council County Hall Worship Northumberland NE51 2EF Tel: 01670 533000</p>	<p>Network Management Information System</p> <p><small>This map is reproduced from Ordnance Survey material with the permission of Ordnance Survey on behalf of the Controller of Her Majesty's Stationary Office. Copyright © 2004 Ordnance Survey. All rights reserved. No part of this publication may be reproduced or stored in a retrieval system without the prior written permission of Ordnance Survey. Licence no. 100049648 (2004).</small></p>	<p>Title: Proposed No Waiting at any Time West End Place Tweedmouth</p>	<p>Dm: AW</p>	<p>Date: May 16</p>	<p>Scale: NTS</p>
---	---	--	----------------------	----------------------------	--------------------------

APPENDIX B

F O R	A G A I N S T	N E I T H E R	Other Relevant Comments
		1	Thank you for your letter dated 29th June 2016 in which you invite us to offer our comments on the above proposal. I would inform you that as Emergency Service we may be required to use the above road(s) for access and egress in the event of being activated to attend an emergency call, or to convey patients to hospital for outpatient appointments. I would thank you for your consultation on this matter and offer our support for the ongoing road safety programme.
	1		On the plans that I received it looks like your no waiting proposal, thick red line starts outside my house 10 West End Road as this goes into West End Place which is a one way road I cannot see how this can be said to be a road safety issue as no cars can come out West End Place this way. If this proposal takes effect I would like you to tell me where I park my car if not outside my own house I m a taxi driver and very concerned. The houses over the road from me all have off road parking and will not be affected but the rest of us we haven't and will be.
1			Great idea, a bit late yet still an improvement.
1			Yes I strongly agree with the proposed no waiting. But due to amount of traffic and speed I think these markings should be extended, due to size of bus stop marking. It would allow traffic to flow easier turning right/left onto Union Park Road. Please see my blue marking on map. Another junction that is accident waiting to happen is Osborne Crescent onto west End Road with cars parked on footpath blocking sight line and pedestrian access.
2	1	1	

APPENDIX C

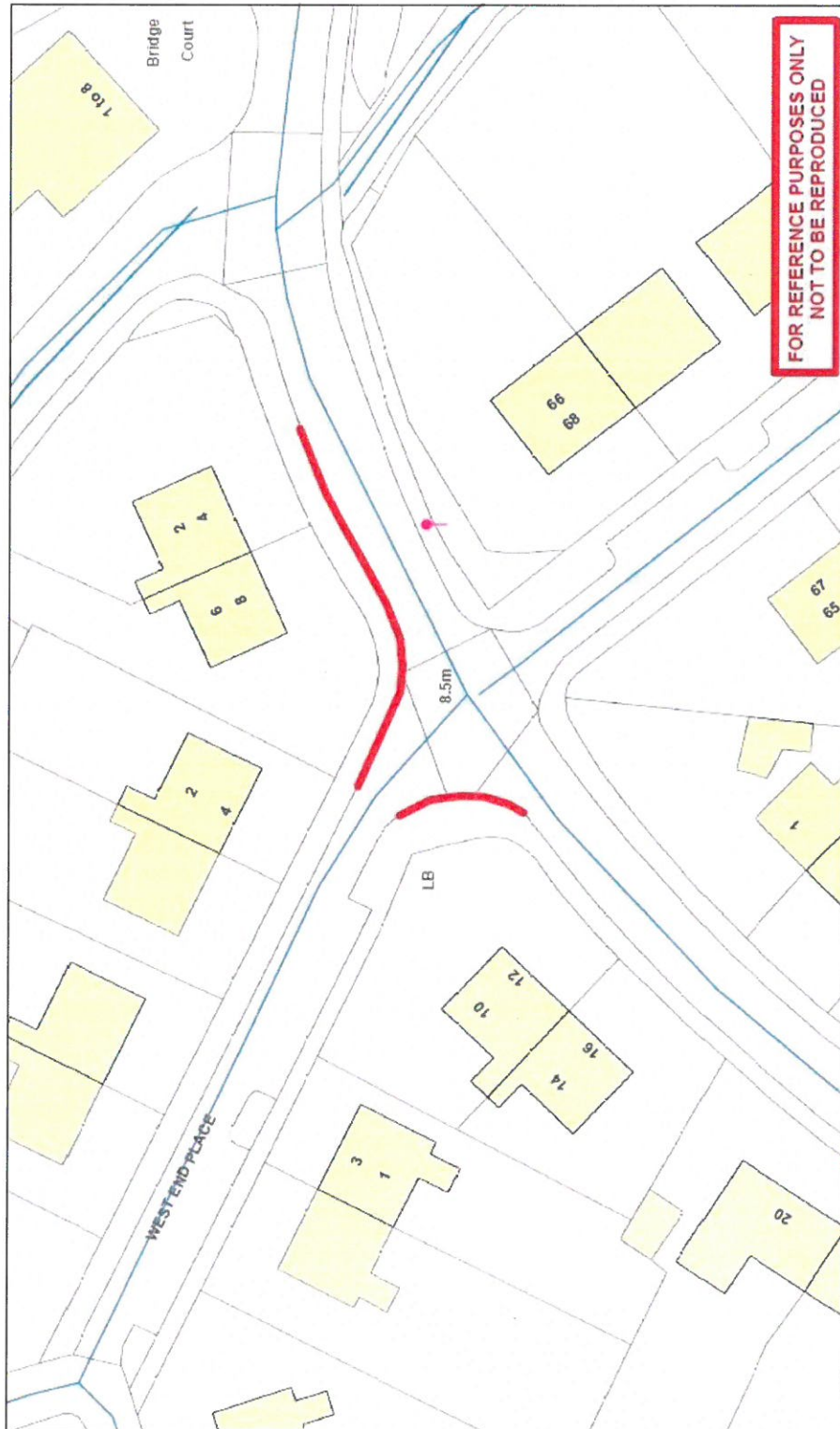

Northumberland Northumberland County Council Northumberland County Council County Hall Morpeth Northumberland NE21 2EF Tel: 01670 533000	Network Management Information System <small>This map is reproduced from Ordnance Survey data with the permission of Ordnance Survey. It is not to be used for navigation. It is not to be used for any purpose other than that for which it was prepared. It is not to be used for any purpose other than that for which it was prepared. It is not to be used for any purpose other than that for which it was prepared.</small>	
	Title: Proposed No Waiting at any Time West End Place Tweedmouth Revision 2	Dm: AW Date: AUG 16 Scale: NTS