

NORTHUMBERLAND

Northumberland County Council

RECORD OF DECISION TAKEN BY CORPORATE DIRECTOR OF LOCAL SERVICES

Corporate Director of Local Services - Barry Rowland

PROPOSED TIME RESTRICTION AMENDMENT – LOW NEWTON-BY-THE-SEA

Purpose of report:

To consider changing the existing seasonal 'No Waiting at Any Time May – September' restriction to 'No Waiting at Any Time' at Low Newton by the Sea

Recommendations:

It is recommended that the Corporate Director agrees the proposals set out in the report relating to;

- 1) The amendment of the existing 'No Waiting at any Time May – September' restriction to 'No Waiting at Any Time'***
- 2) The introduction of 'No Waiting every day between 9am and 6pm' on the west side between Farm Road and Boatman's Place***

Key issues

- 1) The Department for Transport are urging Local Authorities to reduce sign clutter where possible. Amending the time restriction will remove 21 signs from the network
- 2) The seasonal aspect of the restriction does not serve any significant purpose

Report Author Paul McKenna – Senior Transport Projects Engineer
(01670) 624129
Paul.McKenna@Northumberland.gov.uk

PROPOSED TIME RESTRICTION AMENDMENT – LOW NEWTON-BY-THE-SEA

BACKGROUND

Introduction

- 1) Low Newton-by-the-Sea is a fishing Village owned by the National Trust and located on the coast of Northumberland. A 6 metre wide road known as the C72 Link house to Low Newton extends to Newton Square. A turning area is provided at this point where the road leads to private land. There are approximately 50 properties in the area, some of which are used as holiday lets. They are accessed via the Square, Farm Road or Boatman's Place. Within the Square is the Ship Inn which has proven highly successful since being taken over by its current landlord in May 1999.
- 2) On the approach to Low Newton-by-the-Sea there is a car park less than 300 metres from the main square suitable for around 60 vehicles. All day parking is available at a cost of £2. On the C72 restrictions are imposed in the form of 'No Waiting at Any time May – September' mainly due to its narrow width.
- 3) Prior to rolling out Civil Parking Enforcement (CPE) during April 2012 there were very few signs dictating the restriction. The implementation of CPE has seen a significant increase in the number of signs being introduced to bring the restriction up to legal and enforceable standards. The signs were erected at 60 metre intervals to indicate the seasonal aspect of the restriction. Many of the signs have had to be replaced as they are being vandalised or removed on a regular basis.
- 4) On 2nd January 2013 the Department for Transport (DfT) published a document that has since been circulated to Local Authorities entitled 'Reducing Sign Clutter'. The detail relates to the need for Local Authorities to identify, review and remove unnecessary traffic signs as a cost effective means of improving the environment.

Consultation

- 5) 82 consultation letters were sent out back in 24th October 2012 to residents and statutory bodies with a proposal to remove the current 'May to September' seasonal aspect of the existing 'No Waiting' restriction. The results dictated 8 for and 9 against as shown in Appendix 2. Residents indicated the benefits to the seasonal restriction such as parking on the C72 during inclement weather conditions. Elderly residents noted the difficulty of walking from the car park to nearby facilities. The proprietor of the Ship Inn offered similar concerns including the effect it would have on the business as they are reliant on trade particularly at evening times.
- 6) To alleviate these concerns, the section of the C72 on the west side between Farm Road and Boatman's Place can be made 'No Waiting

every day between 9am and 6pm'. Parking would therefore be permitted on an evening when the Ship Inn needs it most. Any resident or guest overspill can also be accommodated. Although the restriction would require a sign, 20 signs would still be removed out of the original 21 proposed. The amendment was agreed by the Parish Council, the Local Member and at Planning and Environment Committee in February 2013.

- 7) Intention to make the order was then advertised in April 2013 and one additional objection was received. The objection related to the validity of the responses given, stating that some were 'neutral' rather than in favour. It also noted that one objection had been missed off which was due to a clerical error and has now been included. The response forms give an option of supporting or not supporting the proposal. If they do not state a preference they are classed as 'neither' and this ensures transparency. The effect on parking near the church in winter months has been cited as a problem but the car park is close by and if it is unsuitable during adverse weather conditions there is a section of unrestricted highway within the verge to park immediately in front of the access. If this becomes a maintenance issue then it can be monitored. The objection argues that preventing parking in winter months will have adverse safety implications. As there is suitable parking available near the church and availability is being made to park close to the public house it is felt that any safety concerns have been addressed.

Conclusion

- 8) The additional objection is noted and has been considered but it is recommended that the proposals previously agreed by the Parish, the Local Member and the Planning and Environment Committee be taken forward to implementation as shown in Appendix 3.
- 9) The Council has the power to hold a public inquiry before making a traffic regulation order. Such an inquiry might enable disputed evidence to be tested under cross-examination and the need for an order to be critically examined by an independent inspector. In this particular case, officers believe that the extensive consultation process and involvement with interested parties, means that such an inquiry is unlikely to bring any fresh information to light and it is therefore recommended that an inquiry is not held.

APPENDIX INDEX

Appendix 1 – Consultation Plan

Appendix 2 – Consultation Summary

Appendix 3 - Proposal

IMPLICATIONS ARISING OUT OF THE REPORT

Policy:	None
Finance and value for money	To be financed by the Local Transport Plan
Human Resources:	None
Property	None
Equalities	None
Risk Assessment	Business and residential use
Sustainability	None.
Crime & Disorder	None
Customer Considerations:	Motorists and residents will be required to comply with the restrictions proposed.
Consultation	Emergency Services, Road User Organisations, County Councillor for the area.
Wards	Embleton Ward

DECISION TAKEN

Title of Executive Member or Officer(s):*

Deidre Campbell – Policy Board Member,
Streetcare and Environment

Subject:

*PROPOSED REMOVAL OF SEASONAL ASPECT OF 'NO WAITING AT ANY TIME' RESTRICTION IN NEWTON BY THE SEA
PROPOSED INTRODUCTION OF 'NO WAITING 9AM-6PM' RESTRICTION IN NEWTON BY THE SEA*

Consultation

18 Responses
8 For
9 Against
1 Neither

Decision Taken:

*TO APPROVE THE REMOVAL OF THE SEASONAL ASPECT OF 'NO WAITING AT ANY TIME' RESTRICTION
TO APPROVE THE INTRODUCTION OF A 'NO WAITING 9AM-6PM' RESTRICTION IN NEWTON BY THE SEA*

Signature of Corporate Director

Date

18/10/13

Appendix 1 – Consultation Plan

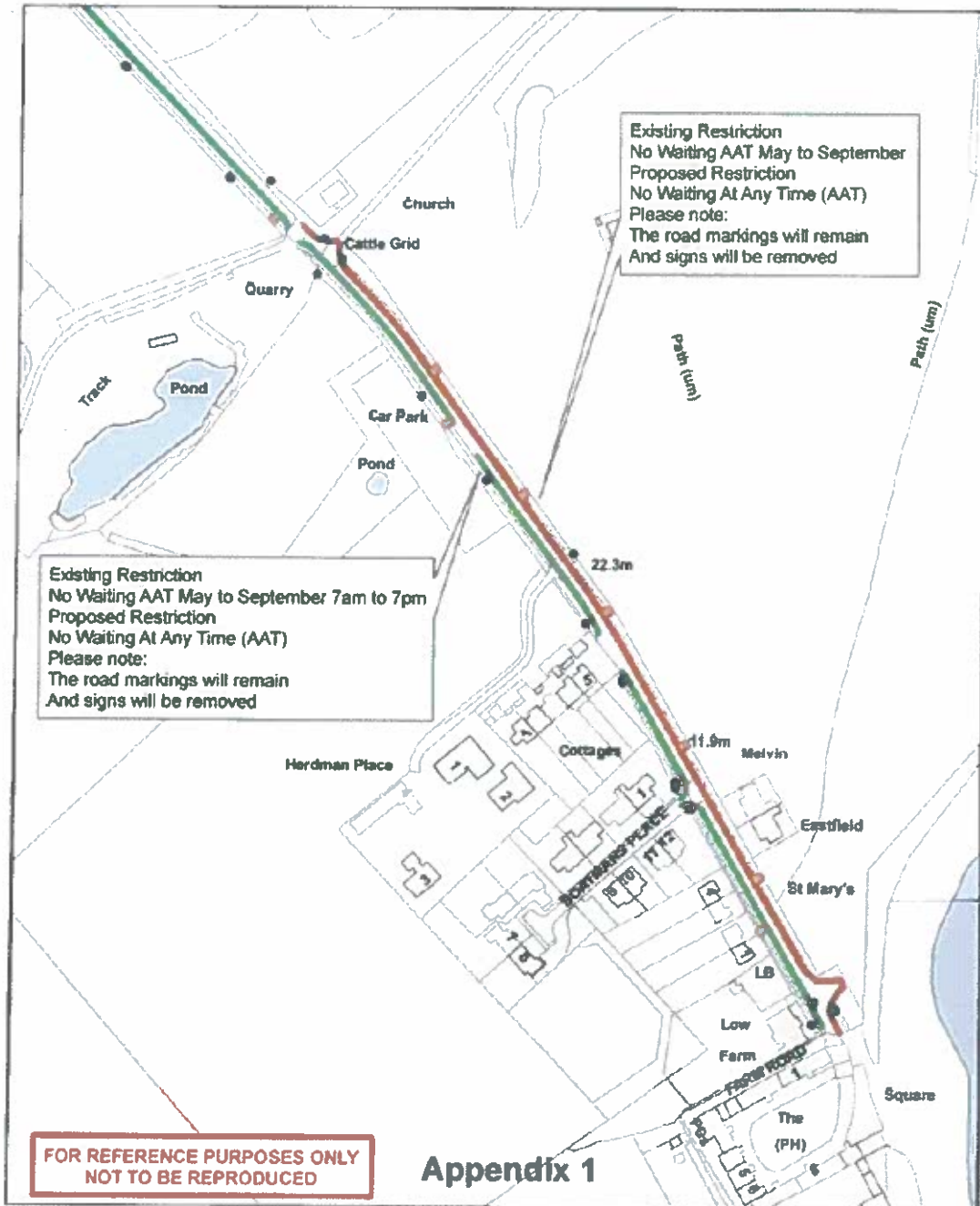

<p>Northumberland Northumberland County Council</p>	<p>Network Management Information System</p>	<p>Title: Proposed changes in Waiting Restrictions Low Newton by the Sea M/A10/110/8/CON/NEWT</p>		
<p><small>Northumberland County Council County Hall Elizbeth Northumberland NE11 1ZP Tel: 01670 533000</small></p>	<p><small>This map is reproduced from Ordnance Survey material with the permission of Ordnance Survey on behalf of the Controller of Her Majesty's Stationary Office © Crown Copyright. Unauthorised reproduction infringes Crown Copyright and may lead to prosecution or civil proceedings. License no: 100049043 (2012)</small></p>	<p>Drn:</p>	<p>Date: Jan 2013</p>	<p>Scale: NTS</p>

Appendix 2 – Consultation Summary

FOR	AGAINST	NEITHER	APPENDIX 2 - CONSULTATION SUMMARY - LOW NEWTON
	1		While we feel there is a need to implement a no waiting restriction it may be more beneficial to shorten the time of allowing cars to park at Low Newton i.e. 31st Oct to 1st March. This would restrict traffic etc at the busiest times of October half term and east holidays, but enable residents to park during winter months when the weather has proved tricky for negotiation of the incline from the square to the brow of the hill (not easily negotiated with a boot full of shopping!). Therefore we propose 1st March - 31st Oct restriction applies & 1st Nov - 1st Dec would be an option too.
1			A great move by the council! Each summer as Newton by the sea becomes more popular the flow of traffic is chaotic - sometimes local residents cannot get out of their driveways. I wondering how well this new signage would be policed?
1			I have no objection to these changes and, indeed, they seem to be pretty well accepted.
1			Much needed thank you.
	1		As a householder in Newton by the sea I am concerned by the proposal to remove the ability to park at Newton during the winter season. This practice has existed for many decades and has not given rise to any significant problems. It is essential in the village for a number of reasons. Firstly that householders would be restricted from having guests parking outside of their address and secondly the car park is somewhat remote and requires often elderly people to walk 2-300 yards up a steep hill in the middle of winter with insufficient street lighting. The car park itself, of course, has an un-metalled surface and is unlit and therefore poses an accident risk, at this time of year particularly. As far as I am aware, there is no pressure from the parish council to change the existing arrangements and they appear to be completely unnecessary.
	1		As residents at no. 3 Old Building (behind Square) and as members of Newton church - St Mary's we have the following comments. This will inevitably create more pressure on residents parking in and behind the square (i.e. where no yellow lines) by people who know how to get around the restriction and who will always be determined to be at the nearest point to the pub / beach / walk and will park illegally in residents areas. More illegal parking behind the square increases our concern over access by emergency vehicles e.g. fire / ambulance. St Mary's has regular services (Sunday & weekdays) as well as a meeting venue and a community venue e.g.. concerts etc. These events are to be encouraged not made more difficult by reducing ease of access. The church has been there for 110 years. There is fear that making parking more difficult will increase pressure on expanding car and coach car parks leading to teh increasing - our population by visitors and spoiling the peace beauty and tranquillity people strive to protect.
1			There are also very serious issues regarding the large heavy articulated vehicles that are forced to reverse down the back lane at Low Newton by the sea (including refuse collection etc). In the interests of public safety this should be looked at immediately. The lane is also access for walkers (and public/disabled toilets), children etc. and even to teh untrained eye looks like an accident waiting to happen.
1			
1			

	1	<p>Parish Cllrs have consulted with residents at Newton. Their views are as follows. Whilst appreciating the desire to remove signage and the increasingly year road issues with road side parking. Whilst some residents were supportive of the recommended change because of access to the property, most of the other residents did not consider road side parking a priority issue under the existing arrangement. However, many elderly residents expressed the view that they wanted to use road side parking in the winter months for access to the beach for walking, but were insufficiently mobile to negotiate the hill to the car park. Others thought that restricted access to The Shop, and to the community events held there on winter nights, might prevent them from attending, especially if the weather was also poor. The parish council are also concerned about parking at High Newton (as discussed with Mr McKenna) and think it is probably better to consider all parking issues and possible solutions for High and Low Newton together. Cllrs would like Northumberland County Council to consider keeping the status quo (seasonal no waiting restrictions) until such time as highways are in a position to put options for parking to the community for a full discussion. Cllrs do fully appreciate that this would cause a delay to the plans for Low Newton, but think this is the best solution in the short term.</p>
1		<p>It is disappointing that the yellow lines cannot be removed as they spoil the landscape. The signing should be much clearer near the car park that essentially there is no parking past that point, and it is residents parking only. There is a constant stream of cars driving down, turning and driving back when they accept there is no parking and it is a dead-end. Ideally from the car park to the beach should be re-landscaped as a mixed use area (perhaps using cobbles or paving) as this would greatly enhance the area. Or a barrier/rope blocking the road - but this is much more problematic.</p>
	1	<p>I am one of many elderly residents who find that the only time in the year that I can walk on the beach at Low Newton is during the months Oct to April when the seasonal no waiting restriction is removed. This is because I cannot walk up the steep and prolonged hill from the beach to the car park. We do not have a village hall in either High or Low Newton, and during the winter months there are a number of community events, such as a film/meeting of the book club etc held at the Ship Inn in Low Newton. These are an opportunity for people to get together and are greatly appreciated. When the no waiting restriction is removed in the winter months people can drive down to Low Newton to attend. Very few, and only the young people, would be able to attend were the no waiting to be in force throughout the year. I do hope that the no waiting restriction at Low Newton will continue to be for the summer months only. I will take this opportunity to mention the serious, and sometimes dangerous, parking problems in High Newton caused by the Joiners pub customers parking, and wrecking, the village green (which is actually common land). Our only bus has threatened to stop coming because of difficulty turning when the village is over run with parked cars.</p>
	1	<p>As a long term resident of Low Newton-by-the-sea, and as proprietor of The Ship Inn I must protest most strongly at the proposal to remove the seasonal No Waiting restrictions and replace this with a No Waiting at Any Time restriction. We are in a time of financial hardship, nowhere is this more apparent than in the rural economy where there is very high unemployment and where the statistics of small business failure become ever higher. I run The Ship Inn a small business employing a total of 9 local people. While the pub is successful, it becomes more and more difficult with ever rising prices and all the many demands on a small business to make ends meet. I do not have any parking to offer my customers; the nearest parking is in the car park at the top of the hill. If my customers cannot park on the road, they will not on a cold dark winter's night park in an unlit, often very wet car park and walk down to my pub, many of my customers are elderly and cannot make the walk. I therefore will lose this very vital part of my business- the evening meals I serve in winter. The knock on effect of this is that it will no longer make financial sense to remain open during the week in winter and therefore the</p>

		<p>vast majority of my staff will be made redundant. The proposal would also affect my summer evening trade as again many of my customers are elderly and simply cannot make the walk from the car park and then have to return up what for some people is a very steep hill. There are only 2 disabled parking bays in the square, and it would seem that many people who have some limitation to their walking are not registered disabled and so these people would have no access to the wonderful beach and surroundings of Newton Bay. As a resident of Low Newton parking on the road in the evening and out of season has never caused any congestion, as we live on a dead end road traffic flow is not an issue. I hope you will take into account my views and decide against what I think would be a very retrograde step for the village of Low Newton.</p>
1		<p>I cannot agree that making no waiting restrictions all the year round will in any way help traffic flow or aid safety. At the present time there is never any problem over the winter period for either of these reasons, indeed the lifting of the summer restriction is of benefit in my opinion to the few winter visitors that come, the Ship Inn and Saint Mary's church and not least the winter visitors themselves who come for a short walk and don't have to walk, in particular, up the steep hill. I see that restrictions are necessary in teh summer (as at present) but not in winter. It is also necessary in my view to keep the limited restrictions in summer in the evening. This allows people to go for short walks along the beach and football hole and go to the Ship.</p>
1		<p>We are employees of the Ship Inn - we have full permanent employment at the ship with guaranteed hours. If these parking restrictions change we would be very worried about our hours through the winter, as we do evening meals and all the prep work involved.</p>
1		<p>There is no problem with the parking on the road in the evening and out of season. As an employee of the ship inn, I know that the evening trade in winter is vital to my employment - I have 2 small children and my husband runs his own business which is struggling in these bad financial times. I have been a resident of Low Newton for 13 years, I live here with my husband and two small children. I do not feel that there is an issue with the parking here. My reasons for not changing the parking restrictions as they currently stand are. I am an employee of The Ship Inn and the effect on trade would be drastic. If people are unable to park in the evenings then The Ship Inn would lose a lot of evening meal business. the hill is very steep and long for people with mobility issues to tackle, it is also not an appealing idea for anyone on a dark and wet night. Already The Ship Inn is struggling in these hard economic times, when many small rural business are going out of business. The Ship Inn established in the 1700's has no car parking facilities of its own, and these proposed changes would cripple the evening trade. My husband runs his own business, again these are difficult times, and if The Ship were to loose trade it would therefore not need so many staff and my job is potentially at risk. Life is very stressful already with one of my children needing 3 times a week visits to the RVI in Newcastle, the stress of my husband and I struggling further with finances is a terrible idea. I feel that the proposed changes to the parking restrictions would bring this situation about. I also feel that we are very lucky to live in such a beautiful place, a place of AONB. If you prevent people from parking down teh hill at any time, you are severely limiting peoples access and experience of such a beautiful place. It is everyone's right to be able to have access to such a place, many people with mobility issues will not have a disabled badge and so will simply not be able to experience this place. Frequently you see people sitting in the cars having cups of tea and looking out at the incredible view. I do not think it is anyone's place to stop this. People should be happy to share this beautiful place for all, and teh parking restrictions as they stand get the balance completely right.</p>
1		<p>This is an extremely important development for Low Newton. Traffic restrictions have been largely ignored and it needs aggressive policing.</p>
1		<p>I refer to your letter dated 24 October 2012 in connection with the proposed amendment to the waiting restrictions at Low Newton-by-the-Sea.</p>

			<p>I wish to object to this proposal. I am a frequent visitor to Newton as I have a relative who lives in the village.</p> <p>At present the parking restrictions operate satisfactorily. In the period between April and September daytime parking is restricted in the peak summer periods on the hill when there are larger numbers of pedestrians walking to and from the beach. Evening parking is permitted on the western side. This allows for visitors to the Ship Inn and visitors to houses in the village to take place when there is lower pedestrian footfall.</p> <p>In the period October to March parking is permitted on the western side of road. Most visitors still park in the car park with only small numbers parking on the hill. These restrictions allow for visitors including visitors to residents to park on the hill and for visitors to the Pub to park closer to the Square. I am not aware that this causes any highway safety issues or amenity issues as pedestrian footfall is lower and number of visitors must reduced.</p> <p>The impact of placing restriction on the road all year round would be to have more parking n the unrestricted grass verge between High Newton and Low Newton ,causing more damage to the verge area and a greater highway safety issue, as there is no footway on the east side of the road here, and vehicles having to drive on the grass verge on the western side of the road to pass the car parked half on the road and half on the verge. I consider this to be more dangerous than parking on the hill.</p> <p>The removal of winter parking on the hill will also harm the amenity and safety of residents , as visitors to residents will no longer be able to park outside of their houses. Instead they would have to walk, in the dark over the hill to an unlit car park or park on an unlit road.</p> <p>The reason for the proposal is highway safety concerns. I am not aware of any accident data to show the current arrangements are dangerous. A small level of on- street parking on the hill in winter actually slows traffic speeds in a village, having benefits for road safety. In a village environment restrictions should not be placed to improve traffic flows which increase speeds to the detriment of pedestrian safety.</p> <p>I am surprised that in the current economic climate that Northumberland County Council would have the resources to spend on changing Parking Orders and associated signage when there is no road safety issue and where the proposal would harm the local economy and residents amenity..</p> <p>I have attached a photograph of Low-Newton-by-the- Sea. It was taken on the Sunday of half term week in October at 3.30pm. This is typical parking for the period October to March. This level of parking does not impact on highway safety.</p> <p>I respectfully request that the County Council considers my representation and decides not to change the current parking arrangement at Low Newton-by-the-Sea.</p>
8	9	1	

Appendix 3 – Proposal

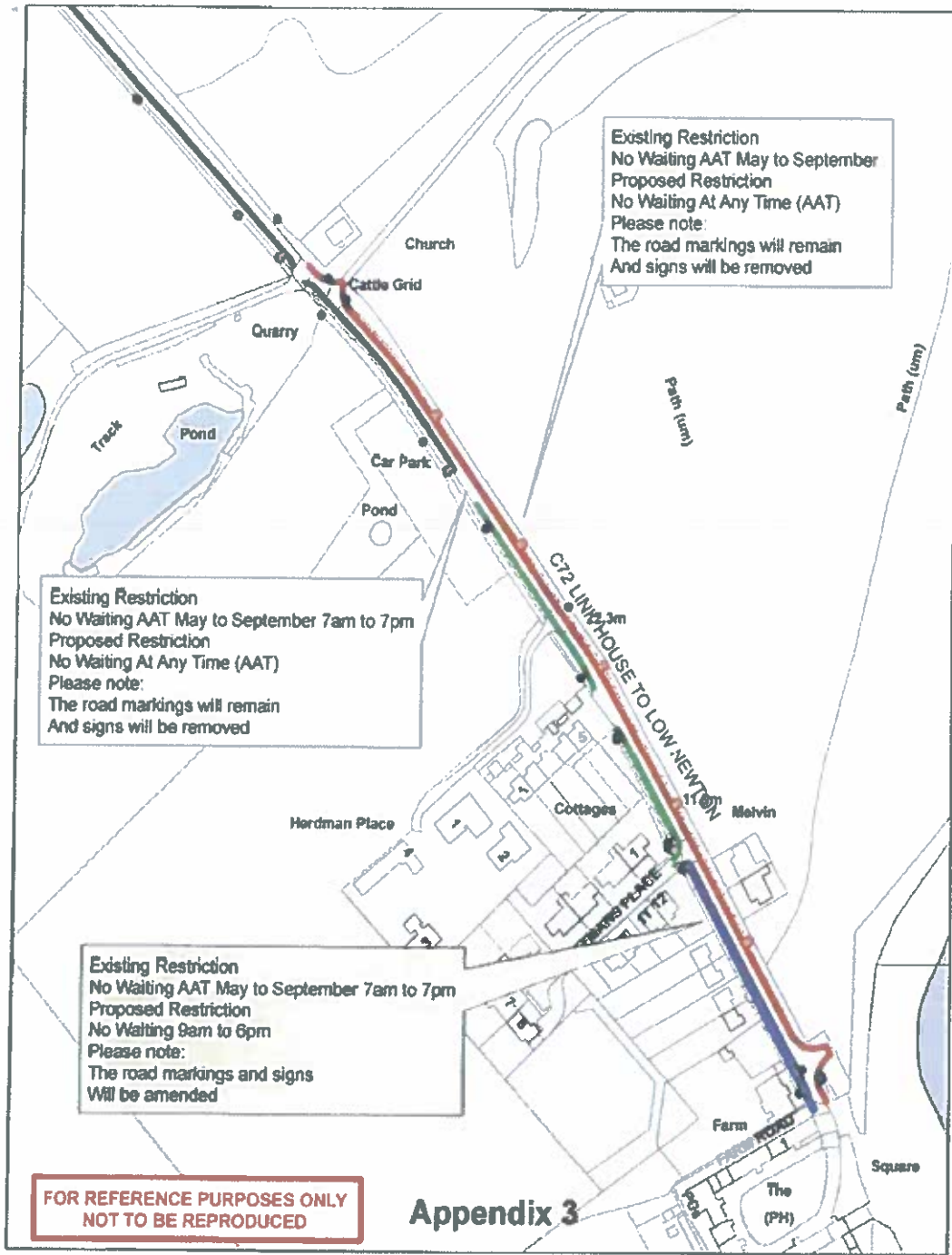

<p>Northumberland Northumberland County Council</p>	<p>Network Management Information System</p>	<p>Title: Proposed changes in Waiting Restrictions Low Newton by the Sea MA10/110/8/CON/NEWT</p>		
<p>Northumberland County Council County Hall Morpeth Northumberland NE31 2EP Tel: 01670 531000</p>	<p>This map is reproduced from Ordnance Survey material with the permission of Ordnance Survey on behalf of the Controller of Her Majesty's Stationery Office. Crown Copyright. Unauthorised reproduction infringes Crown Copyright and may lead to prosecution or civil proceedings. Licence no. 10004048 (2008).</p>	<p>Drn</p>	<p>Date: Jan 2013</p>	<p>Scale: NTS</p>