



**Northumberland County Council**

All rights reserved. No part of this document may be reproduced in any material form (including photocopying or storing in any medium) without the written permission of Northumberland County Council except in accordance with the provisions of Copyright, Designs and Patents Act 1988. Unauthorised reproduction may lead to prosecution or civil proceedings.

- NOTES:**
1. GENERAL
  - 1.1. ALL DIMENSIONS IN [mm] UNLESS STATED OTHERWISE
  - 1.2. ALL LEVELS IN [m] IN REFERENCE TO GPS CO-ORDINATE SYSTEM
  - 1.3. SURFACE WATER SYSTEM NOT SHOWN
  - 1.4. NEW STREET FURNITURE (CYCLE STANDS, BENCHES, BINS ETC) NOT SHOWN
  - 1.5. POSITION OF LIGHTING COLUMNS TO BE CONFIRMED
  - 1.6. POSITION OF TRAFFIC SIGNS ARE INDICATIVE ONLY AND SHALL BE CONFIRMED DURING DETAILED DESIGN

- ASPHALT FULL DEPTH CONSTRUCTION
- ASPHALT PARTIAL DEPTH CONSTRUCTION
- 0.6m BUFFER STRIP (BUFF FINISH) BY RUNNING LANE
- MARSHALLS MODAL MIX IN 200mm STRIPS
- MARSHALLS CONSERVATION PAVERS
- PLANTING AREAS
- RAISED KERB 100mm UPSTAND
- FLUSH KERB
- TRANSITION KERB
- BUFF TACTILE PAVING
- NEW BOLLARD

NOTE TEXT SIZE INCREASED

Rev	By	Check	Appr	Date	Reason
1	MJ	SF	GM	02/20	FIRST ISSUE

**CONSULTATION**

Client: NORTHUMBERLAND COUNTY COUNCIL  
 COUNTY HALL, MORPETH  
 NORTHUMBERLAND, NE61 2EF

**BOWES STREET, BLYTH STREETWORKS SCHEME**

**PROPOSED SCHEME LAYOUT**

Scale: 1:400



**Northumberland County Council Technical Services**

Drawn	Date	Checked	Approved
MJ	SEP'20	SF	GM

Drawing Number: HED19318/00/U9563/01/71  
 Revision: A  
 Oracle Number: HED19318

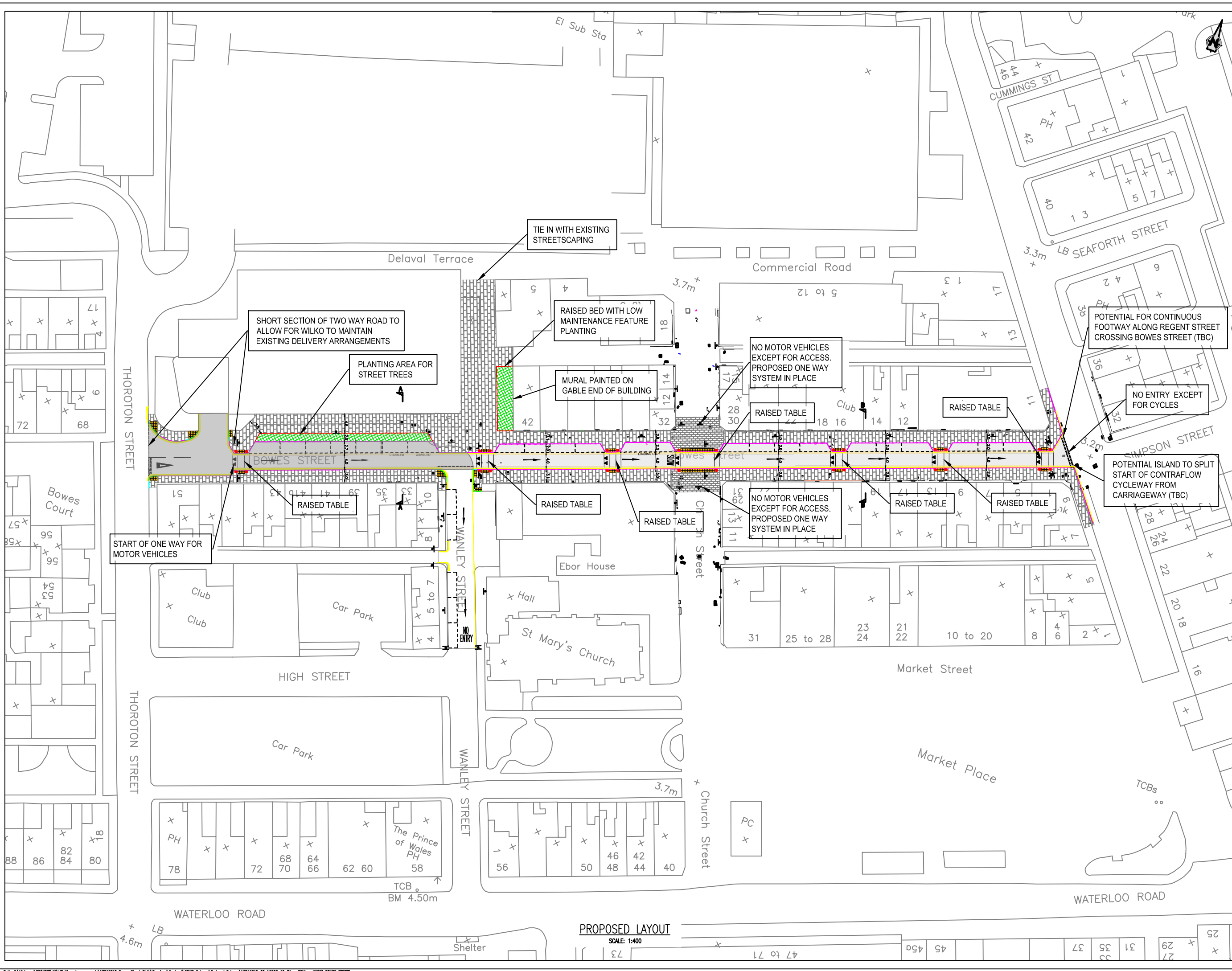

**PROPOSED LAYOUT**

SCALE: 1:400

File Path: S:\Projects\PROJECT\19\VE Minor Improvements\VED19318 Bowes Street Blyth\Drawings\Contract\CDD\Scheme\Reduced Scheme\VED19318-00-U9563-10-71 - REV A - U9563 BOWES STREET - PROPOSED REDUCED SIZE.dwg  
 Scale: 1:400  
 Date: 02/09/2020  
 Drawn: MJ  
 Checked: SF  
 Approved: GM