

Bond Dickinson

DEPOSIT OF STATEMENT AND PLAN

SECTION 31(6) OF THE HIGHWAYS ACT 1980

To Northumberland County Council

1. I am and have been since 21 September 2001 in my capacity as a trustee for the time being of J R Barrett's 1974 Farm Settlement the owner (within the meaning of the above section of the Highways Act 1980) of the 12 acres of land known as land on the north side of the B1326 opposite Lamb Street East Cramlington to the east of the former mineral railway line adjacent to the Cramlington Primary School and Methodist Church East Cramlington more particularly delineated on the plan accompanying this statement and thereon edged red.
2. The aforementioned land lies in the Parish of Cramlington St Nicholas.
3. No ways over the land have been dedicated as highways.
4. The deposit shall comprise this statement and accompanying plan.

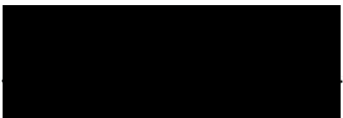
Signed . 

Name: Helen Frances Tavrogas

duly authorised for and on behalf of the Trustees of J R Barrett's 1974 Farm Settlement

Address Bond Dickinson LLP One Trinity Broad Chare Newcastle upon Tyne NE1 2HF

Date 8 August 2013

Signed (witness) 

Name (of witness) CHARLOTTE PATTERSON - RYAN

Address BOND DICKINSON LLP ONE TRINITY BROAD CHARE NEWCASTLE UPON TYNE NE1 2HF

Occupation SOLICITOR

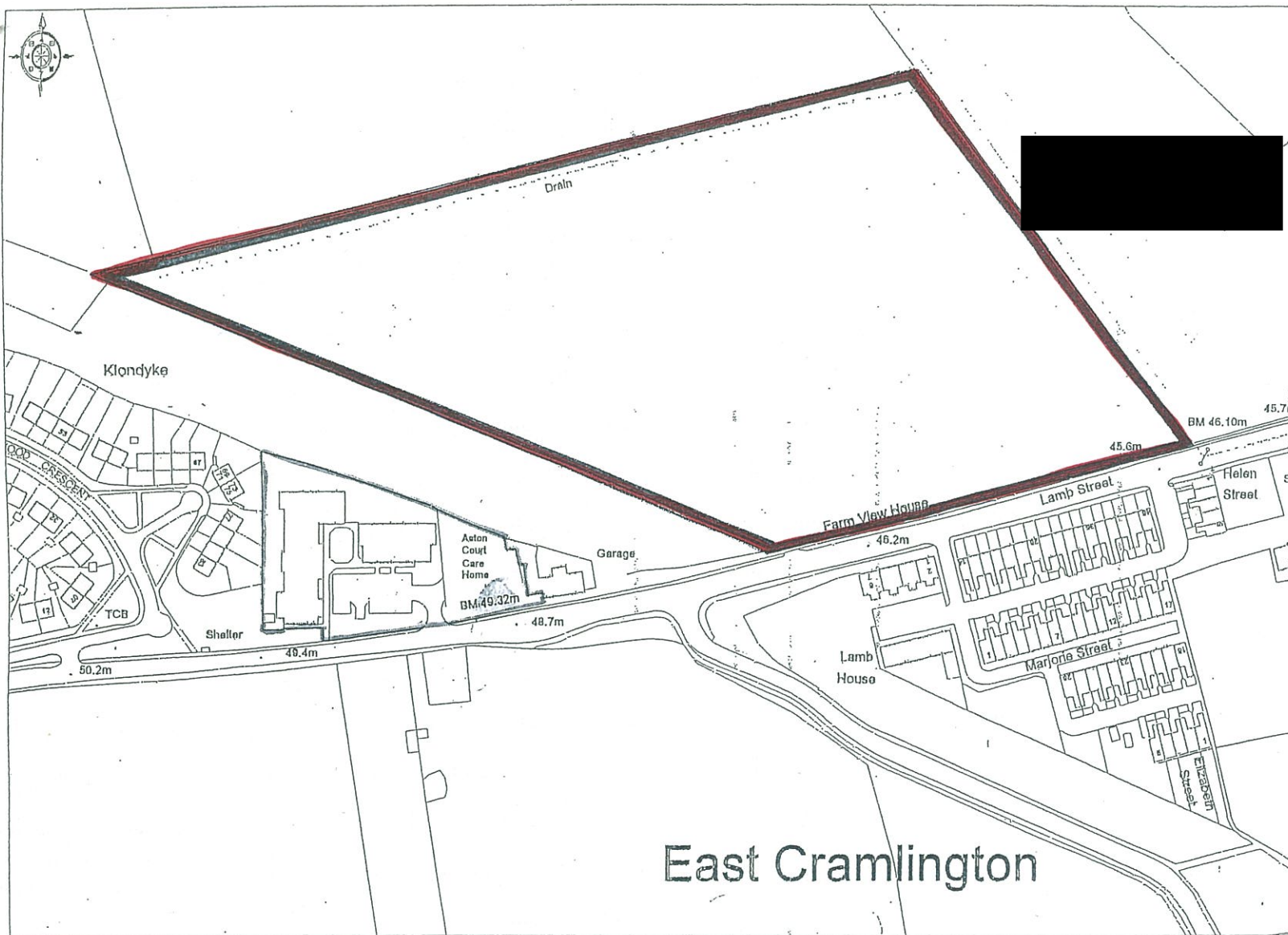

Ordnance Survey

© Crown copyright 2004, All rights reserved, Licence Number 100020449, Survey Scale - 1:2500 Plotted Scale - 1:2500

Land at Klondyke, Lamb Street, East Cramlington