

## Application Form

## Form CA16

## Application Form for deposits under section 31(6) of the Highways Act 1980 and section 15A(1) of the Commons Act 2006

**PART A: Information relating to the applicant and land to which the application relates**  
*(all applicants must complete this Part)*

1. Name of appropriate authority to which the application is addressed:

**Northumberland County Council**

2. Name and full address (including postcode) of applicant:

**Jenny Blackie of Savills  
Acting as authorised agent for and on behalf of Dunham Leisure Limited  
The Lumen  
St James Boulevard  
Newcastle Helix  
Newcastle upon Tyne  
NE4 5BZ**

3. Status of applicant (tick relevant box or boxes):

I am

(a)  the owner of the land(s) described in paragraph 4.

(b)  making this application and the statements/declarations it contains on behalf of Dunham Leisure Limited who is the owner of the land(s) described in paragraph 4 and in my capacity as Agent.

4. Insert description of the land(s) to which the application relates (including full address and postcode):

**The land compromises mainly a caravan park and adjoining woodland.**

**Address:  
South Meadows Caravan Park  
South Road  
Belford  
NE70 7DP**

5. Ordnance Survey six-figure grid reference(s) of a point within the area of land(s) to which the application relates (if known):

**Grid Reference: NU109328**

6. This deposit comprises the following statement(s) *Parts B*

**PART B: Statement under section 31(6) of the Highways Act 1980**

Dunham Leisure Limited is the owner of the land described in paragraph 4 of Part A of this form and shown edged red on the map accompanying this statement.

Ways shown lined purple on the accompanying map are public footpaths.

No other ways over the land shown edged red on the accompanying map have been dedicated as highways.

**PART C: Declaration under section 31(6) of the Highways Act 1980**

*Not applicable.*

**PART D: Statement under section 15A(1) of the Commons Act 2006**

*Not applicable.*

**PART E: Additional information relevant to the application**  
*(insert any additional information relevant to the application)*

*Not applicable.*

**PART F: Statement of Truth**  
*(all applicants must complete this Part)*

**WARNING:** If you dishonestly enter information or make a statement that you know is, or might be, untrue or misleading, and intend by doing so to make a gain for yourself or another person, or to cause loss or the risk of loss to another person, you may commit the offence of fraud under section 1 of the Fraud Act 2006, the maximum penalty for which is 10 years' imprisonment or an unlimited fine, or both.

**I BELIEVE THAT THE FACTS AND MATTERS CONTAINED IN THIS FORM ARE TRUE**

Signature (of the person making the statement of truth):



Print full name: *JENNY BLACKIE*

Date: *24/08/2021*

**You should keep a copy of the completed form**

**Data Protection Act 1998 - Fair Processing Notice**

The purpose of this Fair Processing Notice is to inform you of the use that will be made of your personal data, as required by the Data Protection Act 1998.

The appropriate authority (see explanation of definition in above guidance notes) in England is the data controller in respect of any personal data that you provide when you complete this form.

The information that you provide will be used by the appropriate authority in its duties to process applications to deposit statements, maps and declarations under section 31(6) the Highways Act 1980 and statements under section 15A(1) of the Commons Act 2006. The information you provide will also be used by the appropriate authority in its duty to update the registers in which details of such deposits are recorded under the Dedicated Highways (Registers under Section 31A of the Highways Act 1980) (England) Regulations 2007 and the Commons (Registration of Town or Village Greens) and Dedicated Highways (Landowner Statements and Declarations) (England) Regulations 2013.

The appropriate authority is required by the legislation above to maintain a register which holds information provided in this form, which can be inspected online or in person by members of the public on request. It may also be required to release information, including personal data and commercial information, on request under the Environmental Information Regulations 2004 or the Freedom of Information Act 2000. However, the appropriate authority will not permit any unwarranted breach of confidentiality nor will they act in contravention of their obligations under the Data Protection Act 1998.

NOTES

PROJECT

SOUTH MEADOWS CARAVAN PARK  
SOUTH ROAD  
BELFORD  
NE70 7DP

CLIENT

DUNHAM LEISURE LTD

TITLE

PLAN REFERRED TO

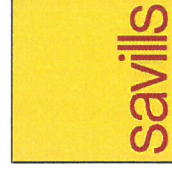

The Lumen, St James Boulevard, Newcastle  
Helix, Newcastle upon Tyne, NE4 5BZ  
Tel 0191 917 1444  
www.savills.co.uk

SCALE

1:5,000 @ A3

DRAWN I.M.

DATE JULY 2021

DRAWING NUMBER

5291 / 140

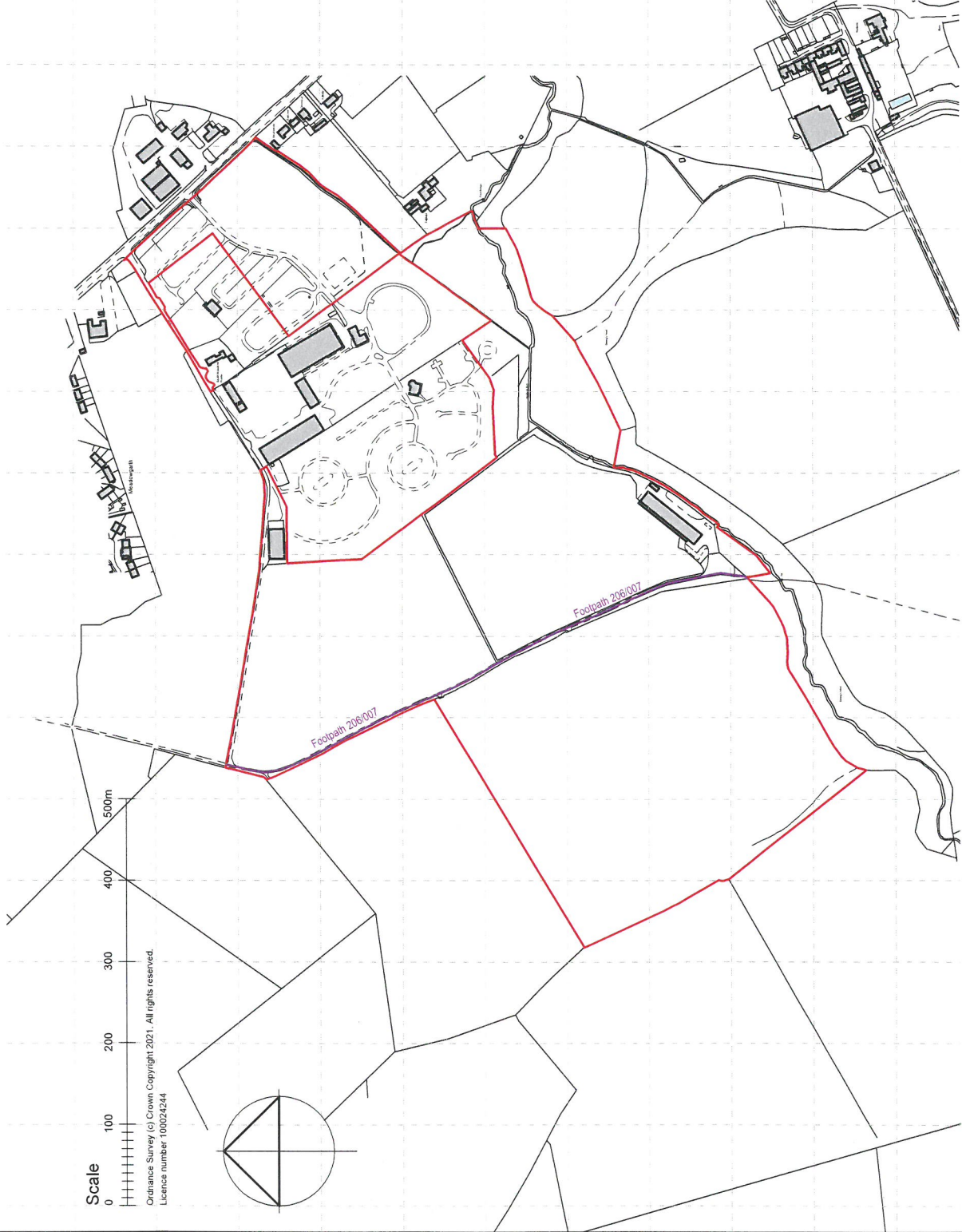

Scale



Ordnance Survey (c) Crown Copyright 2021. All rights reserved.  
Licence number 100024244

