

REDEVELOPMENT OF WANSBECK SQUARE

Public Realm

Landscape proposals aim to connect the new train platform to Station Road by providing an accessible and attractive route that will encourage people to explore the new community centre. A series of seating terraces will address the challenging level difference between the high street and train station, while creating an amphitheatre space where various small-scale events could take place. The proposed ramp along the western edge of the site will provide improved accessibility for pedestrians and cyclists from the new train station. The proposal involves removing the existing vehicular access to Station Road, and replacing it with a dedicated service route to the east running alongside the train platform to access the substation and service the building. This aims to remove current anti-social behaviour in the undercroft area. This also provides opportunities for the proposed landscaping to tie into existing levels along Station Road.

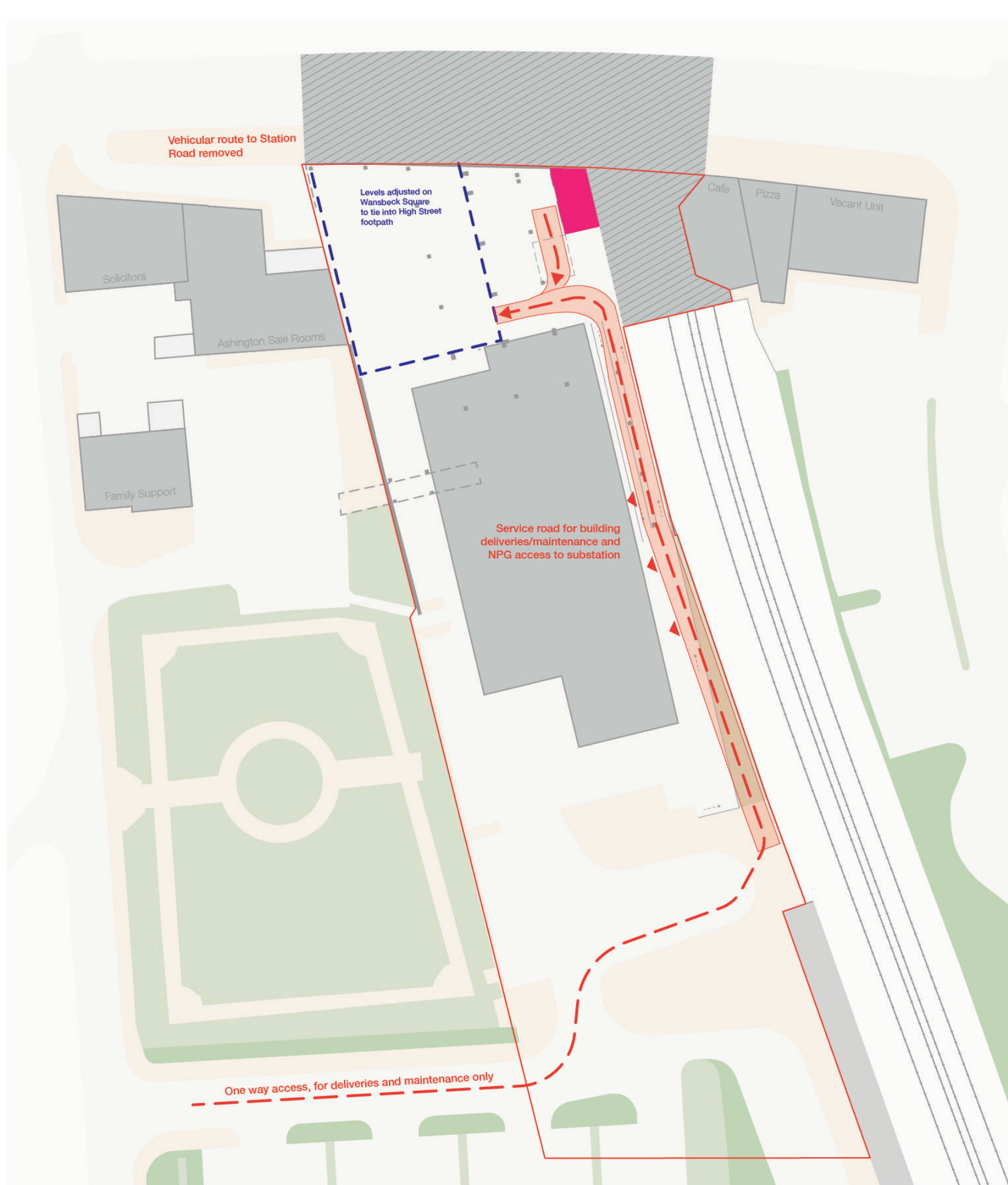
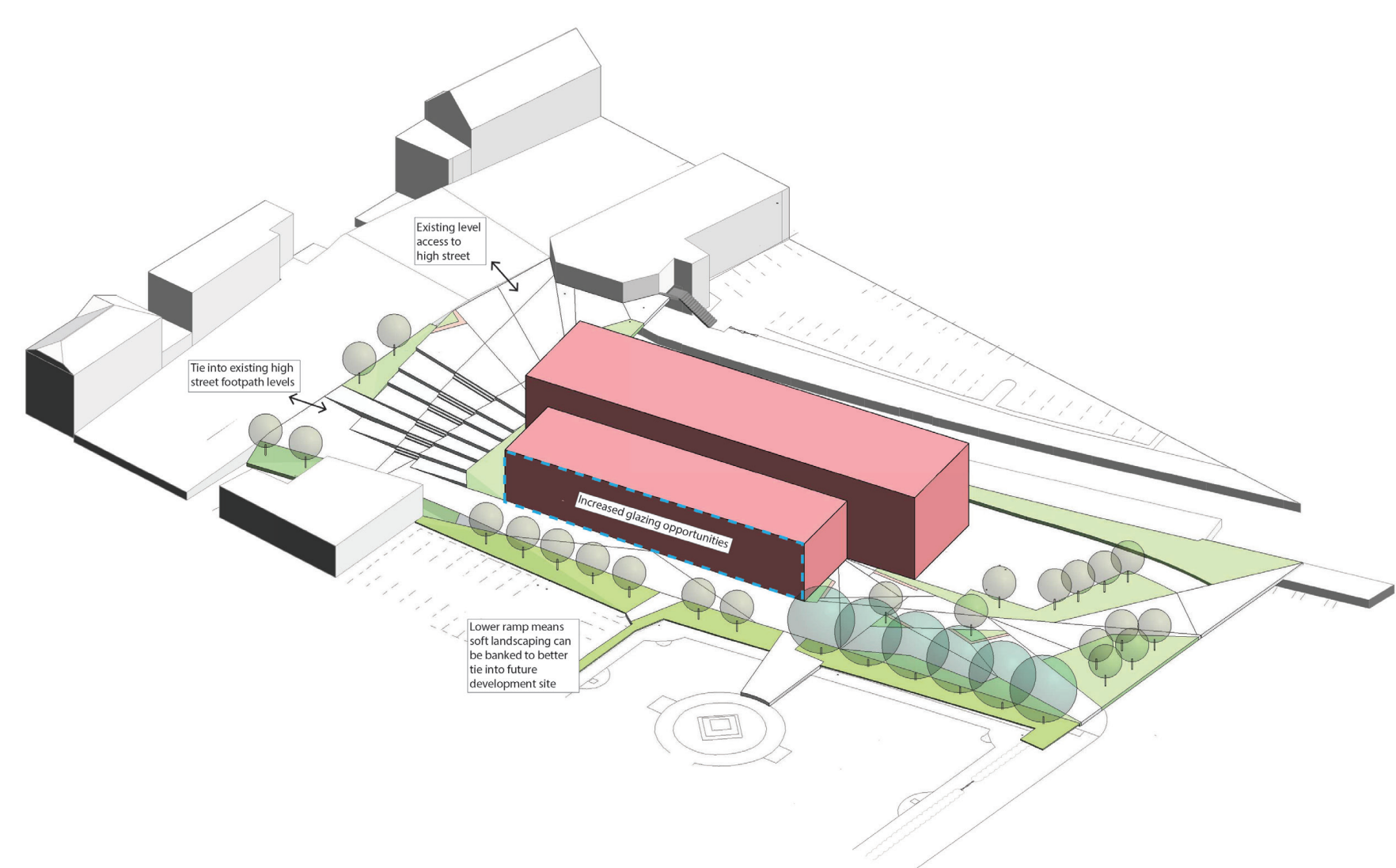

Proposed service route



Material palette

Introducing new greenery will soften the feeling of the town centre and create an inviting environment, encouraging people to stay and explore what the new development has to offer. Robust planting species will be chosen to ensure the longevity of the scheme and its attractiveness throughout all seasons. Inspiration has been taken from Station Road - materials palette will match the existing high street landscape to create a coherent design, blending seamlessly with the surroundings.