

# **Public Path Extinguishment Order**

## **Highways Act 1980**

### **Northumberland County Council**

#### **Parish of Widdrington Station & Stobswood (Public Footpath No 11) Extinguishment Order 2021**

This Order is made by Northumberland County Council ("the Authority"), under Section 118 of the Highways Act 1980 ("the 1980 Act"), because it appears to the Authority that, the footpath described in paragraph 1 below is not needed for public use.

Widdrington Station & Stobswood Parish Council has been consulted as required by Section 120(2) of the 1980 Act.

#### **BY THIS ORDER:**

1. The public footpath over the land situate at Widdrington Station, and shown by a continuous bold line on the map attached to this Order and described in the Schedule to this Order shall be extinguished after 63 days from the date of confirmation of this Order.

## **Schedule**

### **Description of land**

#### **Public Footpath No 11 (Parish of Widdrington Station & Stobswood)**

The public footpath, from a point marked E, 20 metres south of "Woodland Villa", in a north-easterly direction for a distance of 55 metres, to a point marked F, at the junction of Grange Road and Grangemoor Road.

THE COMMON SEAL OF NORTHUMBERLAND COUNTY COUNCIL was hereunto  
affixed this 23<sup>rd</sup> day of April 2021 in the presence of:-

*BJMCCave*  
Duly Authorised Officer

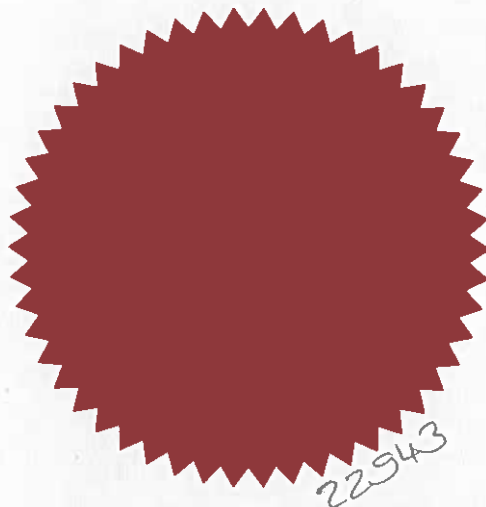

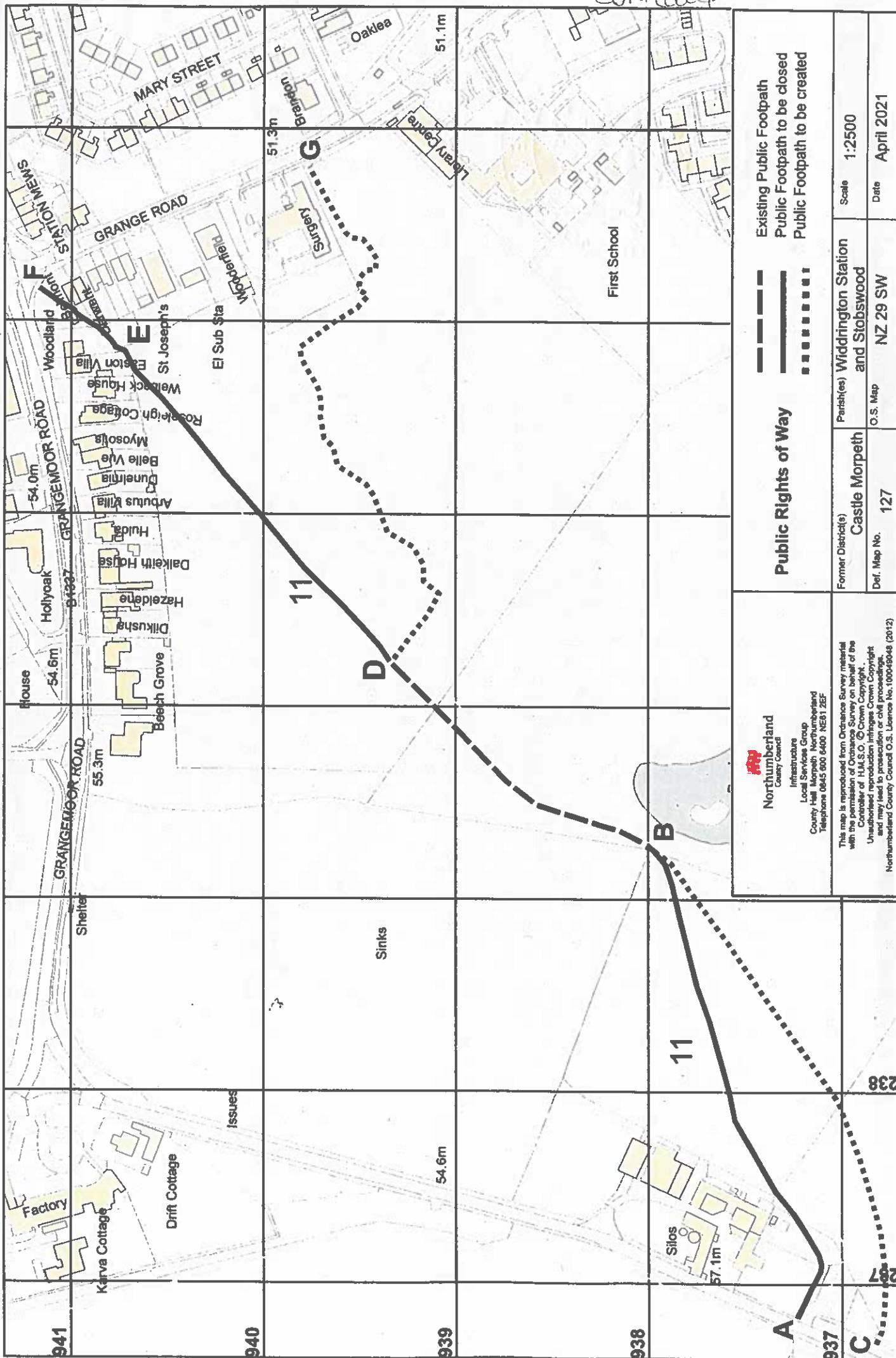

**NORTHUMBERLAND COUNTY COUNCIL** in exercise of their powers under section 118 of the 1980 Act, hereby confirm the foregoing Order:

**Parish of Widdrington Station & Stobswood  
(Public Footpath No 11) Extinguishment Order 2021**

The Common Seal of Northumberland County Council was hereunto affixed this day the 28<sup>th</sup> of August 20 24 in the presence of:-



**Duly Authorised Officer**

