



# Northumberland County Council

Mr Neil Dawson  
Senior Countryside & Green Open Spaces  
Officer  
Local Services – Technical Services  
Northumberland County Council  
County Hall

**Your ref:**

**Our ref:** BM/016080

**Enquiries to:** Barbara McCabe

**Email:** Barbara.McCabe@northumberland.gov.uk

**Tel direct:** 01670 622618

**Date:** 28<sup>th</sup> August 2020

By Email:

[neil.dawson@northumberland.gov.uk](mailto:neil.dawson@northumberland.gov.uk)

Dear Sir/Madam

## **Highways Act 1980, Section 26.**

### **Parish of Middleton (Public Footpath No 16) Creation Order 2020**

The County Council made the above Order on 14<sup>th</sup> August 2020. Please find by way of service upon you for your information, formal notice to this effect together with a copy of the Order and map thereto.

Please note that any enquiries regarding the Order should be directed: 01670 622618 or by contacting the above email address.

Yours faithfully

Barbara McCabe  
Legal Officer

Enc

**Barbara McCabe, Legal Officer, Legal Services**

Directorate of Human Resources/Organisational

Development and People Services,

County Hall, Morpeth,

Northumberland, NE61 2EF

T: 01670 622618 E: [Barbara.McCabe@northumberland.gov.uk](mailto:Barbara.McCabe@northumberland.gov.uk)

[www.northumberland.gov.uk](http://www.northumberland.gov.uk)



# Notice of Public Path Creation Order

## Highways Act 1980 Northumberland County Council

### Parish of Middleton (Public Footpath No 16) Creation Order 2020

Mr Neil Dawson  
Senior Countryside & Green Open Spaces Officer  
Local Services – Technical Services  
Northumberland County Council  
County Hall

By Email:

[neil.dawson@northumberland.gov.uk](mailto:neil.dawson@northumberland.gov.uk)

The above Order was made on 14<sup>th</sup> August 2020 under Section 26 of the Highways Act 1980. The effect of the Order will be as follows:-

#### **Public Footpath No 16 (Parish of Middleton)**

To create a 1.5 metre wide footpath, from a point marked A, 680 metres north-east of Coastguard Lodge, at Ross, in a south-easterly direction for a distance of 40 metres, then in an easterly direction for a distance of 160 metres, then in a north-easterly direction for a distance of 255 metres to a point marked C, 1100 metres north-east of Coastguard Lodge.

These details are shown on the Order maps. A copy of the Order and maps have been placed, and may be seen free of charge at the offices of the Legal Services Manager, County Hall, Morpeth during normal working hours. Copies of the Orders and map may be purchased. Anyone wishing to view the documents may do so by appointment only and by contacting [barbara.mccabe@northumberland.gov.uk](mailto:barbara.mccabe@northumberland.gov.uk) They can also be viewed online at <https://www.northumberland.gov.uk/About/Maps/Public-rights-of-way.aspx#ordersandnotices>. Any queries relating to the order should be directed to [philip.bradley@northumberland.gov.uk](mailto:philip.bradley@northumberland.gov.uk)

Any representations about or objections to the Order may be sent in writing to the Legal Services Manager at the address shown below not later than 15<sup>th</sup> October 2020. Please state the grounds on which they are made.

If no such representations or objections are duly made, or if any so made are withdrawn, the Northumberland County Council may confirm the Order as an unopposed Order. If the Order is sent to the Secretary of State for the Department of Environment, Food and Rural Affairs for confirmation any representations and objections which have not been withdrawn will be sent with the Order.

**Dated this 3rd day of September 2020**



**Liam Henry**  
**Legal Services Manager**  
**Northumberland County Council**  
**County Hall**  
**Morpeth, NE61 2EF**

# **STATEMENT TO ACCOMPANY THE PUBLIC PATH ORDERS FOR PUBLIC FOOTPATH No 16**

**(Parish of Middleton)**

Northumberland County Council has made these path creation and extinguishment orders to 'divert' this public right of way onto the alignment that is actually walked. A diversion order was considered inappropriate, because the existing and proposed end points are not the same (and not connected by another public right of way).

The County Council is satisfied that the proposed alternative route of the footpath is more convenient for the public, will not lead to a loss of amenity, and that enjoyment of this route and the local network of paths, by the general public, will not therefore be reduced.

The alternative route of the public footpath and the length of footpath being closed are shown on the map which accompanies this statement.

If there is anything relating to the making of the order that you wish to discuss in further detail, you can do so by contacting:  
Philip Bradley, Area Countryside Officer, Northumberland County Council,  
County Hall, Morpeth, NE61 2EF.  
Telephone: 01670 623022  
E-mail: [philip.bradley@northumberland.gov.uk](mailto:philip.bradley@northumberland.gov.uk)

The order will only come into effect after it has been confirmed and further notices will be advertised to indicate when this has taken place. At this stage the making and advertising of the order provides an opportunity for objections and representations to be made by anyone wishing to do so.

Objections or representations should be made in writing to the Legal Services Manager, Northumberland County Council, County Hall, Morpeth, NE61 2EF no later than 15<sup>th</sup> October 2020.

**This statement does not form part of the legal order.**

## **Public Path Creation Order**

### **Highways Act 1980**

#### **Northumberland County Council**

##### **Parish of Middleton (Public Footpath No 16) Creation Order 2020**

This Order is made by Northumberland County Council ("the Authority"), under Section 26 of the Highways Act 1980 ("the 1980 Act"), because it appears to the Authority that, having regard to the matters set out in section 26(1), there is a need for a public footpath over the land to which this order relates, and that it is expedient that the path should be created.

Belford Parish Council has been consulted as required by Section 120(2) of the 1980 Act.

#### **BY THIS ORDER:**

1. There shall at the end of 63 days from the date of confirmation of this Order be a public footpath over the land situated at Ross Sands, and described in Part 1 of the Schedule to this order and shown by a bold dotted line on the map contained in this order.
2. The rights conferred on the public under this Order shall be subject to the limitations and conditions set out in Part 2 of the Schedule.

## **Schedule**

### **Part 1**

#### **Public Footpath No 16 (Parish of Middleton)**

A 1.5 metre wide footpath, from a point marked A, 680 metres north-east of Coastguard Lodge, at Ross, in a south-easterly direction for a distance of 40 metres, then in an easterly direction for a distance of 160 metres, then in a north-easterly direction for a distance of 255 metres to a point marked C, 1100 metres north-east of Coastguard Lodge.

### **Part 2**

#### **Limitations and Conditions**

1 pedestrian gate to comply with Northumberland County Council Gaps, gates and stiles – Specification (January 2009)), situated at grid reference NU 1452 3754.

**THE COMMON SEAL OF NORTHUMBERLAND COUNTY COUNCIL** was hereunto  
affixed this *14<sup>th</sup>* day of *August* 2020 in the  
presence of:-

**Duly Authorised Officer**



*22158*

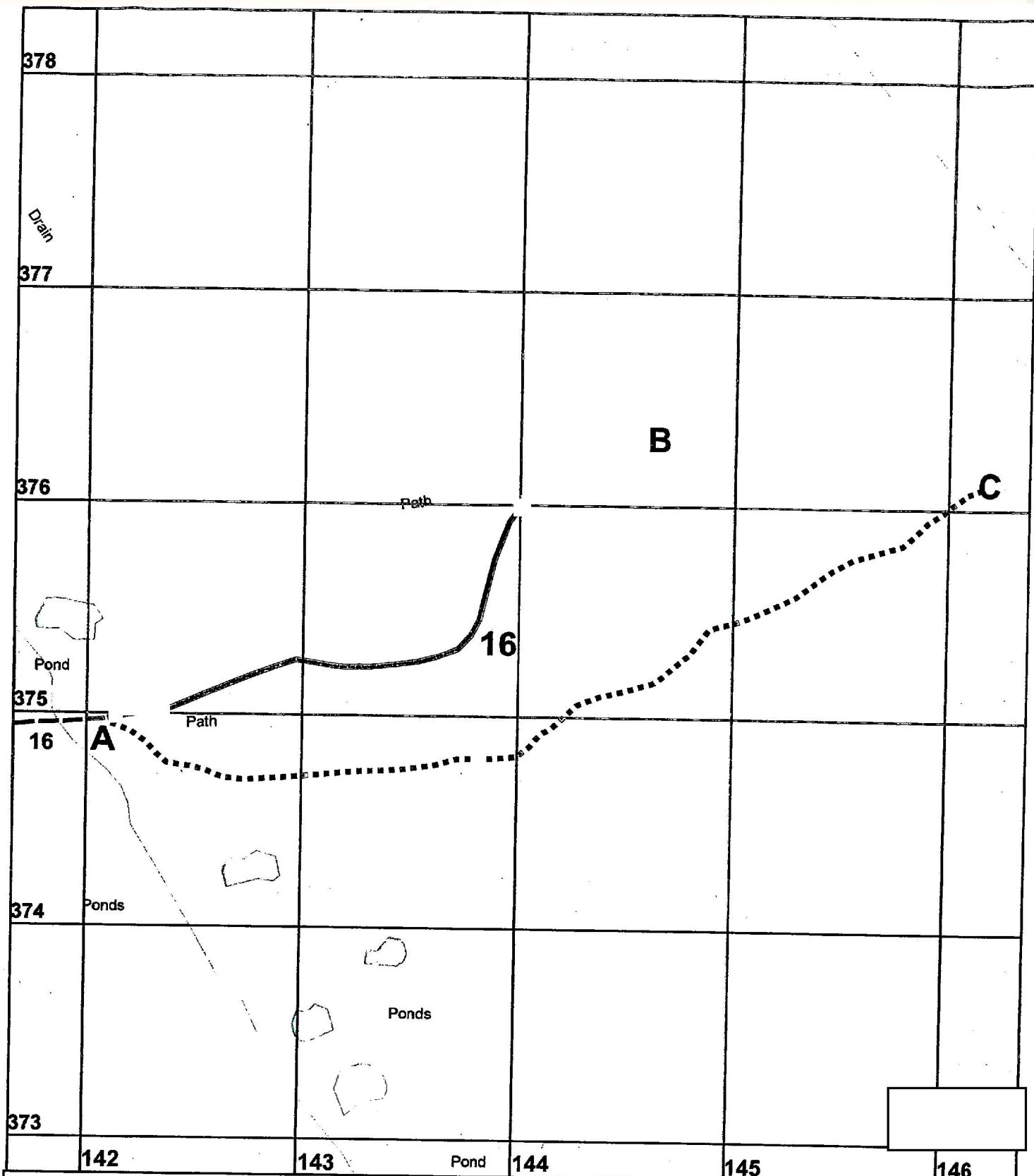

 <b>Northumberland</b> County Council Infrastructure Local Services Group County Hall Morpeth Northumberland Telephone 0845 600 6400 NE61 2EF	<b>Public Rights of Way</b> - - - - - Existing Public Footpath _____ Public Footpath to be closed . . . . . Public Footpath to be created		
This map is reproduced from Ordnance Survey material with the permission of Ordnance Survey on behalf of the Controller of H.M.S.O. © Crown Copyright. Unauthorised reproduction infringes Crown Copyright and may lead to prosecution or civil proceedings. Northumberland County Council O.S. Licence No.100049048 (2012)	Former District(s) <b>Berwick</b>	Parish(es) <b>Middleton</b>	Scale <b>1:2500</b>
Def. Map No. <b>23</b>	O.S. Map <b>NU 13 NW</b>	Date <b>January 2020</b>	

**NORTHUMBERLAND COUNTY COUNCIL** in exercise of their powers under section 26 of the 1980 Act, hereby confirm the foregoing Order:

**Parish of Middleton (Public Footpath No 16) Creation Order 2020**

**In witness** thereof, the Common Seal of Northumberland County Council was hereunto affixed this day the \_\_\_\_\_ of \_\_\_\_\_ 20\_\_\_\_ in the presence of:-

**Duly Authorised Officer**