

NORTHUMBERLAND COUNTY COUNCIL

TRAFFIC REGULATION ORDER

(Ref: TRO\_004\_25)

---

Northumberland County Council

NCC North Northumberland (Central) Area (Parking Places)

Composite Order 2011

Amendment No 25 Order 2019

Made: 20<sup>th</sup> February 2019

Coming into Force: 4<sup>th</sup> March 2019

---

Northumberland County Council (hereinafter referred to as "the Council") in exercise of their powers under Sections 1, 2, 4, 32, 35, 45, 46 and Paragraphs 20, 27 and Part IV of Schedule 9 of the Road Traffic Regulation Act 1984 ("the Act of 1984"), and after consulting with the Chief Officer of Police in accordance with Part III of Schedule 9 to the Act of 1984 and of all other enabling powers hereby make the following Order:-

**1. Commencement and Citation**

This Order shall come into operation on the 4<sup>th</sup> March 2019 and may be cited as "Northumberland County Council North Northumberland (Central) Area (Parking Places) Composite Order 2011 - Amendment No 25 Order 2019".

**2. In the Order:-**

"Order" means "Northumberland County Council North Northumberland (Central) Area (Parking Places) Composite Order 2011".

"Amendment Order" means "Northumberland County Council North Northumberland (Central) Area (Parking Places) Composite Order 2011- Amendment No 25 Order 2019".

The Interpretation Act 1978 shall apply to this Order as it applies to an Act of Parliament.

### 3. Provisions

The following provisions set out below and in The Schedule to this Amendment Order shall be additions to, deletions from, or substitutions in the restrictions in the Order:

#### (A) Additions

to Schedule 1 - Residents Permit Holders Parking Places

(Referenced in this Amendment Order as: The Schedule - ADDITIONS)

#### (B) Deletions

None

#### (C) Substitutions

None

---

GIVEN under the Common Seal of the County Council of Northumberland this 20<sup>th</sup> day of February 2019.

**THE COMMON SEAL OF THE COUNTY COUNCIL OF NORTHUMBERLAND** was hereunto affixed in the presence of:-

  
Duly Authorised Officer



Seal no.  
20342

## THE SCHEDULE

### ADDITIONS – Northumberland County Council North Northumberland (Central) Area (Parking Places) Composite Order 2011 - Amendment No 25 Order 2019 - TRO\_004\_25

#### Schedule 1 - Residents Permit Holders Parking Places

Ref No	Town	Street	Side	Description	Permitted Hours
004_25_000_6935	ALNWICK	U3148 MONKHOUSE TERRACE TO GARAGE AREA	Both	At its junction with Tower Lane to a point 50 metres west of its junction with Tower Lane	1



**ROAD TRAFFIC REGULATION ACT 1984  
THE COUNTY OF NORTHUMBERLAND**

**NORTH NORTHUMBERLAND (CENTRAL) AREA (PARKING PLACES)  
COMPOSITE ORDER 2011 AMENDMENT NO 25 ORDER 2019**

**STATEMENT OF THE COUNCIL'S REASONS FOR  
MAKING THE ORDER**

The proposals has been considered necessary to improve parking in the area for residents





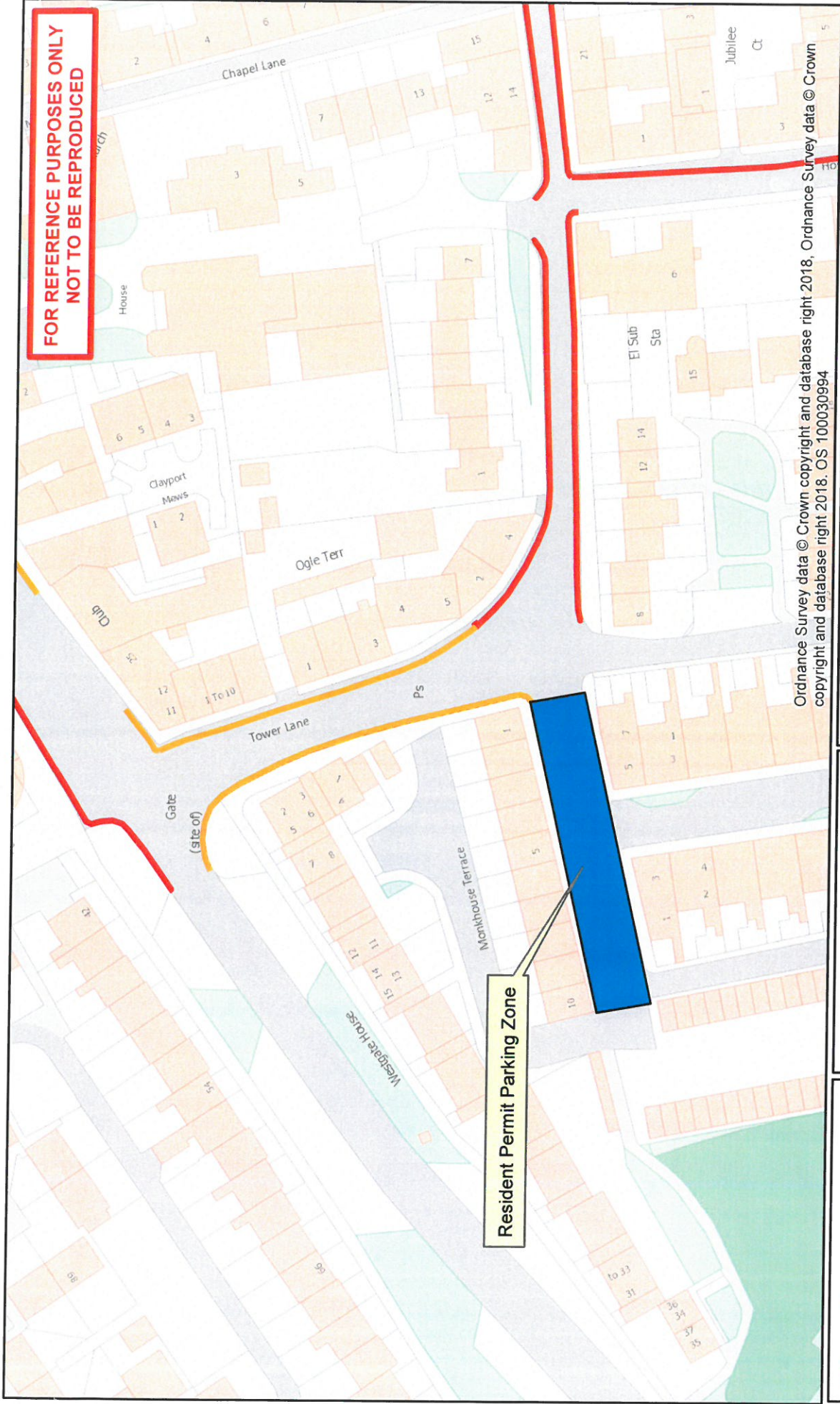

<b>Northumberland</b> Northumberland County Council		<b>Network Management Information System</b>		<b>Title:</b> <b>Monkhouse Terrace, Alnwick</b> <b>Resident Permit Parking Zone</b>	
Northumberland County Council County Hall Worpleth Northumberland NE61 2EF Tel: 01670 533000		This map is reproduced from Ordnance Survey material with the permission of Ordnance Survey on behalf of the Controller of Her Majesty's Stationary Office Crown Copyright. Unauthorised reproduction infringes Crown Copyright and may lead to prosecution or civil proceedings. License no. 100049048 (2009).		<b>Dm:</b>	<b>Date:</b>
				<b>Scale:</b> 1:1000	

