

NORTHUMBERLAND COUNTY COUNCIL

TRAFFIC REGULATION ORDER

(Ref: TROM\_038)

---

Northumberland County Council

Welfare Crescent Newbiggin by the Sea (One Way Traffic Restriction) Order 2017

Made: 24<sup>th</sup> January 2017

Coming into Force: 6<sup>th</sup> February 2017

---

Northumberland County Council (hereinafter referred to as "the Council") in exercise of their powers under Sections 1(1), 2(1) and 2 and Part III of Schedule 9 of the Road Traffic Regulation Act 1984 ("the Act of 1984"), and after consulting with the Chief Officer of Police in accordance with Part III of Schedule 9 to the Act of 1984 and of all other enabling powers hereby make the following Order:-

**1. Commencement and Citation**

This Order shall come into operation on the 6<sup>th</sup> February 2017 and may be cited as "Northumberland County Council Welfare Crescent Newbiggin by the Sea (One Way Traffic Restriction) Order 2017".

**2. In the Order:-**

"Order" means "Northumberland County Council Welfare Crescent Newbiggin by the Sea (One Way Traffic Restriction) Order 2017".

"Specified" means specified in the Schedule to this Order

The Interpretation Act 1978 shall apply to this Order as it applies to an Act of Parliament.

**3. Provisions**

No person shall cause or permit a vehicle to proceed in any specified road or in any specified length of road in a direction other than that specified in relation to that road or length of road as shown in the Schedule attached to this Order.

GIVEN under the Common Seal of the County Council of Northumberland this 24<sup>th</sup>  
day of January 2017.

THE COMMON SEAL OF THE COUNTY COUNCIL OF NORTHUMBERLAND was  
hereunto affixed in the presence of:-

*D J Harrison*

Duly Authorised Officer

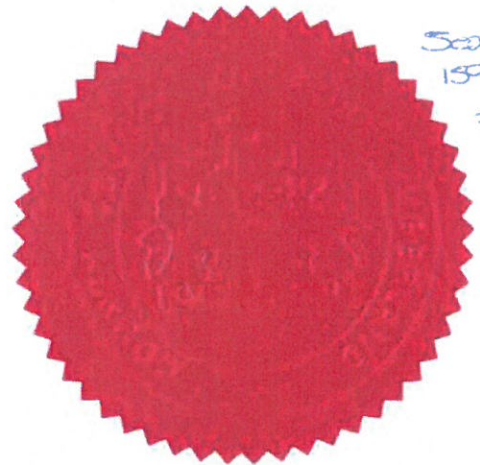

Seal no  
15987  
=

## **THE SCHEDULE**

**Northumberland County Council  
Welfare Crescent Newbiggin by the Sea  
(One Way Traffic Restriction) Order 2017  
(TROM\_038)**

Town	Street	Description	Grid Reference	Direction
NEWBIGGIN BY THE SEA	WELFARE CRESCENT	From adjacent to No 76 Welfare Crescent to adjacent to No 20 Welfare Crescent	430537 587732 To 430414 587740	South then North

**ROAD TRAFFIC REGULATION ACT 1984  
THE COUNTY OF NORTHUMBERLAND**

**NORTHUMBERLAND COUNTY COUNCIL  
WELFARE CRESCENT NEWBIGGIN BY THE SEA  
(ONE WAY TRAFFIC RESTRICTION) ORDER 2017  
(TROM\_038)**

**STATEMENT OF THE COUNCIL'S REASONS FOR  
MAKING THE ORDER**

The proposal has been considered necessary and is for the introduction of a one way traffic restriction on Welfare Crescent Newbiggin by the Sea. This has been proposed by Local Councillor Jim Lang and has the overall support of local residents. The aim is to assist with the flow of traffic in the area and allow safer parking on the highway.



FOR REFERENCE PURPOSES ONLY  
NOT TO BE REPRODUCED

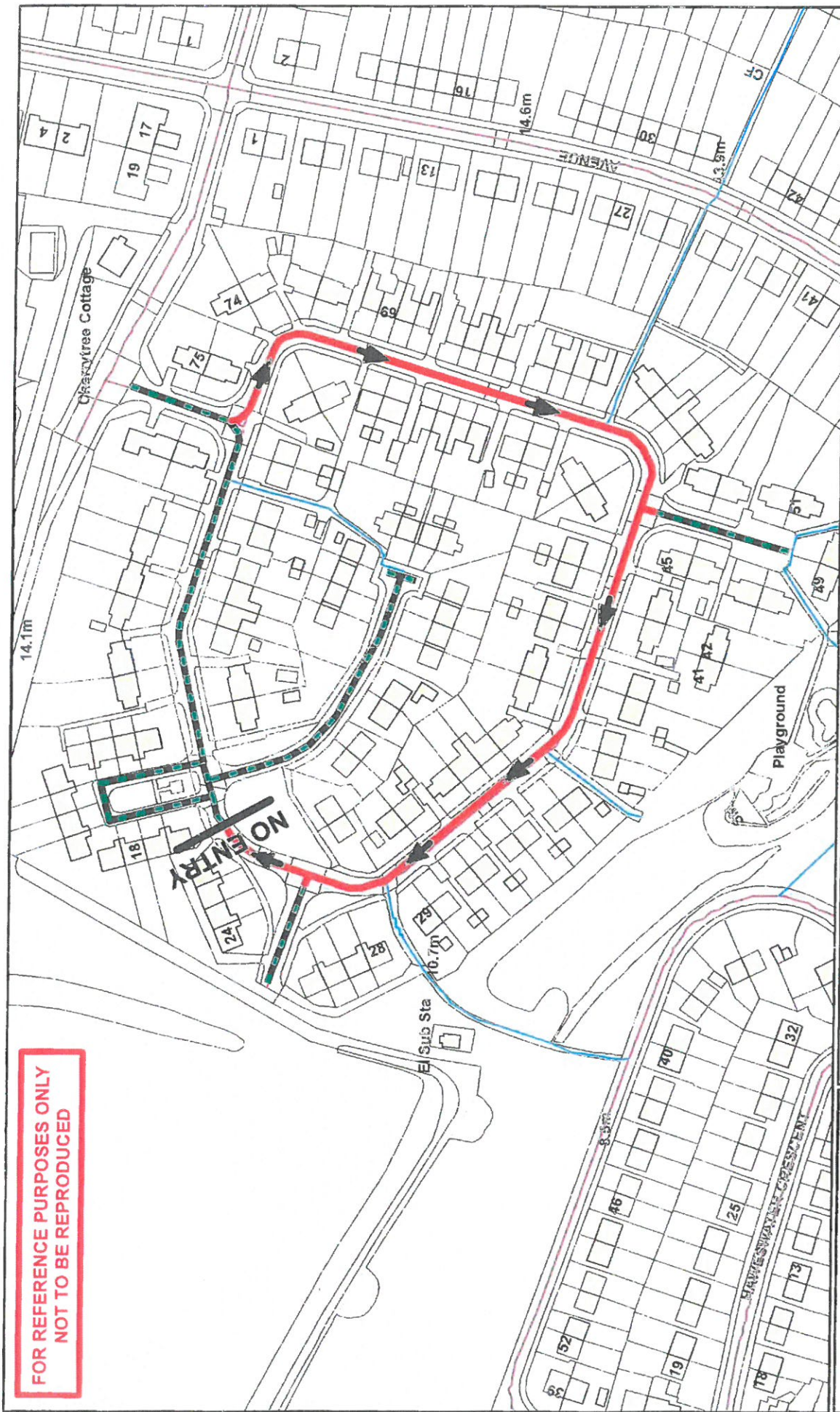

<p><b>Northumberland</b> Northumberland County Council</p> <p>Northumberland County Council County Hall Morpeth Northumberland NE61 2EF Tel: 01670 533000</p>	<p><b>Network Management Information System</b></p> <p><small>This map is reproduced from Ordnance Survey material with the permission of Ordnance Survey on behalf of the Controller of Her Majesty's Stationery Office. Crown Copyright. Unauthorised reproduction infringes Crown Copyright and may lead to prosecution or civil proceedings. License no. 100049046 (2009).</small></p>	<p><b>Title:</b> Proposed One Way System Welfare Crescent, Newbiggin</p> <table border="1"> <tr> <td><b>Dm:</b> AW</td><td><b>Date:</b> May 16</td><td><b>Scale:</b> NTS</td></tr> </table>	<b>Dm:</b> AW	<b>Date:</b> May 16	<b>Scale:</b> NTS
<b>Dm:</b> AW	<b>Date:</b> May 16	<b>Scale:</b> NTS			

— ONE WAY ONLY

— TWO WAY TRAFFIC