



Northumberland

County Council

RECORD OF DECISION TAKEN BY SERVICE DIRECTOR - LOCAL SERVICES

Paul Jones

Speed Limit Reduction Measures - B1337 Longhirst

Cabinet Member: Glen Sanderson - Environment & Local Services

Purpose of Report

This report sets out the background to the proposed graduated 40 MPH and 30 MPH speed limit along the B1337 at Longhirst.

Recommendations

It is recommended that the existing derestricted speed limit is reduced to 40 MPH and then 30 MPH in graduated fashion when approaching Longhirst from either direction of travel, thereby also amending the existing 30 MPH speed limit that operates through Longhirst.

Link to Corporate Plan

Living - "We want you to feel safe, healthy and cared for"

Enjoying - "We want you to love where you live"

Learning - "We want you to achieve and realise your potential"

Key Issues

1. The proposal has been developed following concerns raised by residents in the area, the elected member and the Parish Council.
2. The area under consideration lies within the built-up extents of Longhirst and approaches to this section of the B1337 road.
3. The scheme is supported by Councillor Towns and Longhirst Parish Council.
4. The scheme will be funded from the 2019/20 LTP programme.

Background

Longhirst is located on the B1337, which is a mainly unlit single carriageway running in a north/south direction through the vicinity. It is joined at priority junctions by the C126 to the east and C127 to the south-east. There are private accesses to several residential dwellings and to Longhirst Hall, which is popular for sports activities such as golf and tennis.

The speed limit is derestricted at the approach at the north of the B1337 into Longhirst from the direction of Ulgham until reaching a priority chicane and associated 30 MPH speed limit terminal signs. Beyond this point the road continues for a short distance and bends south-west before entering the residential area of Longhirst and then the access to Longhirst Hall. The existing 30 MPH route on this section of the B1337 is highlighted in Figure 1 below.

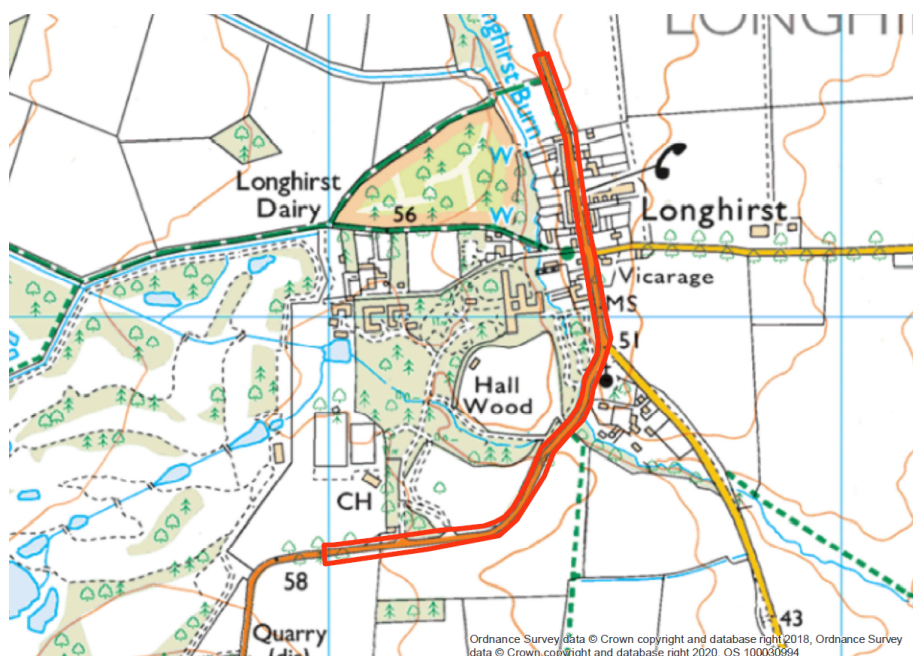

Fig 1: Existing 30 MPH route on the B1337 through Longhirst marked in red

Beyond this 30 MPH area to the south west the road meanders with 90 degree bends and is derestricted with a narrow footway provided on one side only. Traffic signing and road markings limited to centre lines, intermittent 'slow' markings, chevron markings at the sharp bend with residential properties situated there and a 'Longhirst' nameplate sign.

Proposals

Graduated/Transitioned 40 MPH & 30 MPH Speed Limit

A transitioned speed limit approach is proposed in this instance which is acceptable for use in rural locations on approaches to or on the outskirts of areas such as Longhirst. When approaching northbound from the northern

Delegated Decision

arm of Whorral Bank Roundabout and just before the access to Longhirst Hall, the speed limit will be reduced from National Speed Limit to 40 MPH and then to 30 MPH throughout the residential part of Longhirst. This is outlined by the plan in Figure 2.

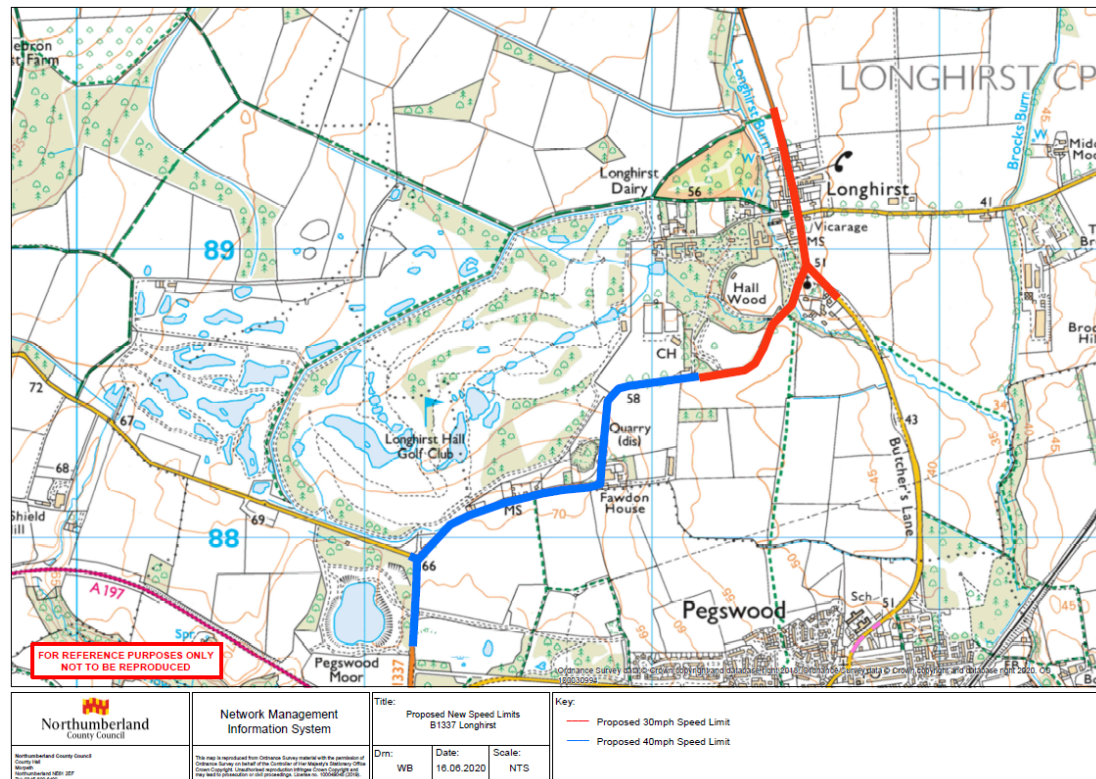

Fig 2: Proposed new speed limits at Longhirst

New traffic calming features will incorporate new speed limit signs and 'Welcome to Longhirst, Please Drive Carefully' text, with speed limit roundels on the ground to act as a gateway features to the village. 'Slow' road marking text will also be installed throughout the scheme with warning signs to inform motorists of junctions and sharp bends.

It is expected that the speed limit reduction measures will promote slower traffic speeds in Longhirst where the presence of pedestrians is more prominent and where vehicle turning manoeuvres are taking place to gain access and egress to/from residential properties and at Longhirst Hall.

Details of the proposals are shown on the plan at Appendix A.

Council Officers have worked closely with the elected County Councillor and Longhirst Town Council on the scheme.

Northumbria Police, other emergency services and relevant statutory consultees will be notified of these amendments as part of the process for making the permanent Orders.

Delegated Decision

Implications Arising out of the Report

Policy	Consistent with existing policies
Finance and value for money	Scheme will be financed from LTP 2019/20
Legal	Traffic Regulation Orders (reference TROM_183)
Procurement	Signage and road markings to meet Regulations for Traffic Regulation Orders
Human Resources	None
Property	None
Equalities (Impact Assessment attached) Yes <input type="checkbox"/> No <input type="checkbox"/> N/A <input type="checkbox"/>	N/A
Risk Assessment	None
Crime & Disorder	Regulations in place to carry out enforcement.
Customer Consideration	A reduction in speed will lead to a safer environment for all road users.
Carbon reduction	Speed reduction assists with carbon reduction
Wards	Pegswood

Delegated Decision

Background Papers:

File reference –

S:\Highways\PROJECT\19\HF Local Safety Schemes\Rural Roads\HFD19546 - Longhirst Village

Appendix A –

HFC19546/10/B1337/1/02 - Signing Road Marking & Amended Speed Limits

HFC19546/10/B1337/1/03 - Signing Road Marking & Amended Speed Limits

HFC19546/10/B1337/1/04 - Signing Road Marking & Amended Speed Limits

Author and Contact Details

Report Author **William Binks, Consultant Engineer**

DECISION TAKEN

Title of Officer: Service Director, Local Services

Subject: Proposed 40 MPH speed limits and amendments to existing 30 MPH restrictions along the B1337 at Longhirst.

Consultation: Not required for introduction of a 40 MPH or a 30 MPH Speed Limit Restriction within the vicinity of Longhirst - proposal supported by Local County Councillor and it has been notified to Northumbria Police.

Decision Taken: To introduce a graduated speed limit (40 MPH and 30 MPH) along the B1337 in advance of and within Longhirst.

Signature of Director



Date

6th July 2020

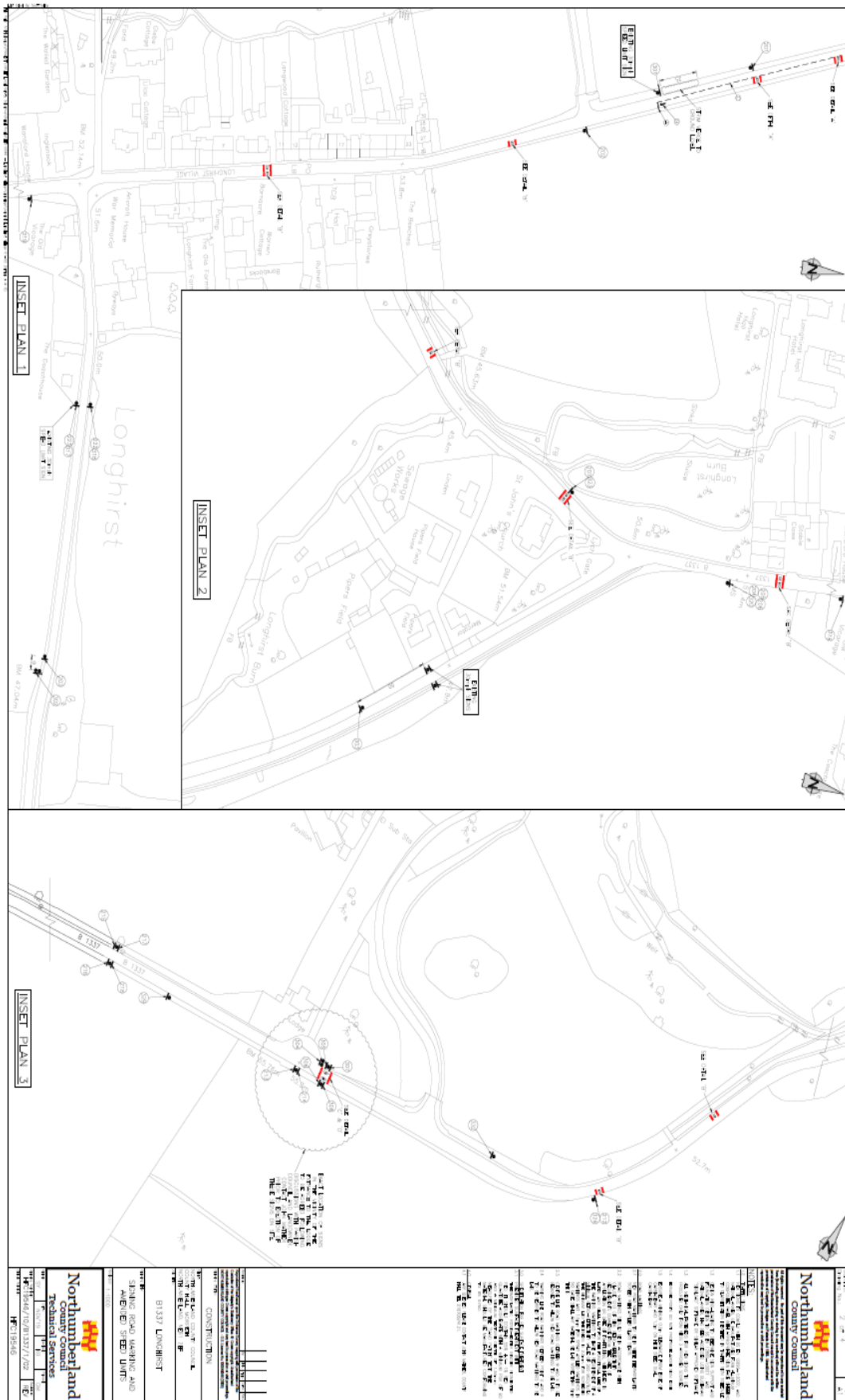

Delegated Decision

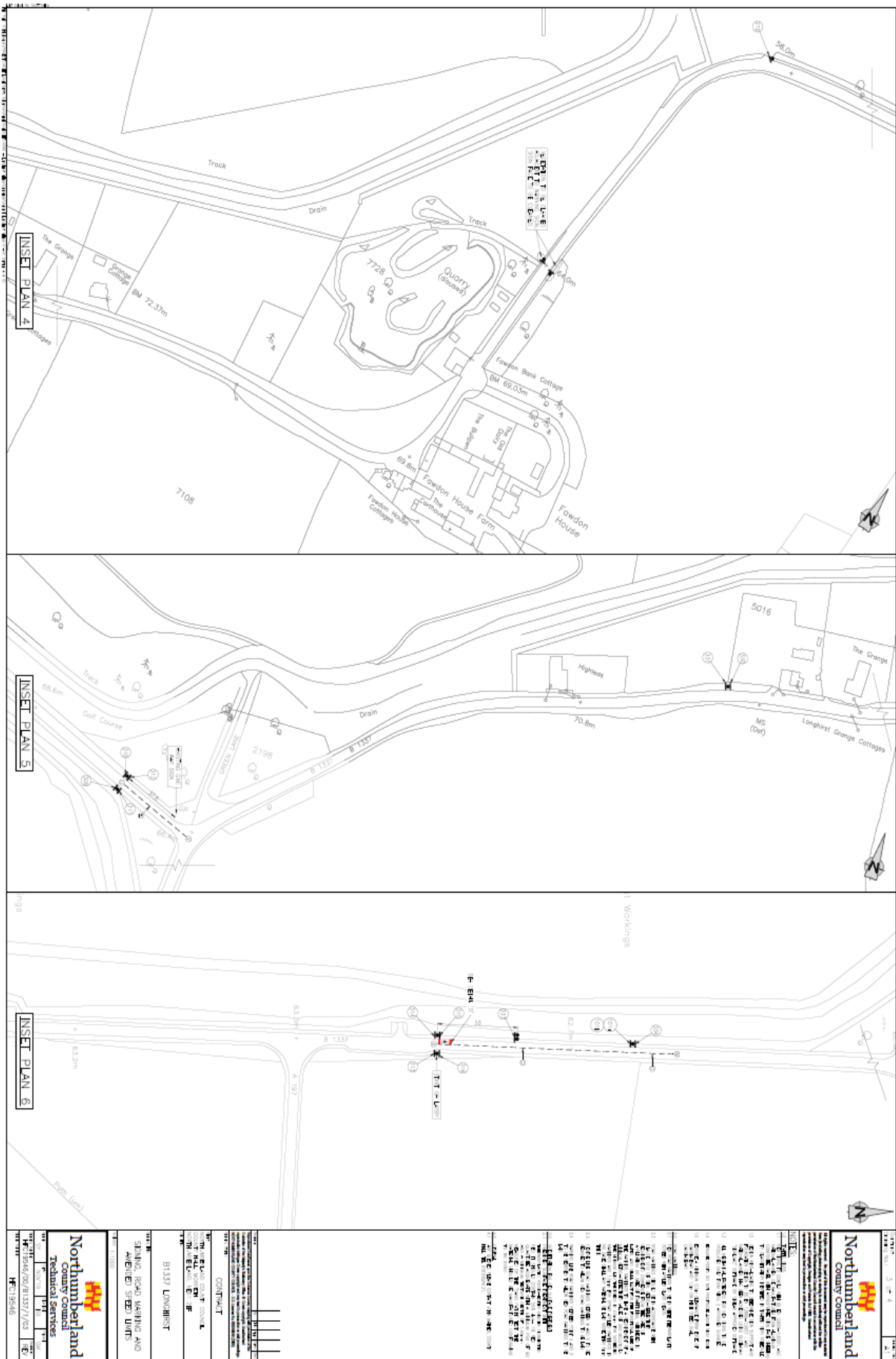

[illegible][illegible][illegible]

Northumberland County Council

NOTES

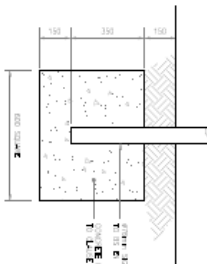
[illegible][illegible][illegible][illegible]

DETAIL
TYPICAL SIGN POST FOUNDATION
SECTION 1-11D

